

Greenfield

M O W E R S

MINI MOW 25

Made in
AUSTRALIA
Since 1966



BRIDGES & STRATTON

INSTRUCTIONS

AND SPARE PARTS

Greenfield Mowers Pty Ltd
172 Ingram Road, Acacia Ridge, Qld. 4110
P.O. Box 155 Archerfield, Qld. 4108
Phone (07) 33456100 / Fax (07) 33441161

Web site: www.greenfield.com.au / Email: greenfield@gil.com.au

Contents

Safety Instructions	2
Mowing on Slopes	4
Controls and Equipment	5
Operating Instructions	6
Cutting Blades and V Belts	7
Cutter Deck Adjustments	7
Cutter Belt Adjustments	8
Cutter Belt Removal and Replacement	9
Drive Belt Removal and Replacement	10
Maintenance	
General	11
Drive Chain Adjustment	12
Cleaning and Chassis Lubrication	12
Electrical Circuits	13
Spare Parts	
Linkages – Drive Clutch and Cutter Clutch	14
Linkages – Cutter Height, Brake and Belt Tensioner	15
Engine and Components	16
Drive Clutch and Rear Axle	17
Steering and Front Axle	18
Cutter Deck	19
Body Works and Seat	20
Guarantee	21
Service Record and Notes	22



***Use only Genuine Greenfield Replacement Parts.
Refuse Substitutes***



Greenfield Mower Pty. Ltd.

All details are correct at the time of printing but are subject to change without notice
GT230610903

Greenfield



Thank you for buying an Australian made **Greenfield** ride-on mower. Follow the manufacturers operating and maintenance instructions and many years of excellent trouble free service can be expected.

Before operating the mower **read the owners manual carefully**. Do not allow children or any person unfamiliar with the safe operating procedure to operate this mower. Your Greenfield mower has been designed to meet stringent safety standards – but we remind you that a mower is a cutting device – **used incorrectly it could cause serious personal injury or death**. **Remove the key when the mower is not in use.**

Safety Instructions

1. Do not carry passengers.
2. Know your controls. Read the operating instructions carefully. Learn how to stop the mower and the engine quickly in an emergency.
3. Do not mow whilst people, especially children or pets are in the mowing area. Children should be kept elsewhere and supervised. Never assume that children will remain where you last saw them. Do not reverse before looking behind.
4. Make sure the area to be mown is clear of sticks, stones, bottles, bones, wire and other debris, which could be thrown by the blades.
5. Do not operate the mower without first inspecting the blades, blade bolts and blade holder for wear or damage. **Damaged blades and worn bolts are major hazards**. Always replace blades and blade bolts in sets to preserve balance. Replace worn or damaged parts with **genuine Greenfield** replacement parts only. N.B. Use of inferior non-genuine service parts on your Greenfield mower could result in costly damage and even personal injury. Refer "Maintenance Instructions", for replacement part numbers and fitting instructions.
6. Before using the mower check that all guards, safety switches, deflector or grass catcher provided by the manufacturer are operating properly and fitted securely. Regularly check all the components on the mower to ensure the machine is in a safe operating condition.
7. Never mow while barefoot or wearing open sandals or thongs. Wear long trousers and heavy shoes. It is also important to wear suitable eye protection.
8. A mower operator should be in good physical and mental health and not under the influence of any drug or alcohol which might impair vision, co-ordination or judgements.
9. Replace worn or faulty exhaust mufflers.
10. Do not allow grass, garden debris or grease to build up on the mower, particularly around the engine. These could be a fire hazard.
11. Petrol is a highly inflammable fuel. If ignited it could cause destruction of property, serious personal injury or death. Refuel outdoors only over a non-flammable surface. Do not smoke while refuelling engine or fuel near a source of ignition such as electrical switches or a gas hot water heater. Never remove the cap of the fuel tank or add petrol while the engine is running or if the engine is hot, allow it to cool for several minutes. Remove fuel cap slowly to relieve any tank pressure. Do not fill past the maximum level marked on the fuel tank. If petrol is spilled do not attempt to start the engine but move the machine away from the area of the spill and avoid creating any source of ignition until any build up of grass clippings and garden debris is removed from the machine, all trace of the spill is removed and all petrol vapours have dissipated.
12. Use only an approved container for storing fuel. Never store the fuel container or the fuelled machine in an unventilated area or near a source of ignition such as electrical switches or a gas hot water heater
13. Don't operate the engine in a confined space where poisonous exhaust fumes, carbon monoxide can collect.

14. Always disengage the cutting blades from the operation seat before starting or stopping the engine.
15. Always mount or dismount the mower from the opposite side to the discharge chute.
Always stop the engine before dismounting. Keep feet and hands clear of the cutter deck.
16. Reduce speed particularly when making sharp turns to prevent overturning or loss of control. Do not stop or start suddenly when mowing up hill or downhill.
17. Never mow up hill or down hill on slopes which exceed 10 degrees, or mow across the face of a slope which exceeds 5 degrees.

BEFORE attempting to mow on any slope, refer to "Mowing on Slopes" in this Owners Manual.
18. Stay alert for holes in the terrain and other hidden hazards.
19. Before crossing paths, driveways or any other area foreign to mowers, reduce engine speed, disengage cutting blades and lift cutting attachment to maximum height. Do not drive over obstacles or gutters, this machine has a maximum 3 1/2" (9cm) clearance.
20. Watch out for traffic when crossing or operating the mower near roadways. **Always mow with the safety grass deflector properly fitted.**
21. When mowing, never direct discharge of material toward bystanders nor allow anyone near the machine while in operation.
22. Before leaving the operators position:
 - (a) Disengage the cutting blades
 - (b) Apply the parking brake
 - (c) Stop the engine and remove the starter key
23. Disengage the drive to the cutting blades and stop the engine:
 - (a) Before refuelling
 - (b) Before removing grass catcher or any attachment
 - (c) Before making a height adjustment unless adjustment is being made from the operators position
 - (d) Before clearing blockages
 - (e) Before inspecting, cleaning or working on the mower
 - (f) After striking a foreign object (inspect the mower for damage and make necessary repairs before restarting and operating the machine)
 - (g) If the machine starts to vibrate abnormally (check immediately)
24. Disengage drive to the cutting blades when not in use or transporting
25. Do not over-speed the engine or alter governor settings. Excessive speed is dangerous and shortens the mowers life.
26. Use care when towing or using attachments.
 - (a) Use only the approved towbar hitch point.
 - (b) Limit loads to those you can safely control.
Recommended gross towing capacity is 60kg. This includes the weight of the trailer.
A Greenfield tip trailer weighs 35kg. empty.
 - (c) Do not turn sharply.
 - (d) Use care when reversing.
 - (e) Be aware of people and pets.
 - (f) Do not carry passengers.
27. Replace any unreadable warning or safety decals.
28. Do not lend or sell the mower without the owners manual.
29. **Warning** – Remove spark plug lead to avoid accidental starting before attempting any maintenance or inspection of the mower.

MOWING ON SLOPES

Exercise extreme caution when operating a ride-on mower on a slope. Slopes are a major cause of tip-over and loss of control accidents involving ride-on mowers. Severe injury or death can occur.

On any slope the differential action must be locked out for best traction.

Speed should be reduced on slopes, particularly when changing direction.

Do not stop or start on slopes unless entirely necessary or make sudden speed or directional changes.

Never operate a ride-on mower on any slope if it is wet.

A ride-on mower should only be operated up and down slopes, not across.

Before operating on a slope remove all loose matter, branches, rocks etc. and stay clear of holes, erosion and tree roots etc. Such hazards can cause unexpected and instantaneous stability changes.

If a totally safe mowing procedure cannot be planned before entering a sloping area, then an alternative method of cutting this area, which does not risk the safety of the operator, should be used.

NEVER tow or use any optional attachment on ANY slope.

Don't mow close to steep drop offs.

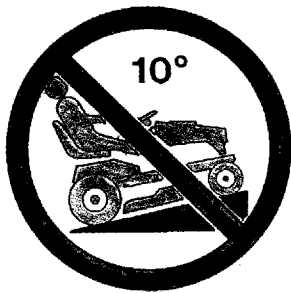

Never mow up hill or down hill
on slopes which exceed 10 degrees.



Never mow across the face of a
slope which exceeds 5 degrees.

If the operator of a ride-on mower is not absolutely certain a slope does not exceed the previous recommendations, the area should not be entered until such time a properly qualified person has assessed and reported on the safety of the area.

SAFE OPERATING HINT

Before driving down a slope, use the throttle control to select slow engine revs then keep the foot pedal engaged in the "forward" drive position while driving down the slope. This will limit the forward speed of the mower to the preselected engine speed. To further adjust the ground speed to suit the conditions use the throttle control to raise or lower the engine revs while still retaining the necessary toe pressure on the foot pedal to keep forward drive engaged. This practise eliminates the unnecessary wear and tear to clutches, transmission and tyres caused when reverse is used to slow the forward progress of the mower on slopes. This practise also ensures the operator retains better control of the machine as engaging reverse in certain circumstances such as on wet grass could cause the wheels to skid which could result in loss of control. Reverse or heel pressure will be needed to stop the mower.

IMPORTANT: Never drive a ride-on mower up or down a slope exceeding 10° or across a slope exceeding 5°.

CONTROLS & EQUIPMENT

Cutting Height

The height adjustment lever located on the left side of the engine compartment enables the operator to select the desired cutting height. To alter the cutting height, move the lever away to the left then forward or backward to select the cutting height then release to lock in position. Use the mid range height settings in the green band, for maximum belt life.

Blade Clutch

The clutch lever to engage the cutting blades is located on the right side of the chassis below the operators right leg. To engage the cutting blades, slowly lift the cutter clutch lever up and swing it over towards the rear of the machine until it reaches the stop (cutters in). This cutters engage operation is best achieved with high engine revs. To disengage the cutting blades swing the lever forward until it comes to a stop (cutters out).

NEVER USE THE MOWER WITHOUT THE SAFETY DEFLECTOR OR GRASS CATCHER FITTED.

DANGER: Never attempt to dismount from the driver's seat while engine is running.

Seat

The operator's seat is adjustable front to rear. To adjust, loosen the four seat securing nuts, slide the seat to the position required and retighten nuts. If further adjustment is required the seat securing nuts and washers must be removed and the wire for the seat safety switch disconnected. The seat can now be removed from the mower. The seat can be refitted further forward or rearward on the seat base being careful to replace the seat mounting rubbers the correct way as the proper operation of these seat mounts is necessary for the seat safety switch to operate correctly. See illustration this page. When replacing the seat assembly on the mower, reconnect the wire for the safety switch before replacing the securing nuts.

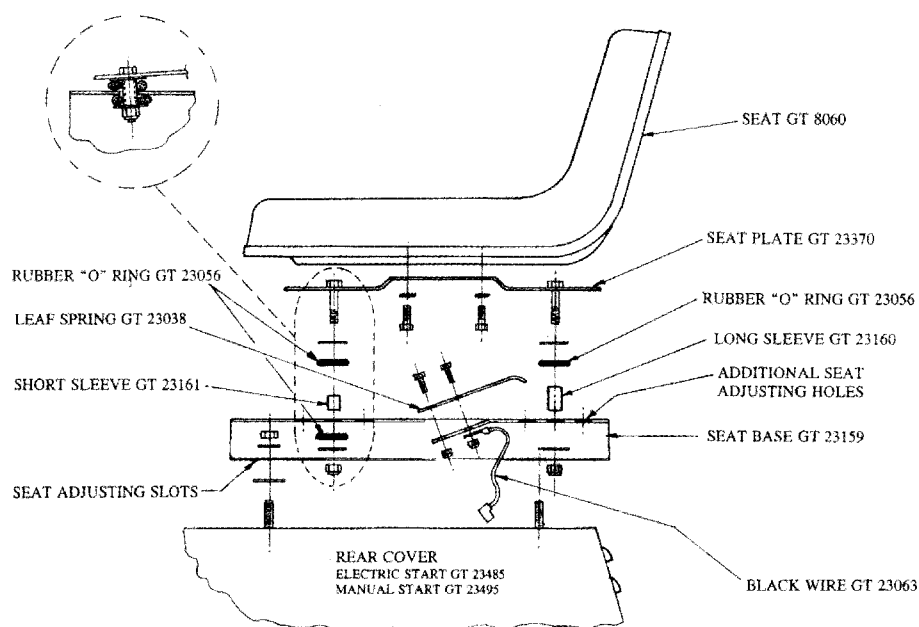

SEAT FIXING DETAIL

Park/Emergency Brake

The park brake handle is located in front of the left side rear mudguard. This handle has two positions, "OFF" and "ON". To engage the park brake, shift the handle back and out of the control latch. Allow the handle to travel forward and the park brake to engage. The mower may need to travel 10cm either way to securely engage the mechanism. To disengage the park brake shift the lever rearward and hook the lever into the "L" pattern of the latch. If parked on a slope the mower may need to be moved a little up the slope to release the mechanism. This brake can also be used for stopping the mower in an emergency. **DO NOT ATTEMPT TO DRIVE THE MOWER WITH THE BRAKE IN THE "ON" POSITION.**

Operating Instructions

BEFORE STARTING

Fuel

Top with clean regular **Unleaded** petrol only. Do not fill above the high level mark. Ensure the petrol is free of impurities, particularly water. The petrol tank is located inside the engine compartment of your Greenfield. Raise the bonnet for access. Before removing the filler cap from the fuel tank to refuel the machine, wipe or brush the area clean around the cap to prevent any dirt or debris accidentally falling into the tank as the cap is removed. Do not use stale petrol, add clean fresh fuel only. Refer to "Safety Instructions" regarding fuel safety and fire hazards.

Engine Oil

Check oil level by positioning the mower on level ground. Wipe or brush the area clean around the oil fill/dipstick cap, remove the dipstick and wipe clean. Replace the dipstick screwing correctly into position. Remove again and sight the oil level. Fill to the full mark. Do not overfill. Dipstick must be securely in place when the engine is running. Refer to "CRANKCASE LUBRICATION" in the maintenance section of this manual for oil recommendations.

Tyres

Inflate to 20 to 22 psi (140 to 154kPa) Don't over inflate. Over inflation will permanently change the shape of the tyre, causing possible damage to the tyre and adversely affecting the cutter deck Trim & Tilt.

TO START

To start either electric start or recoil start engines the operator must disengage the blade clutch "CUTTERS OUT" and apply the park brake "ON". The fuel tap must be turned on (if fitted). For cold starting the choke will need to be activated. Move the throttle control lever up and into the "CHOKE" position. If the mower is an ELECTRIC start model, the operator must be seated in the operating position as the mower has a safety cut out switch activated by the seat. Turn the starter key to the "START" position for ten (10) seconds maximum. If the engine does not start it may be flooded. Set the throttle control to the "FAST" position (no choke) then attempt to start again. Make sure the key returns to the "RUN" position after the engine starts or after each attempt to start. The operator must release the hand brake "OFF" to travel.

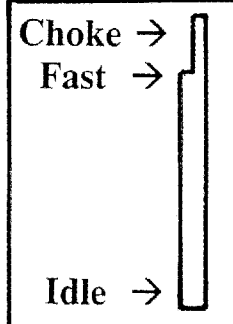

To start a RECOIL / MANUAL start model or to recoil start an electric model, the park brake must be applied "ON" or the engine will not start. Turn the key to the "RUN" position. For cold starts shift the throttle control up and into the "CHOKE" position. Grasp the rope handle and pull slowly until resistance is felt then pull the cord rapidly to start engine. Repeat if necessary with the throttle control in the "FAST" position. When a RECOIL /MANUAL model starts the operator must then be seated before releasing the hand brake "OFF" as the engine will stop without the operator in the seat. Both ELECTRIC and RECOIL models are fitted with a safety "CUT OUT" switch activated by the seat. Once the mowers have started the operator must remain in the seat or the engine will stop.

Do not allow children or any person unfamiliar with the safe operating procedure to use this mower. Know your controls. Read all these instructions carefully. Learn how to stop the mower and the engine quickly in an emergency.

TO STOP

To stop either the ELECTRIC start model or the RECOIL/MANUAL start model quickly in an emergency --- Turn the ignition key to the stop position.

For normal stopping use the throttle control lever to reduce the engine speed to an idle, disengage the cutting blades in the green band mid height position, "CUTTERS OUT" and apply the park brake "ON", then, turn the key to the "STOP" position. NOTE! Some engine manufacturers require their engines be switched off at high revs. For each engine manufacturers recommended stopping procedure refer to the engine manufacturers booklet supplied with your mower. Allow all parts to come to a complete stop before dismounting from the drivers seat.

TO OPERATE

A simple pivoted foot pedal controls forward, neutral and reverse. Apply toe pressure to move forward, heel pressure to move in reverse, increased toe or heel pressure provides speed variation in forward or reverse respectively. Allow pedal to centralise for neutral. The drive pedal can also be used as a brake by applying toe or heel pressure opposite to the directional movement of the mower. Sudden or violent directional changes and/or wheel spinning must be avoided.

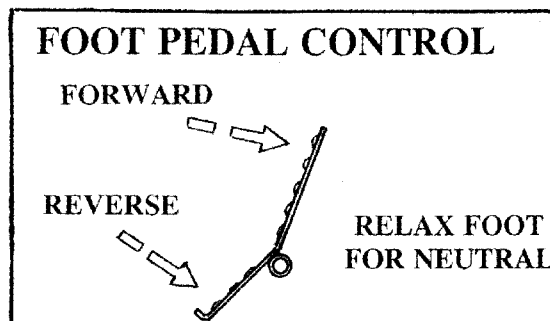

Cutter Belt Adjustment

Warning: Remove the spark plug lead to avoid accidental starting **BEFORE** attempting any maintenance or inspection of the mower.

With the cutter clutch lever in the disengaged "OUT" position the cutter belt should be sufficiently disengaged to allow the cutter blades to come to a complete stop in approximately 7 seconds. The correct amount of belt slack and the efficient operation of the cutter brake control this stopping time. The spring loaded cutter clutch idler pulley maintains the correct belt tension when the blade clutch lever is in the engaged "IN" position.

The self adjusting cutter clutch will automatically adjust to compensate for normal wear and stretch of the V belt. However in a new machine with new belts an early settle in period is not uncommon and the machine should be checked for any belt slip after the first 5 hours of operation and then every 6 months or 25 operating hours after that.

If the automatic tensioning mechanism has reached its maximum travel or the belt tension is inadequate (noticeable by cutters stalling in heavy grass) then an adjustment is required. To do this the left side rear idler pulley must be moved to the next hole rearward in the mounting bracket. This pulley is located inside the front of the left side rear wheel. With a 15mm ring spanner reach under the mower either from the side or the rear to secure the head of the bolt holding this pulley. With a 14mm spanner remove the nut on the outside of the bolt. Keeping the complete pulley and guard unit intact move it to the next hole rearward in the bracket. Slide the bolt through this hole and replace the lock nut.

From the drivers seat engage and disengage the cutter clutch several times to check the smooth operation of the mechanism and most importantly that the cutter brake is functioning properly and the cutting blades stop within seven seconds every time the cutting blades are disengaged, cutters "OUT". Make these checks with the cutter deck firstly in the mid height position then do the same checks in the high and low cut positions. If the cutters do not come to a stop check if the belt still has some tension when the cutter clutch is disengaged and still driving the cutters. If this is the case the idler pulley will need repositioning in the next hole forward. Check also that the belt is not rolled in a pulley or the cutter brake mechanism is failing to make contact with the brake skirt on the pulley or the brake pad needs replacing.

The manufacturer recommends all Greenfield mowers be returned to an authorised Greenfield dealer for normal servicing i.e. oil changes, air filters etc. at the times indicated in the maintenance section and by the engine manufacturer. The manufacturer also recommends a maintenance and safety inspection be performed every 6 months or every 25 working hours by an authorised Greenfield dealer. Refer to warranty leaflet.

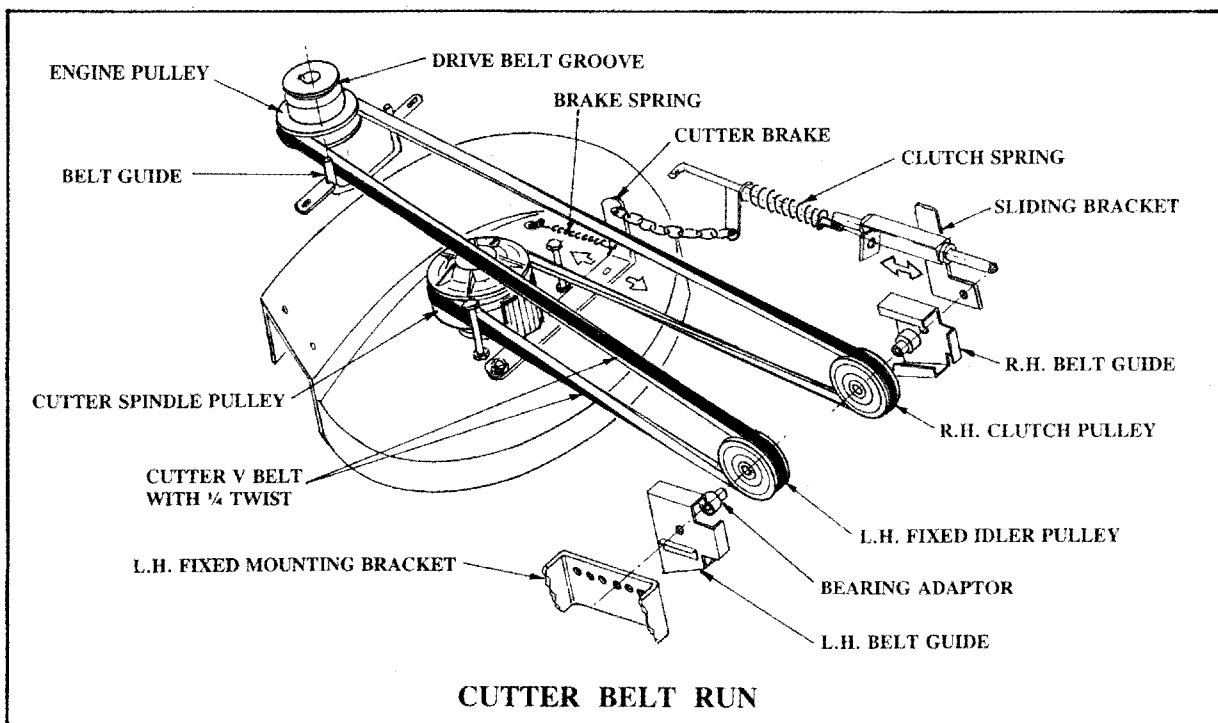

To Remove Cutter V Belt

1. Remove the spark plug lead to prevent accidental starting.
2. Lower the cutter deck to the lowest position.
3. Disengage the cutters, blade clutch "OUT".
4. Remove the V belt from the engine pulley and manoeuvre the belt out between the pulley and the belt guide.
5. The V belt must now be removed from the fixed rear idler pulley which is located on the left side of the mower inside the front of the rear wheel. With a 15mm ring spanner reach under the mower either from the side or the rear to secure the head of the bolt holding this pulley. With a 14mm spanner remove the nut on the outside of this bolt. Remove the assembly from the machine and remove the bolt, belt guide and pulley from the V belt. Repeat this procedure with the cutter clutch pulley on the right side of the machine.
6. Remove the V belt from the cutter spindle pulley by manoeuvring the belt up between the pulley and the belt guides. Remove V belt from the machine.

To Replace Cutter V Belt

1. Remove the spark plug lead to prevent accidental starting.
2. Lower the cutter to the lowest position.
3. Disengage the cutters, blade clutch "OUT".
4. Fit the V belt to the cutter deck pulley by manoeuvring the belt down between the pulley and the belt guide and onto the pulley.
5. Fit the V belt to the engine pulley by manoeuvring the belt over and between the belt guide behind the engine pulley and place in the bottom groove of the engine pulley. See illustration on page 8.
6. The V belt should then be fitted to the cutter clutch side (right) rear idler. Place the pulley in the V belt loop, add the bearing adapter and the RH belt guard and then the bolt. Offer the unit up to the mounting hole, slide the bolt in and secure it with the nyloc nut.
7. The left side rear idler pulley can now be fitted. Place the pulley, adapter and bolt together with the LH belt guard. Offer the unit up to the mounting bracket stretching the belt as far to the rear as possible. Ensure also the belt is taught between the other pulleys. When all slack has been removed from the belt, allow the pulley assembly to travel forward to the next available mounting hole. Press the bolt into this hole and secure it with the nyloc nut.
8. Engage and disengage cutter clutch lever several times to check for smooth operation of the sliding pulley, the cutter brake is working correctly and that the V belt is tensioned by the heavy compression spring when the clutch lever is in the "IN" position. With the lever in the "OUT" position there must be sufficient belt slack to allow the engine pulley to spin freely without moving the belt and the cutters should stop within several seconds.
9. Replace the spark plug lead.
10. From the operator's seat run the engine and engage the cutters to check the V belt operation.

Note – A belt run-in period is required as follows. With the height adjusting lever in the green band (mid height position) engage cutter blades and run for a minimum of ten minutes at medium engine speed. Ideally, a total run-in time would be approximately one hour, during which time you can cut grass, on a mid height position. Refer also to "Cutter Belt Adjustment".

TO REMOVE DRIVE "V" BELT

1. Remove the spark plug lead to prevent accidental starting.
2. Remove the seat securing nuts and washers and disconnect the wire to the seat safety switch then remove the seat and the clearance washers under the seat base and then the rear cover.
3. Set the cutting deck height to the "LOW" position.
4. Swing back the steady bracket supporting the rear clutch link (refer illustration C).
5. Remove the spring clip from the back end of the clutch yoke. Lift off the rear clutch link and swing rearward (refer illustration D).
6. With the spring release hook tool provided (see illustration E), remove the tension spring from the auto adjusting mechanism.
7. Release the non return leaf spring by inserting a flat screwdriver through the slot in the bracket above the leaf spring. Lever the leaf spring clear of the notch bar and hold in a released position allowing the idler pulley to slide freely rearward to permit belt removal. (Refer illustration E).
8. To remove the drive V belt from the engine pulley the cutter V belt must first be removed. Follow steps No 1, 2, 3 and 4 of "To remove cutter V belt" instructions. Now remove the drive V belt from the engine pulley.
9. Lift the drive V belt off both flat idler pulleys and remove the belt through the opening at the rear of the clutch pulleys.

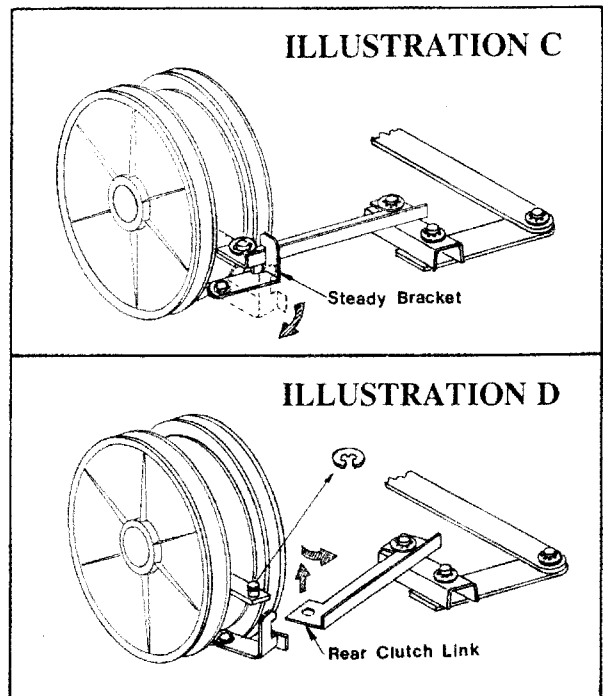

TO REPLACE DRIVE V BELT

1. Feed the belt down the back of the clutch pulleys and forward into the top groove of the engine pulley. If the cutter V belt is in position on the engine pulley, remove the belt by following steps No 1, 2, 3 and 4 of "To remove cutter V belt" instructions.
2. Fit the belt into both clutch pulleys then into the idler pulley on the self adjusting mechanism. This pulley will need to be in the fully rearward position for this assembly operation.. Lubricate the slide with grease.
3. Fit belt over both flat idler pulleys. The back of the belt runs on top of the pulleys. See illustration F and G
4. Replace the spring on the self adjusting mechanism using the hook tool.
5. Replace the rear clutch link and the spring clip.
6. Swing the steady bracket forward to support the rear clutch link.
7. Refit the cutter V belt into the bottom groove of the engine pulley by following steps No. 1,2,3 and 5 of "To replace cutter V belt" instructions.
8. Replace the back cover and clearance washers, reconnect the wire to the seat safety switch, replace the seat and the washers and lock nuts.
9. Replace the spark plug lead.

ILLUSTRATION E

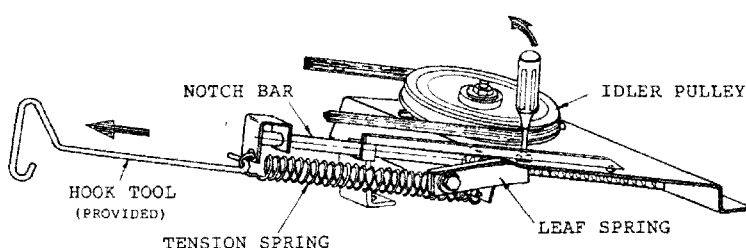
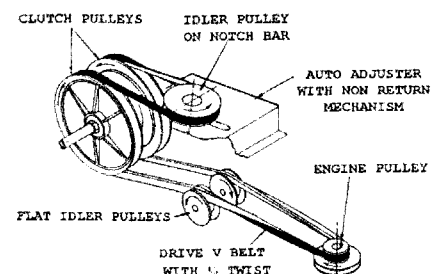
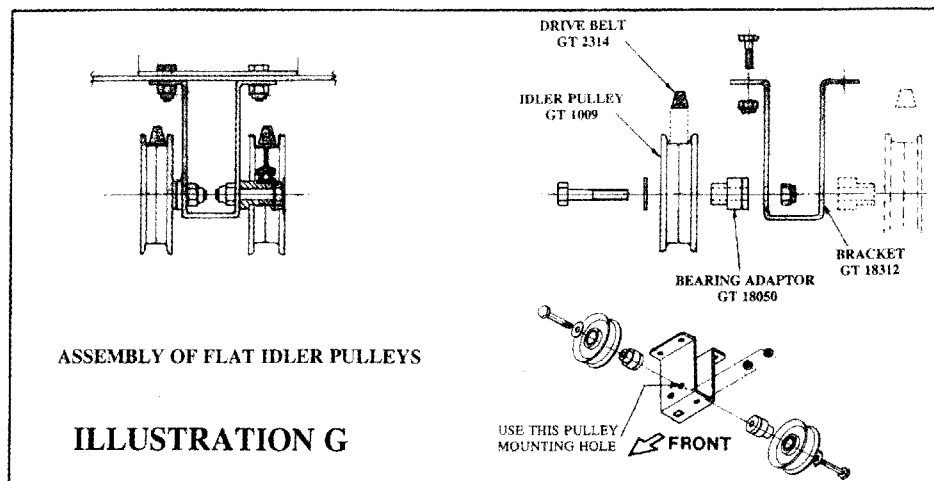

ILLUSTRATION F





Maintenance

Warning: Remove the spark plug lead to avoid accidental starting **BEFORE** attempting any maintenance or inspection of the mower.

Crankcase Lubrication

Change engine oil after the first 5 hours of operation then every 6 months or 25 working hours, whichever comes first. Change more often in heavy work or dusty conditions. Drain engine oil whilst engine is warm then replace with a high quality SAE 30 detergent oil classified for service SF/SG..

Fill to full mark indicated on the dipstick. Do not overfill. To check oil level, position the mower on level ground. Wipe or brush the area clean around the oil fill/dipstick cap, remove the dipstick and wipe clean. Replace dipstick screwing correctly into position. Remove again and sight the oil level. The dipstick must be firmly in place when the engine is running. Refer to the engine manufacturers operating booklet to confirm oil recommendations.

Air Filter

Service the air filter as per the engine manufacturers booklet. Clean or replace more often in dusty conditions. Never operate the engine without the air filter correctly and securely fitted – rapid and expensive wear to the engine will occur.

Cooling System

Remove the blower housing and clean out the grass and debris to prevent engine overheating. Refer to engine manufacturer's booklet.

Battery (if fitted)

To maintain the correct fluid level in the battery, top with distilled water only, to the high level mark shown on the battery.

NOTE: If the mower is not used for at least 5 hours a month the battery will discharge and could sustain permanent damage. Do not allow the battery to discharge. Regularly trickle charge with a current not exceeding 3 amps per hour for 3 to 4 hours to prolong battery life. Keep the outside of the battery, especially the terminals clean and dry and check the battery is held securely.

The maintenance of the battery is the customers responsibility and only faulty batteries are covered by warranty. Neglect is not covered.

Dry Battery:

When initially charging a new DRY battery, each cell must be filled to the high level with an electrolyte (dilute sulphuric acid) with a specific gravity of 1.26 at 20°C to 30°C. The battery must then be allowed to stand for 30 minutes before charging at a rate not exceeding 3 amps for 4 hours.

WARNING: Persons not trained in the proper procedure to transfer fluids containing acid or do not have the necessary safety equipment on hand in case of a spill or exposure, should not attempt this procedure. Contact the battery manufacturers local agent or an authorised Greenfield dealer.

Wheels

The rear wheel nuts should be re-tensioned after the first 5 hours of operation to 78Nm (58ft lbs) then regularly with your preventative maintenance checks.

Tyres

Inflate to the correct pressures 20 to 22 psi (140 to 154 kPa) in the front and rear. Do not over inflate. Over inflation will permanently change the shape of the tyre. Over or under inflation will also adversely affect the cutter deck trim and tilt and cause uneven cutting.

Cutter Deck

Regularly check the condition of the cutting blades, blade bolts and cutter disc also the cutter V belt and pulleys. Refer to pages 7 to 10 for fitting instructions.

Cleaning

Never wash your Greenfield with a high pressure wash gun. Water and dirt could be blasted past the seals in the bearings causing premature bearing failures and rusted pivot points.

- ñ Never wash your Greenfield immediately after use. The quenching contraction effect from hosing off the machine when it's at operating temperature could draw water and dirt into the bearings and cause premature bearing failures.
- ñ The best way to clean your Greenfield is to use an air hose to blow the loose grass, etc. from around pulleys, belts and the top of the cutter deck. Wash the exterior with a sponge and bucket, then rinse off with a hose and wipe it down the same as you would your car. For maximum machine life, do not spray water on the pulleys and bearings. Recoil all pivots after cleaning.
- ñ Allow your Greenfield to cool after use then clean off all grass and other debris before storing. Sticks, stones or an accumulation of grass and other debris will damage belts and fracture pulleys if they are allowed to pass between a belt and pulley. When operating in these conditions the cutter deck may require more frequent cleaning.

Chassis Lubrication

Your Evolution 2000 Greenfield mower has 2 greasing points. A grease nipple is fitted to each king pin housing in the front axle beam. Grease these locations every 6 months or 50 operating hours with a quality No. 2 lithium base grease or equivalent. All other exposed pivoting joints, lever points and slides are to be lubricated with engine oil.

Rear Drive Chain Adjustment

1. Remove the spark plug lead to prevent accidental starting.
2. Using a 14mm socket spanner with a 150mm extension loosen the nut on the centre of the chain tensioning idler and also the slide lock nut immediately to the front of the tension idler.
3. By rolling the mower back just slightly this will tension the back run of chain and feed all the slack chain to the front run of chain, the adjusting side. With a soft hammer tap the tensioning idler rearward until the slack has been removed from the chain then with hand pressure only hold the idler firmly against the chain while the centre lock nut is retightened. The chain should have 3mm slack as shown in illustration "H". Do not overtighten the chain. Retighten the slide lock nut.
4. Replace the spark plug lead.

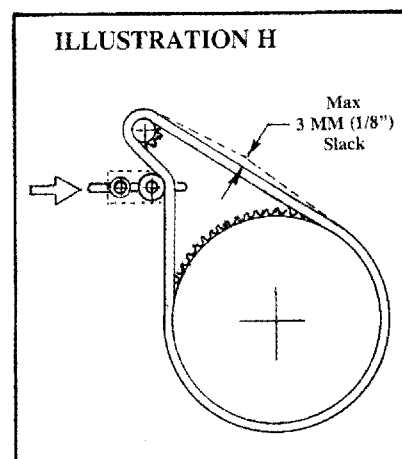

ELECTRICAL CIRCUITS

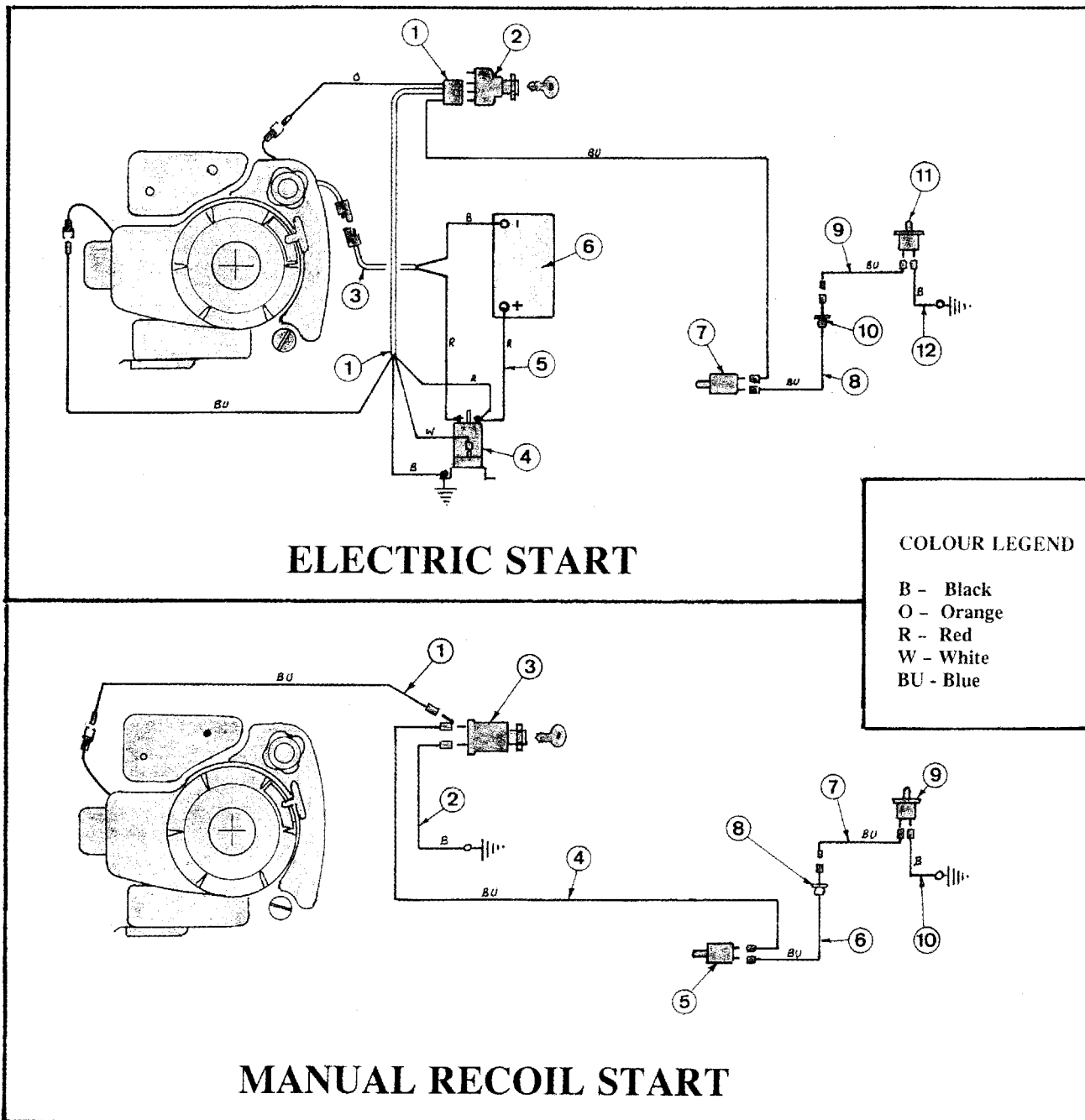

ELECTRIC START

MANUAL RECOIL START

INDEX	PART NO.	DESCRIPTION	INDEX	PART NO.	DESCRIPTION
1.	GT 23066	Key Switch Harness	1.	Gt 23068	Briggs & Stratton Engine to Sw
2.	GT 2219	Key Switch		GT 23069	Tecumseh Engine to Switch
3.	GT 23065	Starter Motor Harness		GT 23070	Kawasaki Engine to Switch
4.	GT 2220	Starter Solenoid	2.	GT 23071	Wire - Key Switch to Frame
5.	GT 14364	red cable	3.	GT 2321	Key switch
6.	GT 2213	Battery 12V - 14A	4.	GT 23067	Wire - Key Sw to Brake Sw
7.	GT 2313	Switch - Brake Activated	5.	GT 2313	Switch - Brake Activated
8.	GT 23064	Wire - Brake Sw to Connector	6.	GT 23064	Wire - Brake Sw to Connector
9.	GT 23062	Wire - Connector to Seat Sw	7.	GT 23062	Wire - Connector to Seat Sw
10.	GT 3027	Clamp - Wire Restrain	8.	GT 3027	Clamp - Wire Restrain
11.	GT 2312	Switch - Seat Activated	9.	GT 2312	Switch - Seat Activated
12.	GT 23063	Wire - Seat Sw to Frame	10.	GT 23063	Wire - Seat Sw to Frame

PARTS AND SPECIFICATIONS SUBJECT TO CHANGE WITHOUT NOTICE.

LINKAGES

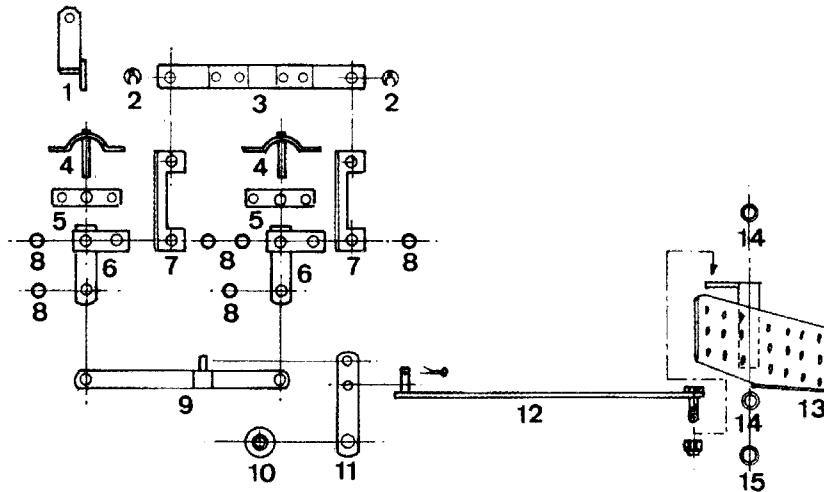

DRIVE CLUTCH

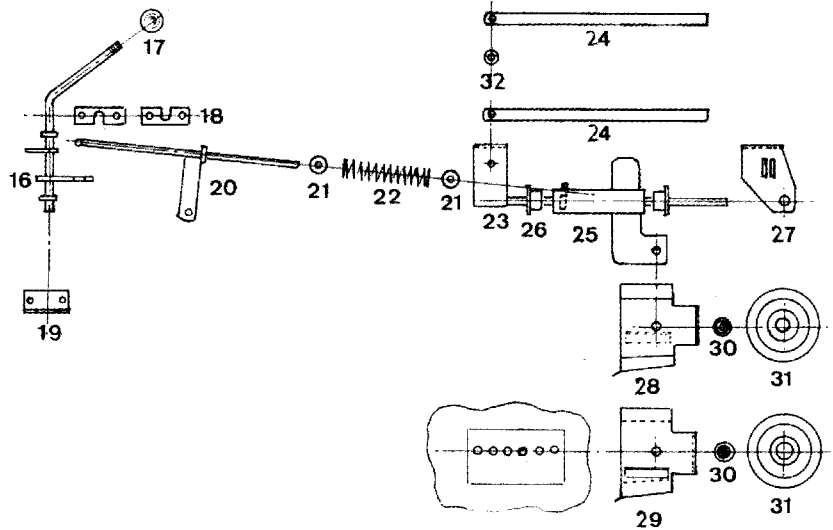

CUTTER CLUTCH

INDEX	PART NO.	DESCRIPTION	INDEX	PART NO.	DESCRIPTION
1.	GT 23470	Steady - Clutch Yoke	17.	GT 01565	Knob
2.	GT 2036	Spring Clip	18.	GT 22166	Retainer Plates
3.	GT 20945	Yoke Unit	19.	GT 23167	Bracket
4.	GT 20395	Pivot Pin Assembly	20.	GT 23455	Cutter Clutch Rod
5.	GT 22151	Support	21.	GT 00585	Cup Washer
6.	GT 23400	Pivot Arm Assembly	22.	GT 14022	Spring
7.	GT 23168	Links - Clutch	23.	GT 23425	Slide Rail Assembly
8.	GT 2057	Retainer	24.	GT 23165	Rails
9.	GT 23450	F-R Control	25.	GT 23420	Sliding Bracket Assembly
10.	GT 23044	Pivot	26.	GT 01766	Bush
11.	GT 18318	Link	27.	GT 23164	Bracket
12.	GT 23410	F-R Control	28.	GT 23475	R.H. Belt Guide
13.	GT 23385	Foot Pedal Assy.	29.	GT 23480	L.H. Belt Guide
14.	GT 12394	Bush	30.	GT 23055	Adaptor
15.	GT 00580	Retainer	31.	GT 07965	Pulley
16.	GT 23430	Clutch Lever Assembly	32.	GT 730	Bush

PARTS AND SPECIFICATIONS SUBJECT TO CHANGE WITHOUT NOTICE.

LINKAGES

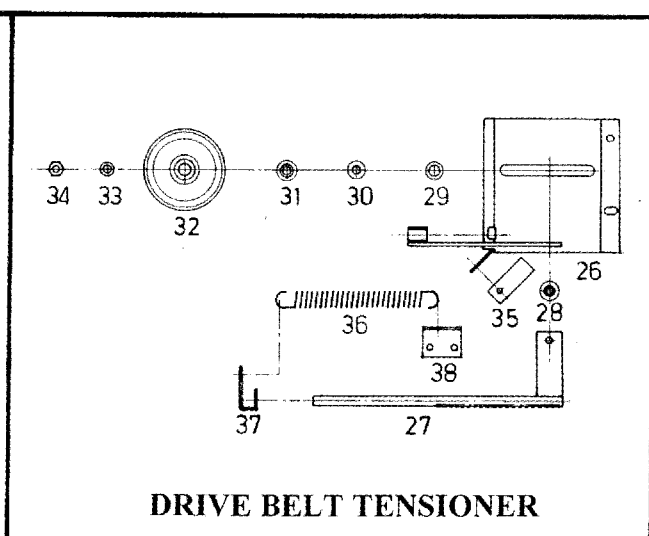
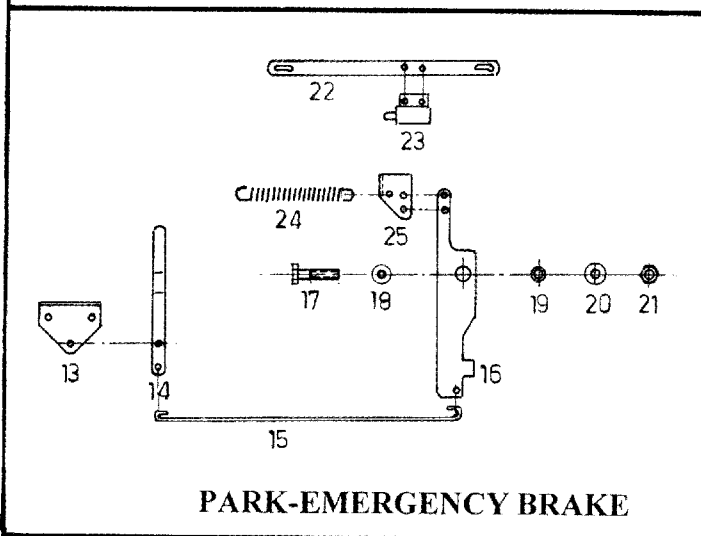
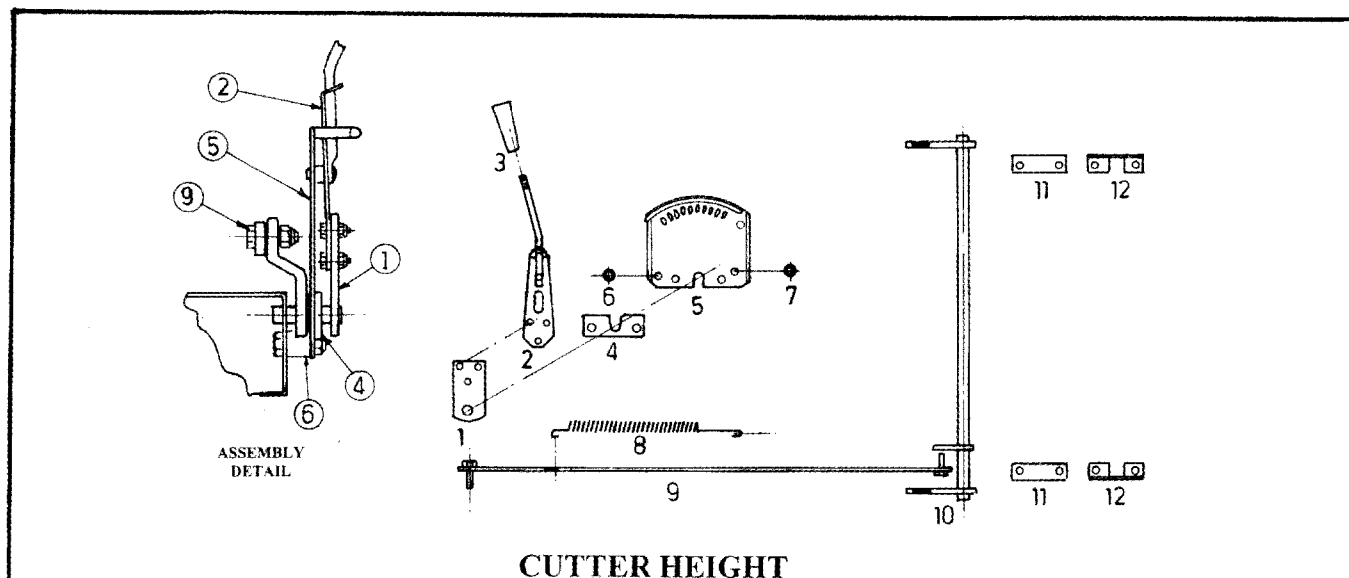

INDEX	PART NO.	DESCRIPTION
1.	GT 23305	Pivot Arm Ass.
2.	GD 5532	Height Adj Lever
3.	GD 5546	Handle
4.	GT 23150	Bearing Plate
5.	GT 23310	Rack - Height Adj.
6.	GT 23172	Spacer 15mm Long
7.	GT 23173	Spacer 9mm Long
8.	GD 5547	Tension Spring
9.	GT 23465	Link - Height Adj.
10.	GT 23325	Height Adjust Shaft
11.	GT 18314	Packer
12.	GT 18313	Pivot Bracket
13.	GT 23152	Pivot Bracket - Bke
14.	GT 23315	Brake Lever
15.	GT 23033	Pull Wire - Brake
16.	GT 23154	Brake Arm
17.	GT 2548	High Tensile Bolt
18.	GT 2550	Washer
19.	GT 23032	Pivot Bush

INDEX	PART NO.	DESCRIPTION
20.	GT 23155	Spacer
21.	GT 2549	Nut Nyloc
22.	GT 23156	Bar - Micro Switch
23.	GT 2313	Switch - Brake Activated
24.	GT 21004	Tension Spring
25.	GT 23151	Bracket - Spring Anchor
26.	GT 23375	Bracket - Drive Belt Adjust
27.	GT 18765	Notch Bar
28.	GT 608	Slide Bush
29.	GT 23	Washer
30.	GT 579	Wave Washer
31.	GT 610	Bearing Adaptor
32.	GT 7965	V Pulley Complete
33.	GT 1012	Washer
34.	GT 2466	Nut Nyloc
35.	GT 14023	Leaf Spring
36.	GT 20006	Tension Spring
37.	GT 7308	Spring Anchor - Notch Bar
38.	GT 23166	Spring Anchor - Frame

PARTS AND SPECIFICATIONS SUBJECT TO CHANGE WITHOUT NOTICE.

ENGINE AND COMPONENTS

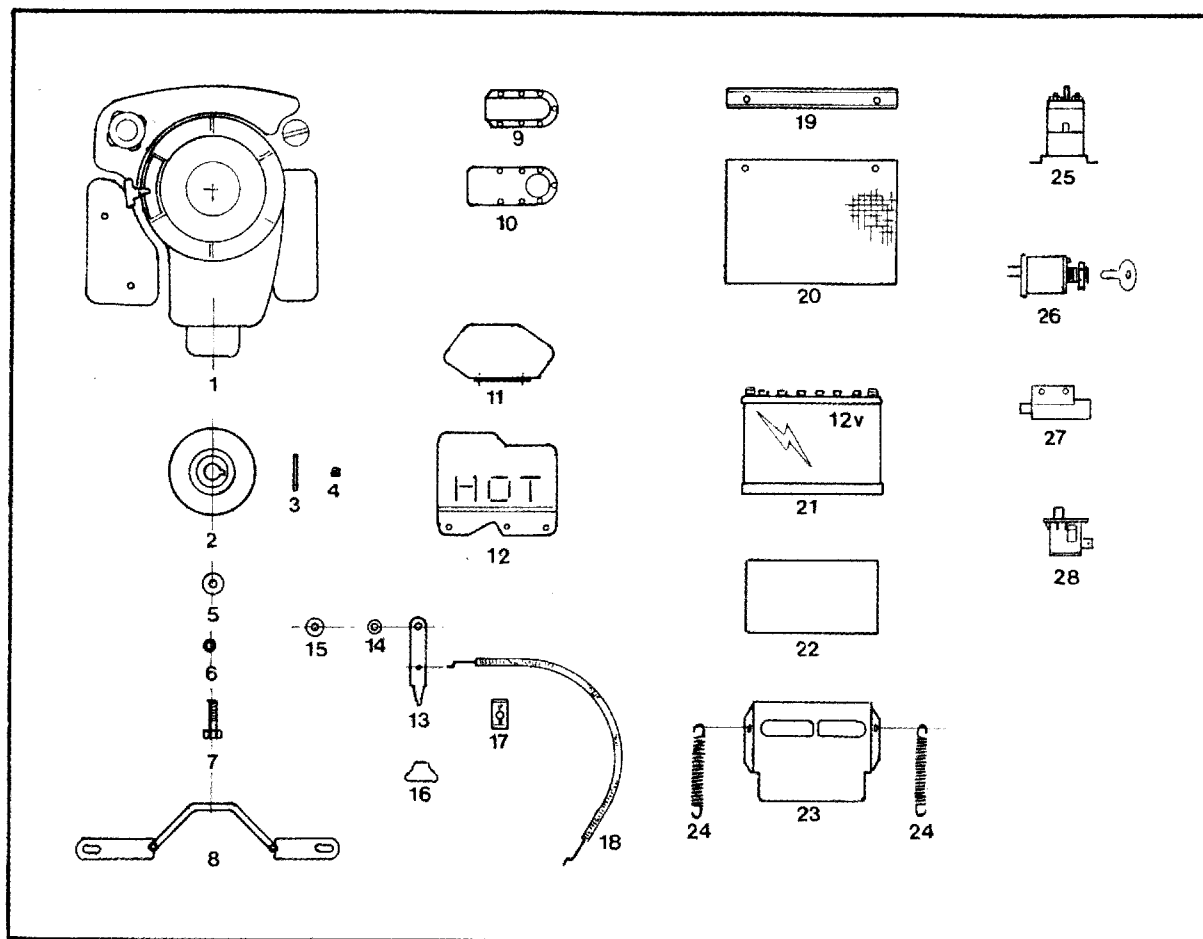

REVISION

ITEM 8 NOW GT23540

INDEX	PART NO.	DESCRIPTION	INDEX	PART NO.	DESCRIPTION
1.	GT 2315	B & S Elec. Start INTEK 65 Motor	15.	GT 1035	Washer
1.	GT 2311	B & S Manual Start INTEK 65 Motor	16.	GT 2026	Knob - Throttle Lever
2.	GT 23034	Pulley - Engine	17.	GT 1252	Cable Clamp
3.	GT 4121	Key	18.	GT 23751	Throttle Cable
4.	GT 0520	Set Screw	19.	GT 23175	Clamp Strip
5.	GT 16317	Washer	20.	GT 23174	PVC Battery Cover
6.	GT 2054	Spring Washer	21.	GT 2213	Battery
7.	GT 1475	Bolt	22.	GT 23186	Rubber Mat - Battery
8.	GT 23395	Belt Guard	23.	GT 23176	Battery Clamp
9.	GT 23178	Back Plate - Deflector	24.	GT 0749	Spring - Tension
10.	GT 23177	Deflector - Exhaust	25.	GT 2220	Solenoid - Starter Motor
11.	GT 23181	Heat Shield - Foot Rest	26.	GT 2219	Key Switch - Electric
12.	GT 23180	Heat Shield - Exhaust	26.	GT 2321	Key Switch - Manual
13.	GT 20169	Throttle Lever	27.	GT 2313	Switch - Brake
14.	GT 1477	Tension Washer	28.	GT 2312	Switch - Seat

PARTS AND SPECIFICATIONS SUBJECT TO CHANGE WITHOUT NOTICE.
STANDARD HARDWARE ITEMS NOT SHOWN.

DRIVE CLUTCH AND REAR AXLE

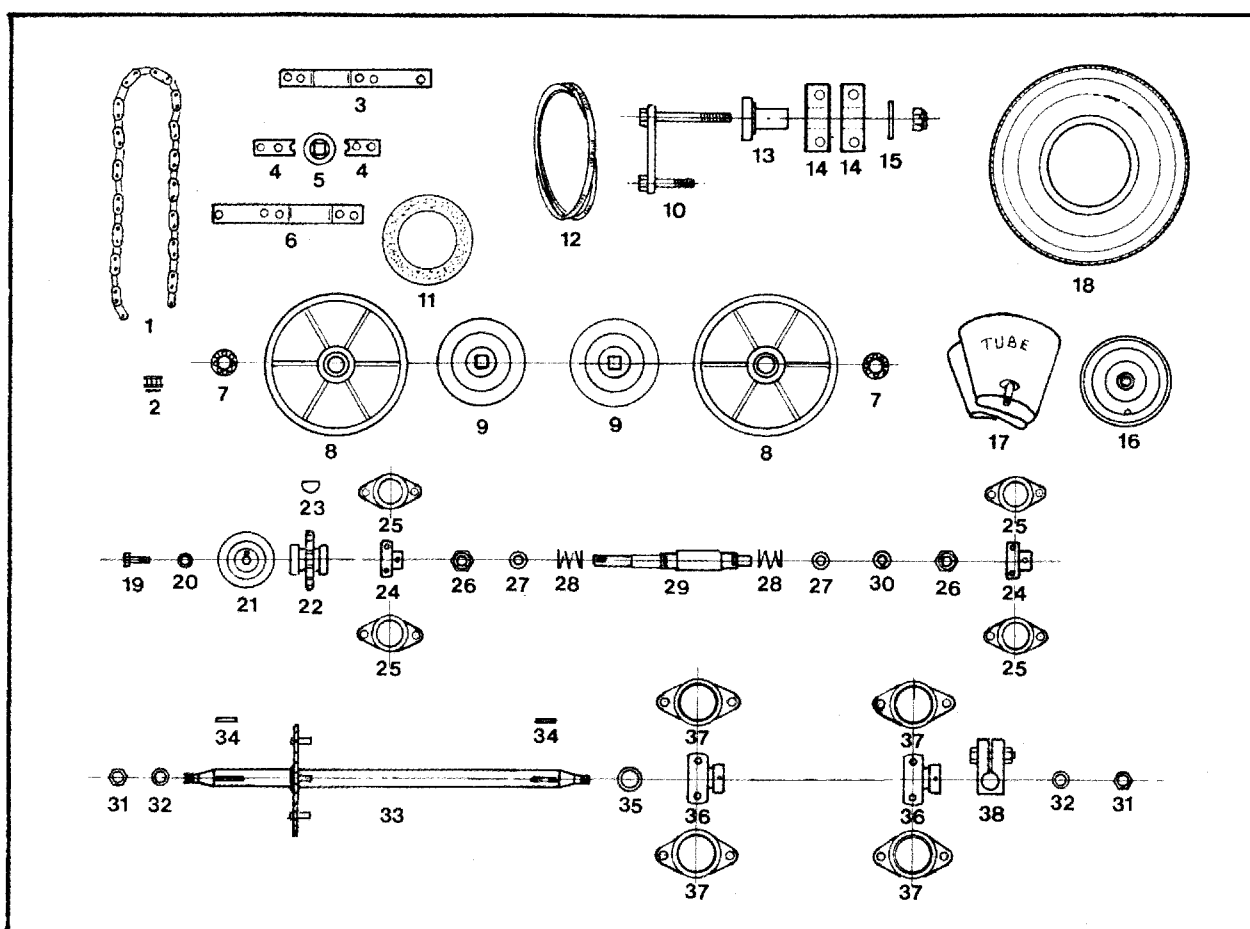

INDEX	PART NO.	DESCRIPTION	INDEX	PART NO.	DESCRIPTION
1.	GT 18006	Roller Chain	20.	GT 2542	Cone Washer
2.	GT 501	Connecting Link	21.	GT 18334	Disc - Chain Guard
3.	GT 20510	Yoke Top Half	22.	GT 23039	9 Tooth Sprocket
4.	GT 20191	Retainer - Bearing	23.	GT 0517	Key
5.	GT 20935	Clutch Bearing Unit	24.	GT 0392	Ball Bearing - Drive Shaft
6.	GT 20515	Yoke Bottom Half	25.	GT 7017	Bearing Plates
7.	GT 395	Ball Bearing - Clutch Pulley	26.	GT 0347	Nut
8.	GT 6850	Clutch Pulley Complete	27.	GT 7303	Washer
9.	GT 6855	Drive Plate Complete	28.	GT 0357	Spring
10.	GT 23320	Chain Adjuster Slide	29.	GT 23040	Square Drive Shaft
11.	GT 6012	Clutch Lining	30.	GT 0539	Shim - As Required
12.	GT 2314	V Belt Drive	31.	GT 2547	Nyloc Nut
13.	GT 23043	Bearing Adaptor	32.	GT 0023	Washer
14.	GT 0396	Ball Bearing	33.	GT 23041	Rear Axle & Sprocket
15.	GT 9407	Washer	34.	GT 12093	Key
16.	GT 0416	Wheel Hub	35.	GT 23042	Spacer
17.	GT 0456	Tube	36.	GT 0391	Ball Bearing - Rear Axle
18.	GT 2285	Tyre	37.	GT 7083	Bearing Plates
19.	GT 1455	Set Screw	38.	GT 7065	Clamp - Axle

PARTS AND SPECIFICATIONS SUBJECT TO CHANGE WITHOUT NOTICE.
STANDARD HARDWARE ITEMS NOT SHOWN.

STEERING AND FRONT AXLE

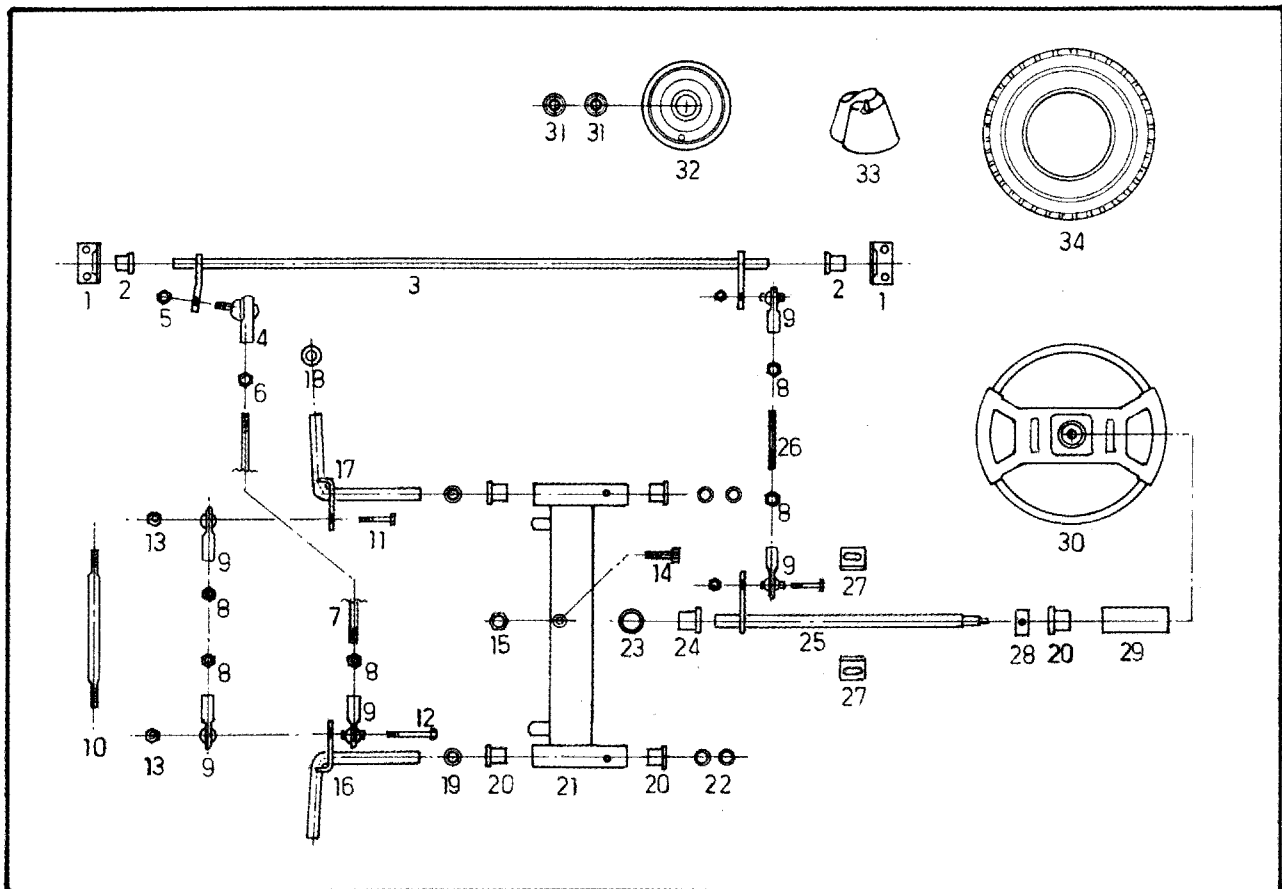

INDEX	PART NO.	DESCRIPTION	INDEX	PART NO.	DESCRIPTION
1.	GT 23171	Bracket	18.	GT 07009	Collar
2.	GD 5526	PVC Bush	19.	GT 07304	Washer
3.	GT 23445	Transfer Shaft	20.	GT 01766	PVC Bush
4.	GT 2294	Tie Rod End L.H.	21.	GT 23435	Front Axle Beam
5.	GT 2090	Nyloc Nut	22.	GT 00580	Retainer
6.	GT 2295	Lock Nut L.H.	23.	GT 23042	Spacer
7.	GT 23058	Steering Link	24.	GT 06056	Bronze Bush
8.	GT 78	Lock Nut	25.	GT 23440	Steering Shaft
9.	GT 1626	Tie Rod End	26.	GT 23047	Steering Rod
10.	GT 23059	Tie Rod	27.	GT 23169	Steering Stops
11.	GT 35	Bolt 38 Long	28.	GT 07009	Collar
12.	GT 1118	Bolt 58 Long	29.	GT 23158	PVC Cover
13.	GT 2466	Nyloc Nut	30.	GT 01785	Steering Wheel Complete
14.	GT 2476	Bolt	31.	GT 02202	Wheel Bearings
15.	GT 2042	Nyloc Nut	32.	GT 07093	Wheel Hub
16.	GT 20505	L.H. King Pin	33.	GT 01454	Tube
17.	GT 20495	R.H. King Pin	34.	GT01453	Tyre

PARTS AND SPECIFICATIONS SUBJECT TO CHANGE WITHOUT NOTICE.
STANDARD HARDWARE ITEMS NOT SHOWN.

CUTTER DECK

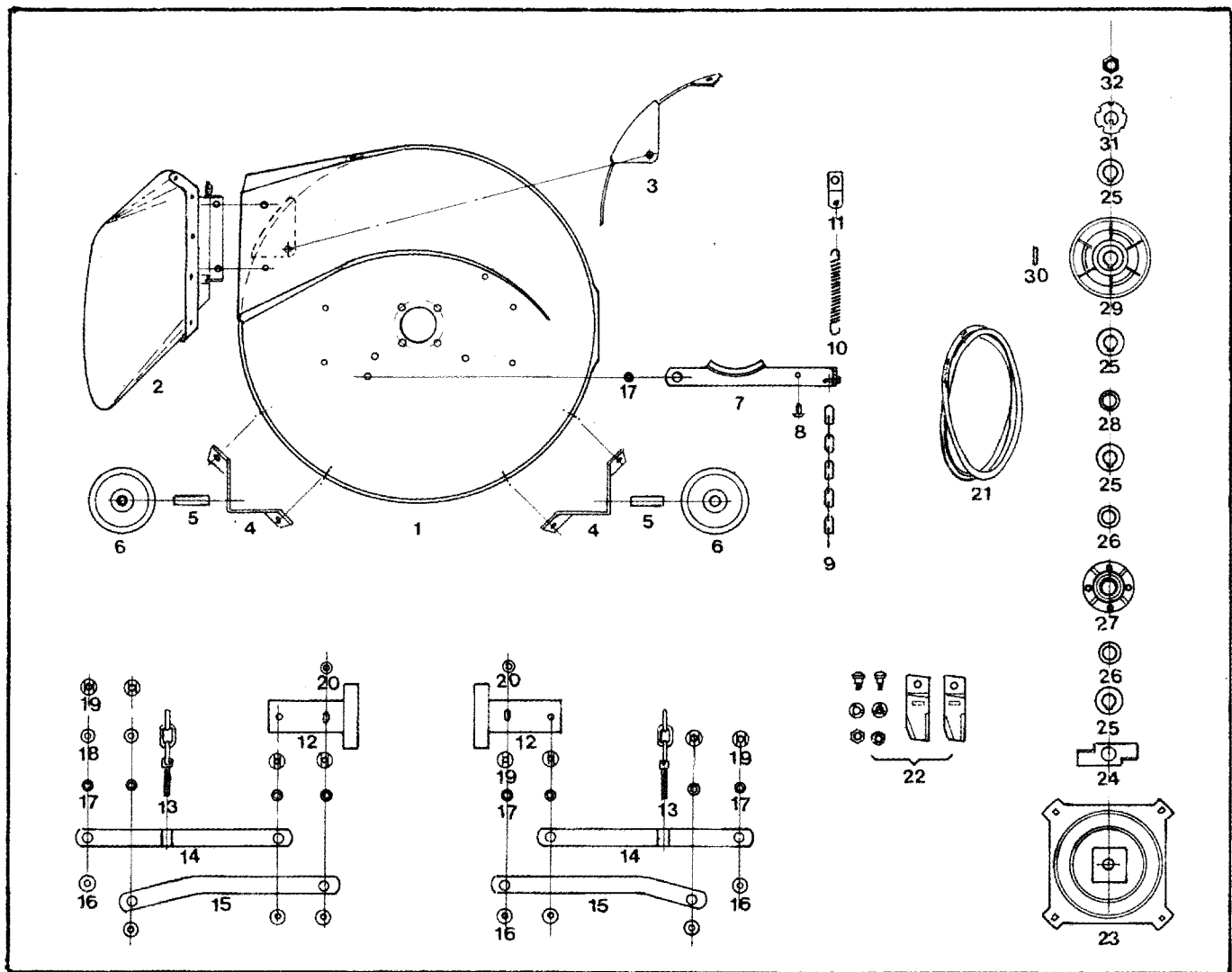

INDEX	PART NO.	DESCRIPTION	INDEX	PART NO.	DESCRIPTION
1.	GT 23163	25 Cutter Deck Drilled Casting	17.	GT 730	Pivot Bush
2.	GT 23750	Stone Guard	18.	GT 2531	Thick Washer
3.	GT 23560	Mulching Plug	19.	GT 597	Wave Washer
4.	GT 23157	Bracket Jockey Wheel	20.	GT 1567	Cone Washer
5.	GT 22005	Bush	21.	GT 2314	V-Belt - Cutters
6.	GT 2264	Jockey Wheel	22.	GT 2320	Blade & Bolt Set
7.	GT 23756	Cutter Brake Unit	23.	GT 23460	Cutter Disc & Spindle
8.	GT 1760	Nylon Button	24.	GT 20214	Bearing Protector
9.	GT 23183	Chain - Cutter Brake	25.	GT 20177	Keyed Washer
10.	GT 21004	Spring - Cutter Brake	26.	GT 539	Shim
11.	GT 5056	Spring Anchor	27.	GT 13815	Spindle Housing Complete
12.	GT 18850	Side Plate	28.	GT 23054	Spacer - Disc Spindle
13.	GT 18975	Chain - Deck Adjust	29.	GT 23031	V - Pulley
14.	GT 18970	Top Link	30.	GT 20019	Key
15.	GT 18333	Bottom Link	31.	GT 14390	Tag Washer
16.	GT 1012	Washer	32.	GT 2003	Nut M20 L.H.

PARTS AND SPECIFICATIONS SUBJECT TO CHANGE WITHOUT NOTICE.
STANDARD HARDWARE ITEMS NOT SHOWN.

BODY WORKS AND SEAT

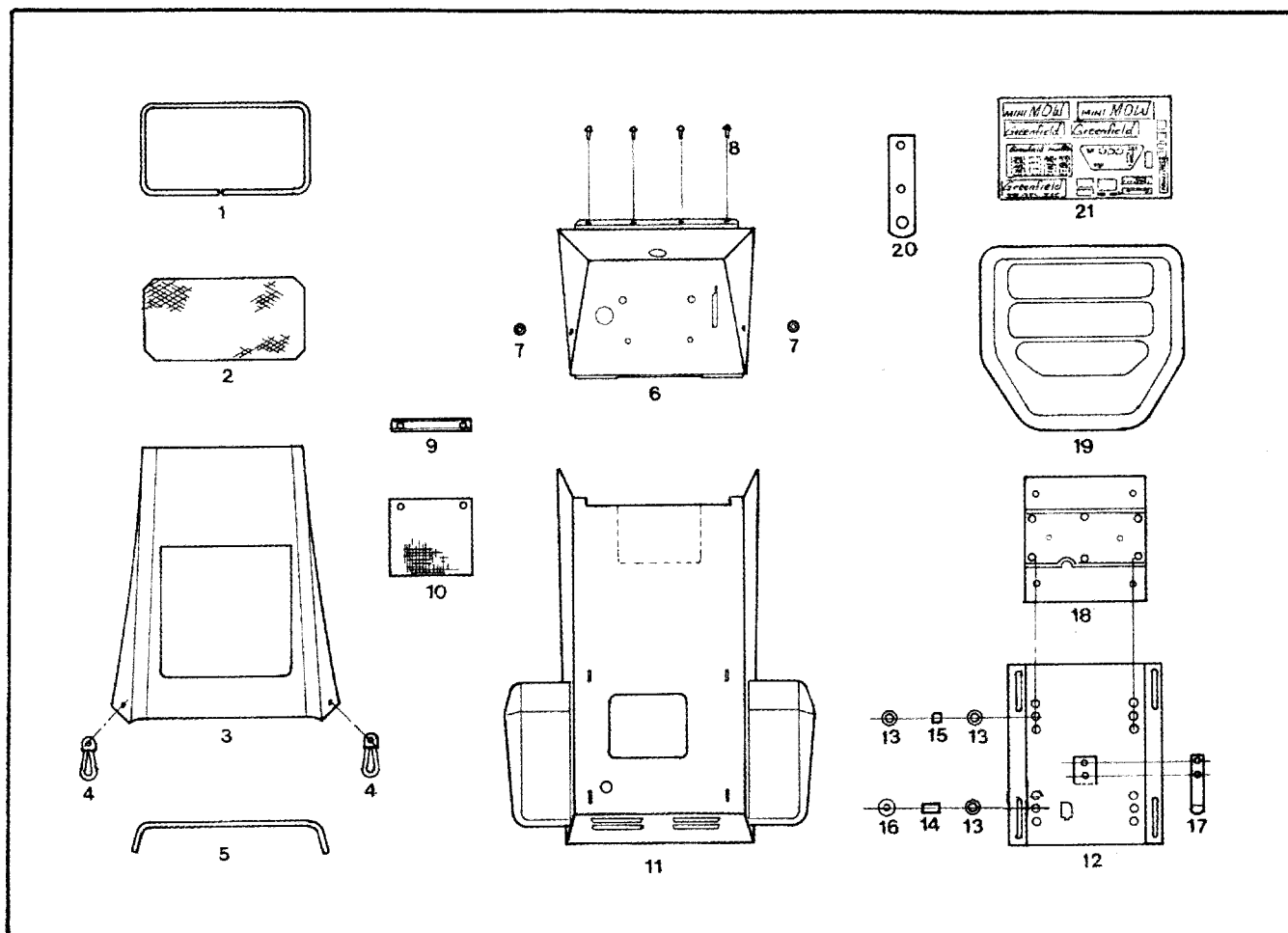

INDEX	PART NO.	DESCRIPTION	INDEX	PART NO.	DESCRIPTION
1.	GT 23187	Pinchweld - Front	11.	GT 23495	Rear Cover - Manual Start
2.	GT 23182	Grille - Bonnet	12.	GT 23199	Sliding Base - Seat
3.	GT 23505	Bonnet	13.	GT 23056	Rubber "O" Ring
4.	GT 7015	Strap - Bonnet Hold Down	14.	GT 23160	Bush - Long
5.	GT 23188	Pinchweld - Rear	15.	GT 23161	Bush - Short
6.	GT 23500	Steering Cowl	16.	GT 1035	Washer
7.	GT 2254	Bobbin - Strap	17.	GT 23038	Leaf Spring
8.	GT 6094	Buffer Grommet	18.	GT 23185	Seat Adaptor Plate
9.	GT 23175	Clamp - Battery Cover	19.	GT 8060	Seat
10.	GT 23174	Battery Cover	20.	GT 23170	Tow Bar Tongue
11.	GT 23485	Rear Cover - Electric Start	21.	GT 23060	Decal Sheet - Full Set

PARTS AND SPECIFICATIONS SUBJECT TO CHANGE WITHOUT NOTICE.
STANDARD HARDWARE ITEMS NOT SHOWN.

Guarantee

Greenfield Mowers Pty Ltd, the manufacturer, guarantee their product to be free of faulty workmanship and material for a period of 12 months for domestic use, 3 months for commercial use from the date of purchase to the original owner. This guarantee for Greenfield Minimow 25 mowers covers machines in domestic or owner operated commercial use only. Mowers hired out or used in institutional or industrial situations are not covered by the manufacturers guarantee. Engines and batteries used on Greenfield mowers carry the respective manufacturers warranty.

This Guarantee will not apply to:

- Fair wear and tear, V Belts, Tyres, Tubes, Blades and Blade Bolts, blade holder, and damage caused by misuse, neglect and accidents.
- Repairs rendered necessary or arising from use of other than genuine Greenfield parts, or the relevant genuine engine manufacturers parts.
- Any work performed by other than an authorised Greenfield Dealer, or damages arising therefrom or parts that have been tampered with or dismantled.

To claim warranty on the Greenfield Minimow the customer must return the mower intact to an authorised Greenfield Dealer. In all warranty claims the manufacturer's decision is final and binding.

The benefits conferred by the above guarantee are in addition to all other rights and remedies in respect of the product which the consumer has under existing laws in Australia and New Zealand.

Greenfield Mowers Pty Ltd, the manufacturer reserves the right to change parts and specifications without notice.

Guarantee Registration Details:

Owner _____

Address _____

Postcode _____

Purchase Date _____ Model _____

Chassis No _____ Motor Serial/ Batch No _____

Dealer Signature _____

This record should be completed and held by the purchaser and presented should service under guarantee be required. To register your guarantee, please complete the enclosed guarantee card and return to Greenfield Mowers.

Greenfield Mowers Pty Ltd

172 Ingram Road, Acacia Ridge, Qld. 4110

P.O. Box 155 Archerfield, Qld. 4108 Australia

Phone (07) 33456100 / Fax (07) 33441161

Web site: www.greenfield.com.au / Email: greenfield@gil.com.au