

# Greenfield

**M O W E R S**

## OWNER'S MANUAL

*Evolution*  ***FASTCUT*** <sup>TM</sup> *Series*

***FASTCUT<sup>\*</sup>34***

**13.5 TO 22 HP**



***FASTCUT<sup>\*</sup>32***

**11.5 TO 13.5 HP**



# INSTRUCTIONS

# AND SPARE PARTS

Greenfield Mowers Pty Ltd  
172 Ingram Road, Acacia Ridge. Qld. 4110  
P.O. Box 155 Archerfield. Qld. 4108  
Phone (07) 33456100 / Fax (07) 33441161

Web site: [www.greenfield.com.au](http://www.greenfield.com.au) / Email: [greenfield@gil.com.au](mailto:greenfield@gil.com.au)

# Contents

|   |    |
|---|----|
| Safety Instructions                           | 2  |
| Operating Instructions                        | 4  |
| Differential Instructions                     | 6  |
| Maintenance                                   |    |
| General                                       | 7  |
| Maintenance                                   |    |
| Blades and Belts                              | 9  |
| Maintenance                                   |    |
| Chains and Steering and Parking Brake         | 13 |
| Electrical Circuits                           | 16 |
| Spare Parts                                   |    |
| Linkages – Cutter Clutch and Drive Clutch     | 17 |
| Linkages – Brake, Height Adjust and Notch Bar | 18 |
| Idler Pulleys – Drive Belt                    | 19 |
| Engine and Electrics                          | 20 |
| Drive Clutch and Rear Axle                    | 21 |
| Steering and Front Axle                       | 22 |
| Cutter Deck                                   | 23 |
| Body Work and Seat                            | 24 |
| Service Record                                | 25 |
| Guarantee                                     | 26 |
| Other Greenfield Products                     |    |



All details are correct at time of printing but are subject to change without notice

# Evolution ***FASTCUT***<sup>TM</sup> Series

Thank you for buying an Australian made **Greenfield** tractor mower. Follow the manufacturers operating and maintenance instructions and many years of excellent trouble free service can be expected.

**Before operating the mower read the owners manual carefully.** Do not allow children or any person unfamiliar with the safe operating procedure to operate this mower. Your Greenfield mower has been designed to meet stringent safety standards – but we remind you that a mower is a cutting device – **used incorrectly it could cause serious personal injury or death. Remove the key when machine is not in use.**

## Safety Instructions

1. Do not carry passengers.
2. Know your controls. Read the operating instructions carefully. Learn how to stop the mower and the engine quickly in an emergency.
3. Do not mow whilst people, especially children or pets are in the mowing area.
4. Make sure the area to be mown is clear of sticks, stones, bottles, bones, wire and other debris which could be thrown by the blades.
5. Do not operate the machine without first inspecting the blades, blade bolts and blade holder for wear or damage. **Damaged blades and worn bolts are major hazards.** Always replace blades and blade bolts in sets to preserve balance. Replace worn or damaged parts with **genuine Greenfield** replacement parts only. N.B. Use of inferior non-genuine service parts on your Greenfield mower could result in costly damage and even personal injury. Refer "Maintenance Instructions", for replacement part numbers and fitting instructions.
6. Before using, check that the grass catcher, safety switches and guards provided by the manufacturer are operating properly and fitted securely. Regularly check all the components on the mower to ensure the machine is in a safe operating condition.
7. Never mow while barefoot or wearing open sandals or thongs. Wear long trousers and heavy shoes. It is also important to wear suitable eye protection.
8. A mower operator should be in good physical and mental health and not under the influence of any drug or alcohol which might impair vision, co-ordination or judgements.
9. Replace worn or faulty exhaust mufflers.
10. Keep the engine free of grass, leaves or excessive grease. These can be a fire hazard.
11. Refuel outdoors only. Do not smoke while refuelling engine. Never remove the cap of the fuel tank or add petrol while the engine is running or if the engine is hot, allow it to cool. Remove fuel cap slowly to relieve any tank pressure. Do not overfill the fuel tank. If petrol is spilled do not attempt to start the engine but move the machine away from the area of the spill and avoid creating any source of ignition until petrol vapours have dissipated.
12. Check for fuel leaks, while refuelling or using the mower. If a fuel leak is detected, do not start the engine until the fuel leak is fixed and the spilled fuel is wiped away.
13. Do not operate the engine in a confined space where the poisonous exhaust fumes (carbon monoxide) can collect.
14. Always disengage the cutting blades from the operation seat before starting or stopping the engine.

16. Reduce speed particularly when making sharp turns to prevent overturning or loss of control. Do not stop or start suddenly when mowing up hill or down hill. The differential action must be locked out when operating on any slope to improve traction and safety.
17. Never mow up hill or down hill on slopes which exceed 10 degrees, or mow across the face of a slope which exceeds 5 degrees.

BEFORE attempting to mow on any slope, refer to "Mowing on Slopes" on page 5 in this Owners Manual.

18. Stay alert for holes in the terrain and other hidden hazards.
19. Before crossing paths, driveways or any other area foreign to mowers, reduce engine speed, disengage cutting blades and lift cutting attachment to maximum height. Do not drive over obstacles or gutters, this machine has a maximum 3 1/2" (9cm) clearance.
20. Watch out for traffic when crossing or operating the mower near roadways. **Always mow with the safety grass deflector properly fitted.**
21. When mowing, never direct discharge of material toward bystanders nor allow anyone near the machine while in operation.
22. Before leaving the operators position:
  - (a) Disengage the cutting blades
  - (b) Apply the parking brake
  - (c) Stop the engine and remove the starter key
23. Disengage the drive to the cutting blades and stop the engine:
  - (a) Before refuelling
  - (b) Before removing grass catcher or any attachment
  - (c) Before making a height adjustment unless adjustment is being made from the operators position
  - (d) Before clearing blockages
  - (e) Before inspecting, cleaning or working on the mower
  - (f) After striking a foreign object (inspect the mower for damage and make necessary repairs before restarting and operating the machine)
  - (g) If the machine starts to vibrate abnormally (check immediately)
24. Disengage drive to the cutting blades when not in use or in transporting
25. Do not over-speed the engine or alter governor settings. Excessive speed is dangerous and shortens the mowers life.
26. Use care when pulling loads or using attachments
  - (a) Use only the approved drawbar hitch point
  - (b) Limit loads to those you can safely control
  - (c) Do not turn sharply. Use care when backing up
27. Store the mower in a well ventilated room away from naked flames such as may be found in some hot water heaters.
28. Do not lend or sell the mower without the owners manual.
29. **Warning** – Remove spark plug lead to avoid accidental starting before attempting any maintenance or inspection of the mower.

# Operating Instructions

## BEFORE STARTING

### Fuel

Top with clean regular **Unleaded** petrol only. **Don't Over Fill.** Don't fill above high level mark. Make sure the petrol is free from impurities, particularly water. The petrol tank is located inside the engine compartment of your Greenfield. Raise the bonnet for access. Before removing the filler cap from the fuel tank to refuel the machine, wipe or brush the area clean around the cap to prevent any dirt or debris accidentally falling into the tank when the cap is removed. Do not use stale petrol in your mower, add clean fresh fuel only.

### Engine Oil

Check oil level by positioning the mower on level ground. Wipe or brush the area clean around the oil fill/dipstick cap, remove the dipstick and wipe clean, replace the dipstick screwing correctly into position. Remove again and sight the oil level. Fill to the full mark. Do not overfill. Dipstick must be firmly in place when the engine is running. Refer to the "CRANKCASE LUBRICATION" in the maintenance section of this manual for oil recommendations.

### Tyres

Inflate to the correct pressures. 20 to 22 psi (140 to 154 KPa) in the front and 12 to 15 psi (84 to 105 KPa) in the back tyres. Do not over inflate. Over inflation will permanently change the shape of the tyre adversely affecting the cutter deck Trim & Tilt.

## TO START

Apply park brake, disengage blade clutch (Cutters Out). Turn on fuel tap (if fitted). For cold starting, the choke will need to be activated. On single cylinder models, move the throttle control lever up and into the **CHOKE** position. On twin cylinder models fitted with a separate choke control, move the throttle control to **FAST** position and pull out and hold the choke control in the **CHOKE** position. Turn starter key to start position for ten (10) seconds maximum, to avoid overheating of starter motor. If engine does not start it may be flooded. Set throttle control half way then attempt to start again. Make sure to return the key to the **RUN** position after the engine starts or each time you attempt to start it.

Do not allow children or any person unfamiliar with the safe operating procedure to use this mower. Know your controls. Read the following instructions carefully. Learn how to stop the mower and the engine quickly in an emergency.

Important - This Evolution Model Greenfield mower is fitted with a safety "cut-out" switch activated by the seat. The operator must be seated to start the engine and remain seated while operating the mower. If you don't remain seated the engine will stop. This safety switch must be kept functional for your protection. Adjustment is easily done if ever necessary.

## TO STOP

In an emergency situation, turn key to "STOP" position.

For a normal stop, reduce engine speed to idle on the throttle control, disengage cutter blades (cutters out). Apply the park brake and allow engine temperature to even out by idling approximately 20 seconds.

For twin cylinder engines, turn key to stop position.

For single cylinder engines, move throttle to fast position then turn key to stop position.

Then, and only then, dismount from the drivers seat.

Remove key and store out of the reach of children. This will also ensure that the hour meter will not continue to run on and power to the electric fuel solenoid valve on the carburettor is shut off.

## TO OPERATE

A simple pivoted foot pedal controls forward, neutral and reverse. Apply toe pressure to move forward, heel pressure to move in reverse, increased toe or heel pressure provides speed variation in forward or reverse respectively. Allow pedal to centralise for neutral. The drive pedal can also be used as a brake by applying toe or heel pressure opposite to the directional movement of the mower. Sudden or violent directional changes and/or wheel spinning must be avoided.

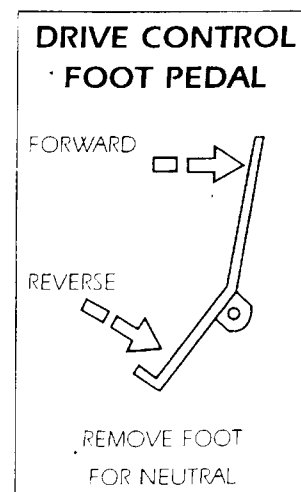

## Cutting Height

The height adjustment lever located to the front right of the rear cover enables the operator to select the desired cutting height. To alter the cutting height, move the lever to the right then shift upward or downward to select the setting then release to lock in position. An indicator panel displays the setting. Use the height settings in the green band, for maximum belt life.

## Blade Clutch

The blade clutch lever is located on the cutter deck alongside the right hand side running board. To engage the cutter blades, push the lever down out of the latch then slowly rearwards to end of travel while allowing the lever to rise up into the locked "ENGAGED" position. To disengage the cutter blades, push the lever down out of the latch and allow the lever to travel fully forward and up into the locked "OUT" position.

**NEVER USE WITHOUT SAFETY DEFLECTOR OR GRASS CATCHER FITTED.**

**DANGER:** Never attempt to dismount from the driver's seat while engine is running.

## Seat

The operator's seat is adjustable front to rear. To adjust, hinge seat forward, loosen seat securing bolts and move seat to position required and retighten bolts. Oil pivots occasionally.

## Disc Brake

The park brake handle is located in front of the left side rear mudguard. This handle has two positions, "OFF" and "ON". To engage the park brake, lift the handle fully up and engage the handle into the parking latch. To disengage, lift the handle up and out of the parking latch and lower to the "OFF" position. This brake can also be used for stopping the mower in an emergency. **DO NOT DRIVE THE MOWER WITH THE BRAKE IN THE "ON" POSITION.**

Should the parking brake need adjusting, refer to "BRAKE PAD WEAR ADJUSTMENT" on page 15 of this manual.

## MOWING ON SLOPES

Exercise extreme caution when operating a ride-on mower on a slope. Slopes are a major cause of tip-over and loss of control accidents involving ride-on mowers. Severe injury or death can occur.

On any slope the differential action must be locked out for best traction.

Speed should be reduced on slopes, particularly when changing direction.

Do not stop or start on slopes unless entirely necessary or make sudden speed or directional changes.

Never operate a ride-on mower on any slope if it is wet.

A ride-on mower should only be operated up and down slopes, not across.

Before operating on a slope remove all loose matter, branches, rocks etc. and stay clear of holes, erosion and tree roots etc. Such hazards can cause unexpected and instantaneous stability changes.

If a totally safe mowing procedure cannot be planned before entering a sloping area, then an alternative method of cutting this area, which does not risk the safety of the operator, should be used.

**NEVER** tow or use any optional attachment on ANY slope.

Don't mow close to steep drop offs.



Never mow up hill or down hill  
on slopes which exceed 10 degrees.

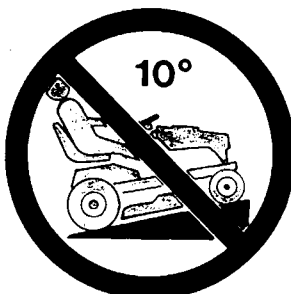

Never mow across the face of a  
slope which exceeds 5 degrees.

If the operator of a ride-on mower is not absolutely certain a slope does not exceed the previous recommendations, the area should not be entered until such time a properly qualified person has assessed and reported on the safety of the area.

# Greenfield Differential

## Instructions and Hints

The Greenfield Evolution mower features a unique and patented new type of differential. This differential offers the operator the option of the full differential action of the rear wheels for improved steering and a tight turning circle, whilst eliminating rear wheel scuffing on fine lawns. Most people will run their Greenfield with the differential operating all the time. This is the preferred method of operation and is accomplished by keeping the handle hooked over the end of the rear axle (see "A" below).

**Important: Do not attempt to engage or disengage the differential lock from the operator's seat or while the engine is running.**

In some situations, such as extremely wet areas, uneven, slippery surfaces or when working on hills you must lock out the differential action i.e. "Both rear wheels driving" for improved traction. This procedure is also recommended when using the dozer blade attachment or towing a trailer. You accomplish this by simply releasing the handle from the end of the rear axle. The lock will automatically engage when released (see "B" below).

To return the differential to the operating position (see "A" below) turn the steering wheel either to the left or right; then rock the mower back and forth while simultaneously pulling out on the engagement handle and hook it over the end of the rear axle. Lubricate if necessary.

If the left side rear wheel is removed, make sure the keyed engagement block slides freely into the engagement plate square before the final tightening of the wheel nuts.

Greenfield differentials are fully lubricated and sealed for life at the factory. If the unlikely event that your differential needs service, it must be returned to Greenfield intact. Differentials that have been tampered with or dismantled will NOT be considered for warranty. Normal warranty is 12 months for private use and 3 months for commercial use. Extended warranty is available for up to 3 years for private use. See your Greenfield dealer for details. During the warranty period, service and spares for the differential are only available through the factory. The factory gives a same day service if a differential is returned.

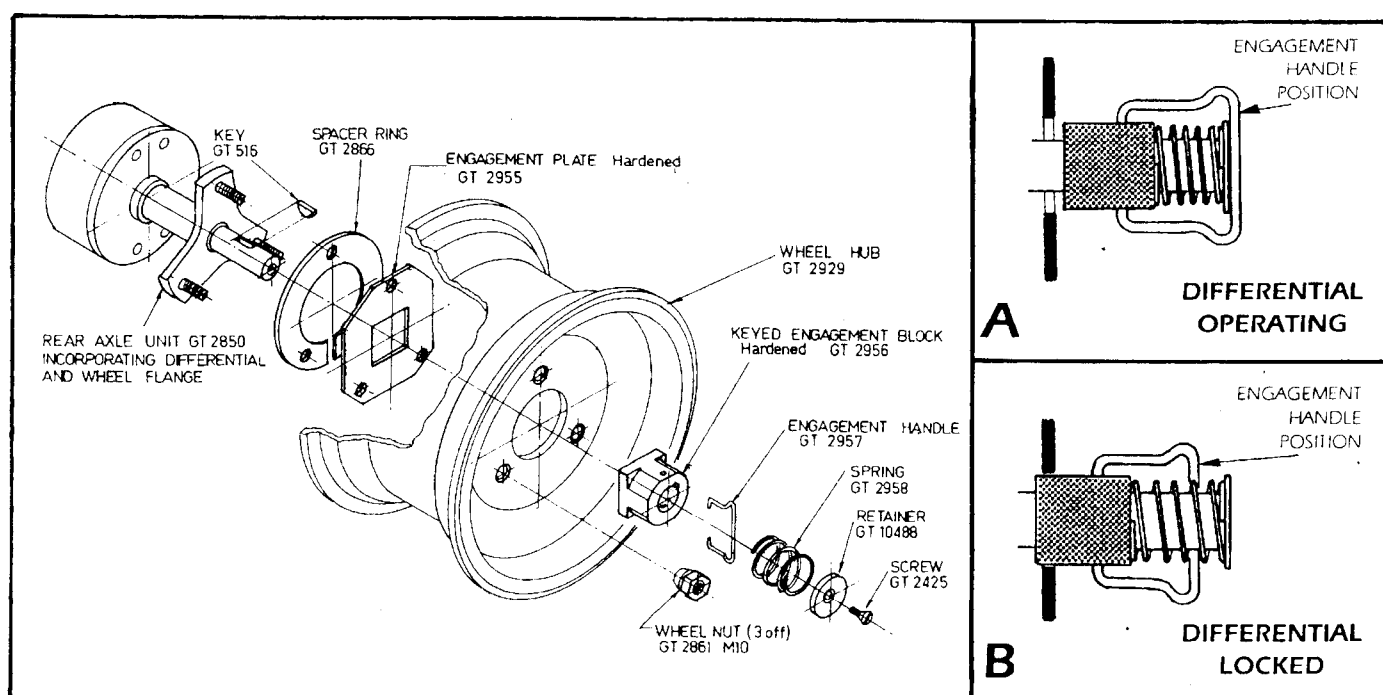

# Maintenance

**Warning:** Remove the spark plug lead to avoid accidental starting **BEFORE** attempting any maintenance or inspection of the mower.

## Crankcase Lubrication

Change engine oil after the first 5 hours of operation then every 6 months or 25 working hours, whichever comes first. Change more often in heavy work or dusty conditions. Drain engine oil whilst engine is warm then replace with a high quality detergent oil classified for service SF/SG by the A.P.I. such as Briggs & Stratton "Warranty Certified" SAE 30 oil, available from Briggs & Stratton Service Dealers.

Fill to full mark indicated on the dipstick. Do not overfill. To check oil level, position the mower on level ground. Wipe or brush the area clean around the oil fill/dipstick cap, remove the dipstick and wipe clean. Replace dipstick screwing correctly into position. Remove again and sight the oil level. The dipstick must be firmly in place when the engine is running. Refer to the engine manufacturers operating booklet for oil recommendations.

## Air Filter

Service the air filter as per the engine manufacturers booklet. Clean or replace more often in dusty conditions. Never operate the engine without the air filter correctly and securely fitted – rapid and expensive wear will occur.

## Cooling System

Remove the blower housing and clean out the grass and debris to prevent engine overheating. Refer to engine manufacturer's booklet.

## Battery

To maintain the correct fluid level in the battery, top with distilled water only, to the high level shown on the battery.

**NOTE:** If the mower is not used for at least 5 hours a month the battery will discharge and could sustain permanent damage. Do not allow the battery to discharge. Regularly trickle charge with a current not exceeding 3 amps per hour to prolong battery life. Keep the outside of the battery, especially the terminals clean and dry and check the battery is held securely.

The maintenance of the battery is the customers responsibility and only faulty batteries are covered by warranty. Neglect is not covered.

## Dry Battery:

When initially charging a new DRY battery, each cell must be filled to the high level with an electrolyte (dilute sulphuric acid) with a specific gravity of 1.26 at 20°C to 30°C. The battery must then be allowed to stand for 30 minutes before charging at a rate not exceeding 5 amps for 3 hours.

**WARNING:** Persons not trained in the proper procedure to transfer fluids containing acid or do not have the necessary safety equipment on hand in case of a spill or exposure, should not attempt this procedure. Contact the battery manufacturers local agent or an authorised Greenfield dealer.

## Wheels

The rear wheel nuts should be re-tensioned after the first 5 hours of operation to 44Nm (33ft lbs) on the 34 model and 100Nm (74ft lbs) on the 32 model then regularly with your preventative maintenance checks. Before re-tensioning the L.H. rear nuts on the 34 model make sure the keyed engagement block slides freely into the engagement plate.

## Tyres

Inflate to the correct pressures 20 to 22 psi (140 to 154 kPa) in the front and 12 to 15 psi (84 to 105 kPa) in the rear. Do not over inflate. Over inflation will permanently change the shape of the tyre. Over or under inflation will also adversely affect the cutter deck trim and tilt.

## Cutter Deck

Regularly check the condition of the cutter blades and blade bolts, cutter V belt and pulleys. Refer to pages 9 to 19 for fitting instructions.

## Cleaning

Never wash your Greenfield with a high pressure wash gun. Water and dirt could be blasted past the seals in the bearings causing premature bearing failures and rusted pivot points.

- Never wash your Greenfield immediately after use. The quenching contraction effect from hosing off the machine when it's at operating temperature could also draw water and dirt into the bearings and cause premature bearing failures.
- The best way to clean your Greenfield is to use an air hose to blow the loose grass, etc. from around pulleys, belts and the top of the cutter deck. Wash the exterior with a sponge and bucket, then rinse off with a hose and wipe it down the same as you would your car. For maximum machine life, do not spray water on the pulleys and bearings. Recoil all pivots after wash.
- Allow your Greenfield to cool after use then clean off all grass and other debris before storing. Sticks, stones or an accumulation of grass and other debris will damage belts and fracture pulleys if they go through between the pulley and belt. When operating in these conditions the cutter deck may require more frequent cleaning.

## Chassis Lubrication

Your Evolution 2000 Greenfield mower has 3 greasing points. A grease nipple is fitted to each king pin housing in the front axle beam, the third grease nipple is fitted to the steering link idler which is located in the centre of the machine close behind the front axle beam and accessible from under the chassis. Grease these locations every 6 months or 50 operating hours with a quality No. 2 lithium base grease or equivalent. It is recommended your grease gun be fitted with a flexible hose. All other exposed pivoting joints, lever points and slides are to be lubricated with engine oil.

# Blades and Belts

## Belts

Greenfield "V" belts are self adjusting although the cutter belt may need occasional manual adjustment within its working lifetime (see page 11). Inspect the "V" belts regularly and replace if damaged. Part Number for "V" belts are:

Drive V Belts GT 20005

Cutter V Belt GT 18005

**Important – For long service life, use only Genuine Greenfield branded V belts, refuse substitutes. Non Genuine V Belts may render the clutch ineffective, even dangerous.**

## Blades

Check condition of blades, blade bolts and blade holder. Replace if damaged or worn. Worn or damaged blades and bolts are major hazards. Always replace worn or damaged blades and bolts in sets to preserve balance. Use only Genuine Greenfield branded replacement parts. Use of inferior non-genuine replacement parts on your Greenfield could result in costly damage or even personal injury.

Part Numbers for Cutter Blade and Bolt Set is GT 2139

To fit new blades refer to illustration A. Tighten the blade bolt nuts firmly. Correct torque is 44Nm (32ft.lbs). Blades must be free to move but not loose. Lightly oil the blade pivot point before fitting.

**Warning:** Always remove the spark plug lead to avoid accidental starting.

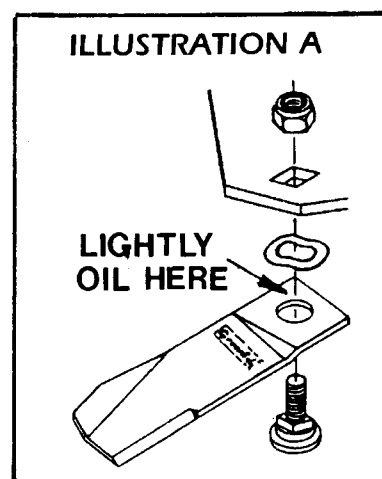

## Cutter Deck Adjustments

Before checking "TILT" which is the forward slant on the cutter deck front to rear or "Trim" which holds the cutter deck level side to side first check the tyres are inflated to the correct pressures, the front axle beam is level in the chassis, the rear axle is adjusted correctly, parallel in the chassis and the entire machine including all four wheels are on the same level flat surface.

1. Remove spark plug lead to prevent accidental starting.
2. Disengage blade clutch (Cutter Out).
3. Set the "Trim" by raising or lowering the right hand side of the cutter deck by means of the adjusting nut on the support chain.
4. Set the "Tilt" by loosening the tilt adjusting bolts which connect the bottom link to the cutter deck side plates on each side. Set the deck to the correct tilt (minimum 6mm lower at the front) then retighten both bolts. See illustration B.

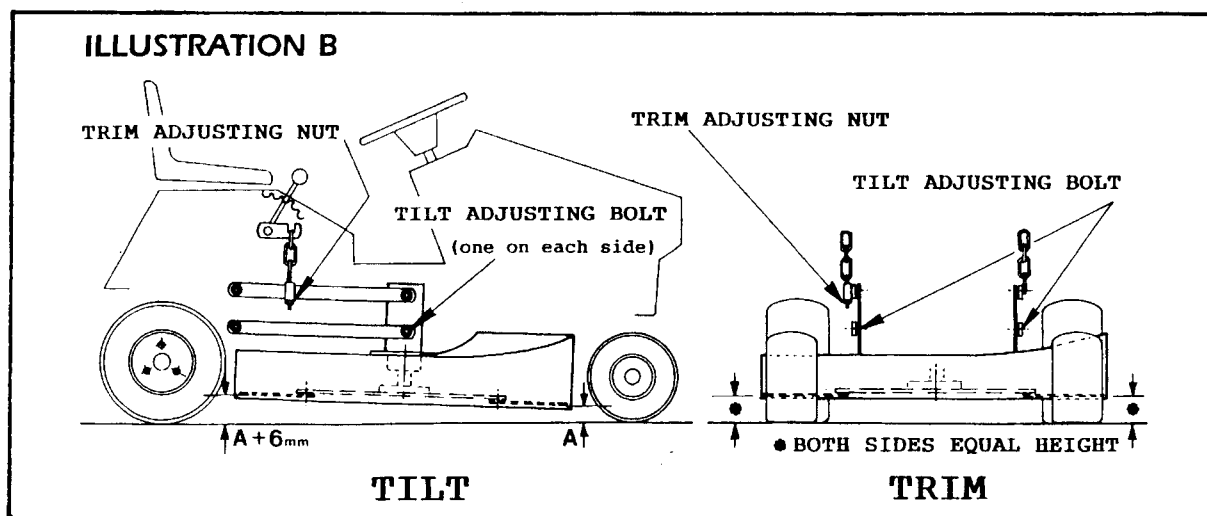

## TO REMOVE DRIVE "V" BELT

1. Remove the spark plug lead to prevent accidental starting.
2. Lift up the seat and disconnect the wire to the seat cut out switch by pulling apart the spade connector on the blue wire near the top of the battery. Remove the rear cover by undoing the star knob under the seat and removing the rear cover and seat assembly.
3. Set the blade height to the "LOW" position,
4. Swing back the steady bracket supporting the rear clutch link (refer illustration C).
5. Remove the spring clip from the back end of the clutch yoke. Lift off the rear clutch link and swing rearward (refer illustration D).
6. With the spring release hook tool provided (see illustration E), remove the tension spring from the idler pulley notch bar.
7. Release the notch bar leaf spring by inserting a flat screwdriver through the slot in the bracket above the leaf spring. Lever the leaf spring clear of the notch bar and hold in a released position allowing the idler pulley to slide freely rearward to permit belt removal. (Refer illustration E).
8. To remove the drive V belt from the engine pulley the cutter V belt must first be removed. Follow steps No 1, 2, 3 and 4 of "To remove cutter V belt" instructions. Now remove the drive V belt from the engine pulley.
9. Lift the drive V belt off both flat idler pulleys and remove the belt through the opening at the rear clutch link.

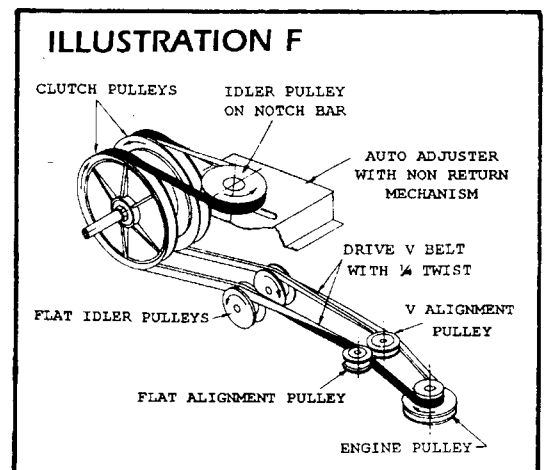
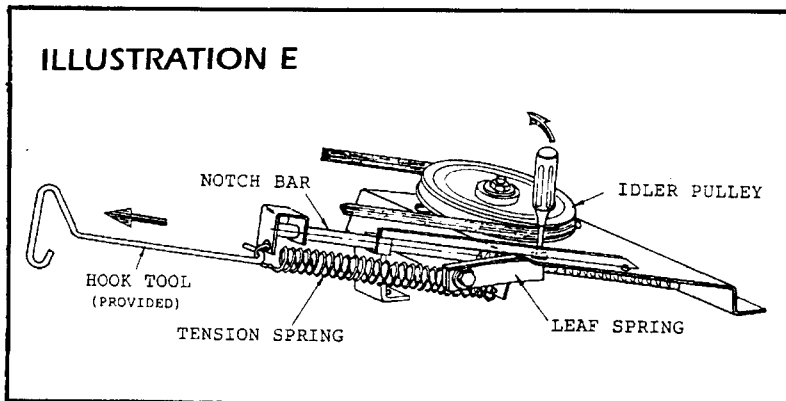
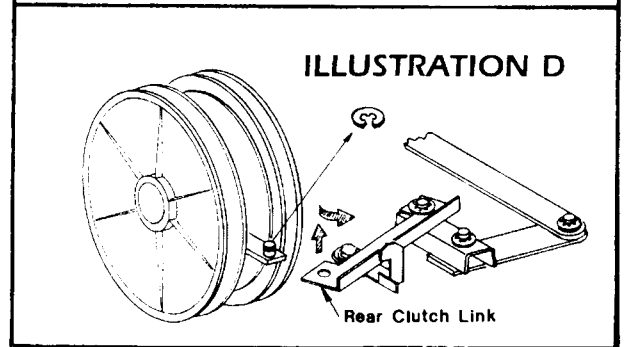
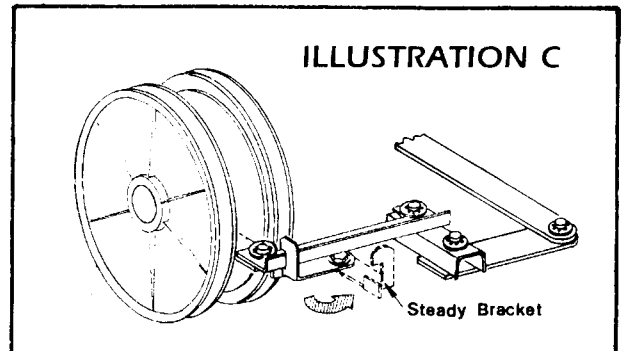

## TO REPLACE DRIVE V BELT

1. Feed the belt down the back of the clutch pulleys around the flat and "V" alignment pulleys and onto the top groove of the engine pulley. If the cutter V belt is in position on the engine pulley, remove the belt by following steps No 1, 2, 3 and 4 of "To remove cutter V belt" instructions.
2. Fit the belt into both clutch pulleys then into the idler pulley on the notch bar. This pulley will need to be in the fully rearward position. Lubricate the slide with grease.
3. Fit the belt over both flat idler pulleys. The back of the belt runs on the pulleys. See illustration F.
4. Replace the notch bar tension spring using the hook tool.
5. Replace the rear clutch link and the spring clip.
6. Swing the steady bracket forward to support the rear clutch link.
7. Refit the cutter V belt into the bottom groove of the engine pulley by following step No 7, 8 and 9 of "To replace cutter V belt" instructions.
8. Replace the rear cover and reconnect the wire to the seat safety cut out switch.
9. Replace the spark plug lead.

## To Remove Cutter V Belt

1. Remove the spark plug lead to prevent accidental starting.
2. Lower the blade height to the "LOW" position.
3. Disengage the cutters, blade clutch "OUT".
4. Remove the V belt from the engine pulley by manoeuvring the belt down between the pulley and the belt guide pins.
5. Remove the V belt from the fixed clutch pulley and the sliding clutch pulley by manoeuvring the belt between the pulleys and belt guides.
6. Remove the V belt from the cutter spindle pulley by manoeuvring the belt up between the pulley and the brake pad and the pulley and guide bolt. Remove V belt from the machine.

## To Replace Cutter V Belt

1. Remove the spark plug lead to prevent accidental starting.
2. Lower the blade height to the "LOW" position.
3. Disengage the cutters, blade clutch "OUT".
4. If a new unused cutter belt is to be fitted, the external belt adjuster lever must be in the forward position. See illustration I.
5. Fit the V belt to the cutter pulley by manoeuvring the belt down between the pulley and the brake pad and the pulley and guide bolt.
6. Fit the V belt to the fixed and sliding clutch pulleys by manoeuvring the belt between the guide pins and into the V pulleys.
7. Fit the V belt to the engine pulley by manoeuvring the belt up between the belt guides and into the bottom groove of the engine pulley. Refer to illustration showing cutter V belt run.
8. Engage and disengage cutter clutch lever several times to check smooth operation of the sliding pulley, cutter brake is working correctly and that the V belt is tensioned by the heavy compression spring when the clutch lever is in the "IN" position. With the lever in the "OUT" position there must be sufficient belt slack to allow the engine pulley to spin freely without moving the belt.
9. Replace the spark plug lead.
10. From the operator's seat run the engine and engage the cutters to check the V belt operation.

Note - A belt run-in period is required as follows. With the height adjusting lever in the green band (mid height position) engage cutter blades and run for a minimum of ten minutes at medium engine speed. Ideally, a total run-in time would be approximately one hour, during which time you can cut grass, on mid height position.

Refer also to "Cutter belt Adjustment".

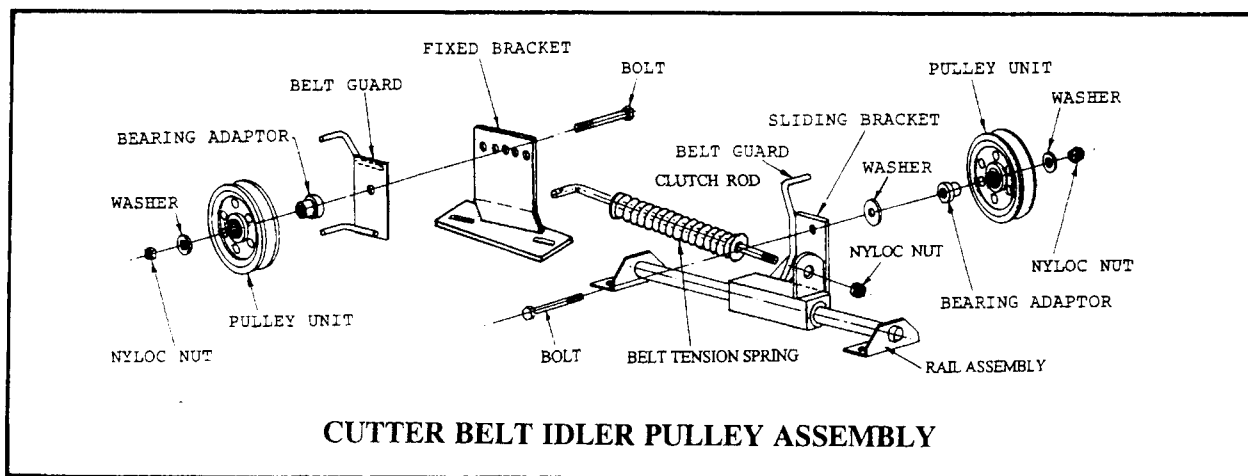

# Cutter Belt Adjustment

**Warning:** Remove the spark plug lead to avoid accidental starting **BEFORE** attempting any maintenance or inspection of the mower.

With the cutter clutch lever in the "OUT" position (disengaged) the cutter belt should be sufficiently disengaged to allow the cutter blades to come to a complete stop in approximately 7 seconds. The correct amount of belt slack and the efficient operation of the cutter brake control this stopping time. The spring loaded clutch idler pulley maintains the correct belt tension when the blade clutch lever is in the "Engaged" position.

The self adjusting cutter clutch will automatically adjust to compensate for normal wear and stretch of the V belt. However as most belt stretch occurs during the early operating hours of the new belt, the first adjustment should be checked after approximately 5 hours of operation with further checks at 6 months or 50 hour services.

Belt tension can easily be adjusted at either the external belt adjuster lever or the fixed idler pulley.

The external belt adjuster lever has two set positions. The forward position, the initial setting for new belts and the rear position which extends the belt tension spring movement to compensate for unusual belt stretch.

To move the lever between these two positions:

1. Disengage the cutters blade clutch "OUT"
2. Loosen clamp bolt
3. Move lever to other position
4. Re tighten clamp bolt

See illustration I

The fixed idler pulley has 5 bolt hole positions available plus a sliding adjustable base. To adjust belt using the fixed pulley bracket, disengage the cutters then loosen the two nyloc nuts on the pulley bracket base and slide the bracket rearward and retighten the nuts, or relocate the pulley to the next rearward hole.

The manufacturer recommends all Greenfields be returned to your authorised Greenfield dealer for normal servicing i.e. oil changes, air filters etc. at the times indicated in the maintenance section and by the engine manufacturer. The manufacturer also recommends a maintenance and safety inspection be performed every 6 months or every 50 working hours by your authorised Greenfield dealer to comply with the conditions for both standard and extended warranty offered by the manufacturer. Refer to warranty leaflet.

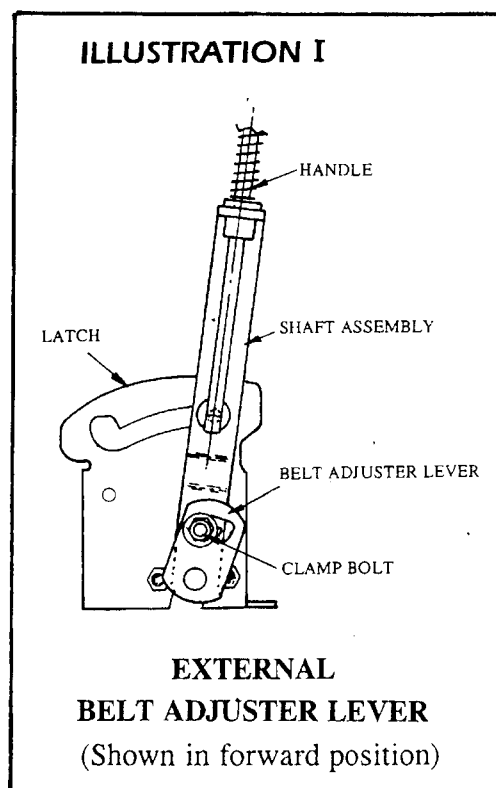
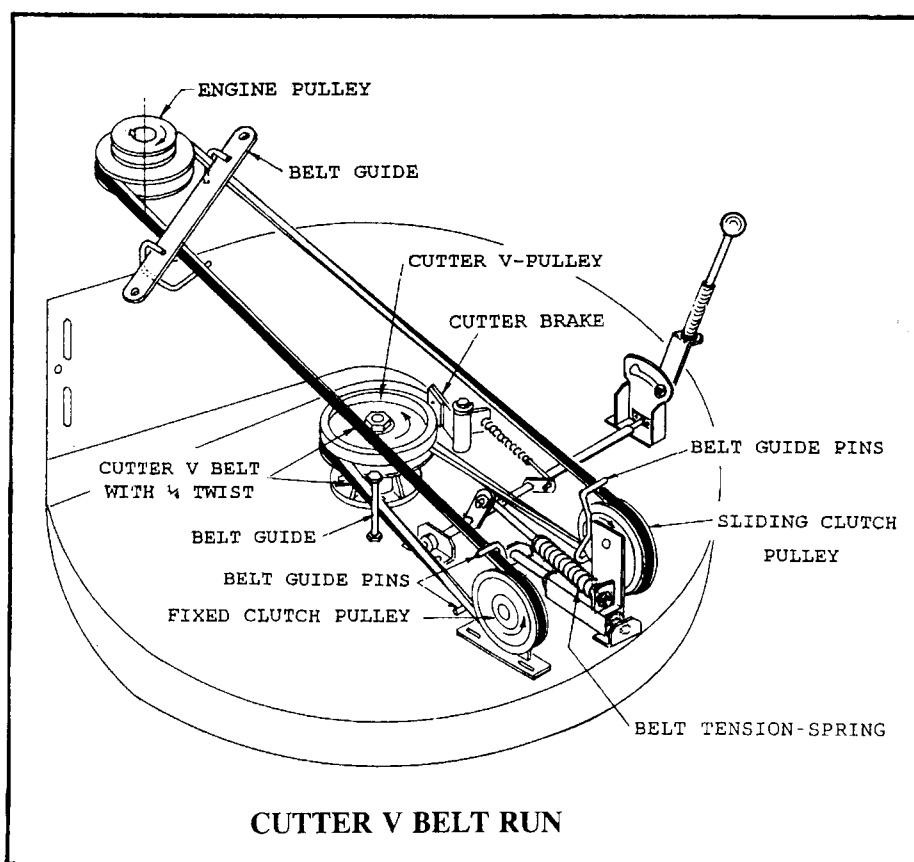

# Chain Adjustment

## Steering Chain Adjustment

1. Remove the spark plug lead to prevent accidental starting.
2. Lower the cutter deck to "LOW" position.
3. Working from under the bonnet at the rear of the engine from the right hand side, Loosen both nyloc nuts on the steering shaft flangette bearing plates and the nyloc nut on the locking tab. See illustration "G".
4. With fingers only, push the steering shaft to the left side of the machine to tighten the steering chain, remove all slackness from the chain. Do not overtighten.
5. Re-tension the two nuts on the bearing plate and the nut on the locking tab.
6. Replace the spark plug lead.

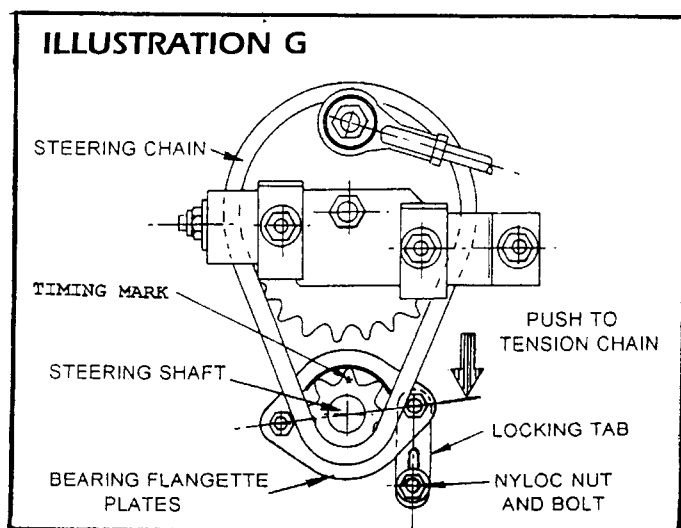

**STEERING CHAIN ADJUSTMENT**  
(Viewed from underside of machine)

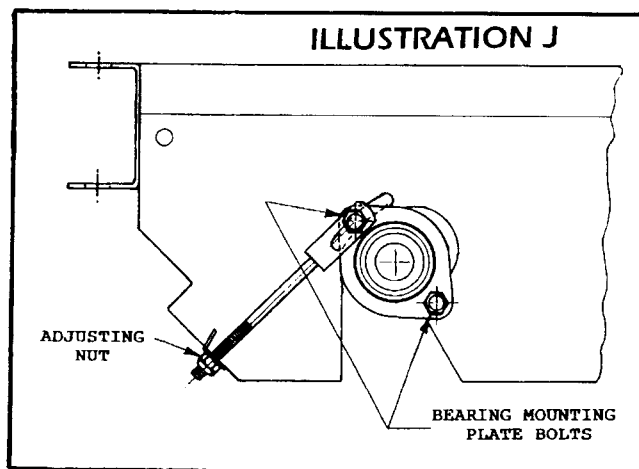
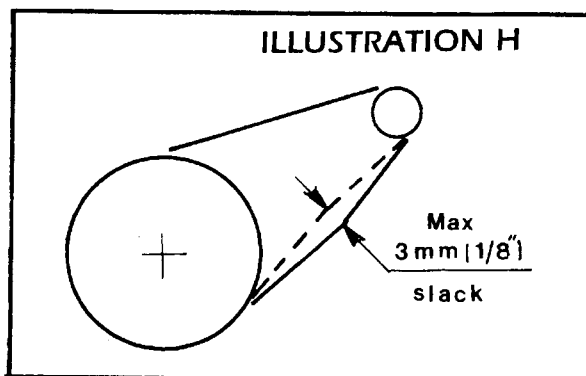

**REAR DRIVE CHAIN ADJUSTMENT**

## Rear Drive Chain Adjustment

1. Remove the spark plug lead to prevent accidental starting.
2. Lift up seat and disconnect the wire to the seat cut out switch by pulling apart the spade connector on the blue wire near the top of the battery. Remove the rear cover by undoing the star knob under the seat base and removing the rear cover and seat assembly.
3. Raise and block up the rear of the mower.
4. **Loosen the flangette mounting plates** on each side. See illustration "J". Although it is not necessary, the rear wheels may be removed for more access to the bearing mounting plate bolts.
5. Adjust the chain by turning the adjusting nuts positioned at the bottom of the rear axle side plates clockwise to tighten the chain. It is very important to adjust each side evenly so the rear axle remains parallel to the mower chassis and the sprockets are in alignment. It is suggested that you turn each nut no more than a quarter of a turn at a time alternating between the two until the chain has 3mm slack as shown in illustration "H". Do not overtighten the chain.
6. Re-tension the rear axle flangette bearing mounting plate bolts.
7. Re-fit and tension the rear wheels to 44 Nm (33 ft lbs). On the 34 model and 100 Nm (74 ft lbs) on the 32 model.
8. Replace rear cover, and reconnect the blue wire to the safety switch and replace the spark plug lead.

# Steering Stop Adjustment

The steering stops "B" are readily seen and accessible from under the right hand side of the chassis with the cutter deck in the "LOW" position. Adjustments should not be necessary, unless the steering has been damaged.

1. Remove the spark plug lead to prevent accidental starting.
2. Check the front wheel alignment has 0-1.5mm toe-in. Correct if necessary by resetting the adjustable tie rod. Also check that the steering wheel spokes are horizontal when the front wheels are facing straight ahead, adjust steering link if necessary. These adjustments must be completed before any steering stop adjustments are made.
3. Loosen the nuts retaining the two steering stops on the chain sprocket support (refer illustration K, item B).
4. Turn the steering wheel full lock to the right till the right hand king pin is hard against the fixed stop "A".
5. Slide the right side stop on the chain wheel support until it hits against the tie rod end "C". Retighten the locking nut "B".
6. Turn the steering wheel full lock to the left then repeat step 5 listed above.
7. To check your adjustments are correct, turn the steering wheel to either lock, noting stops "A" and "B" make contact at the same moment. This will ensure the smallest turning circle without unnecessary strain on the steering component.
8. Replace the spark plug lead.

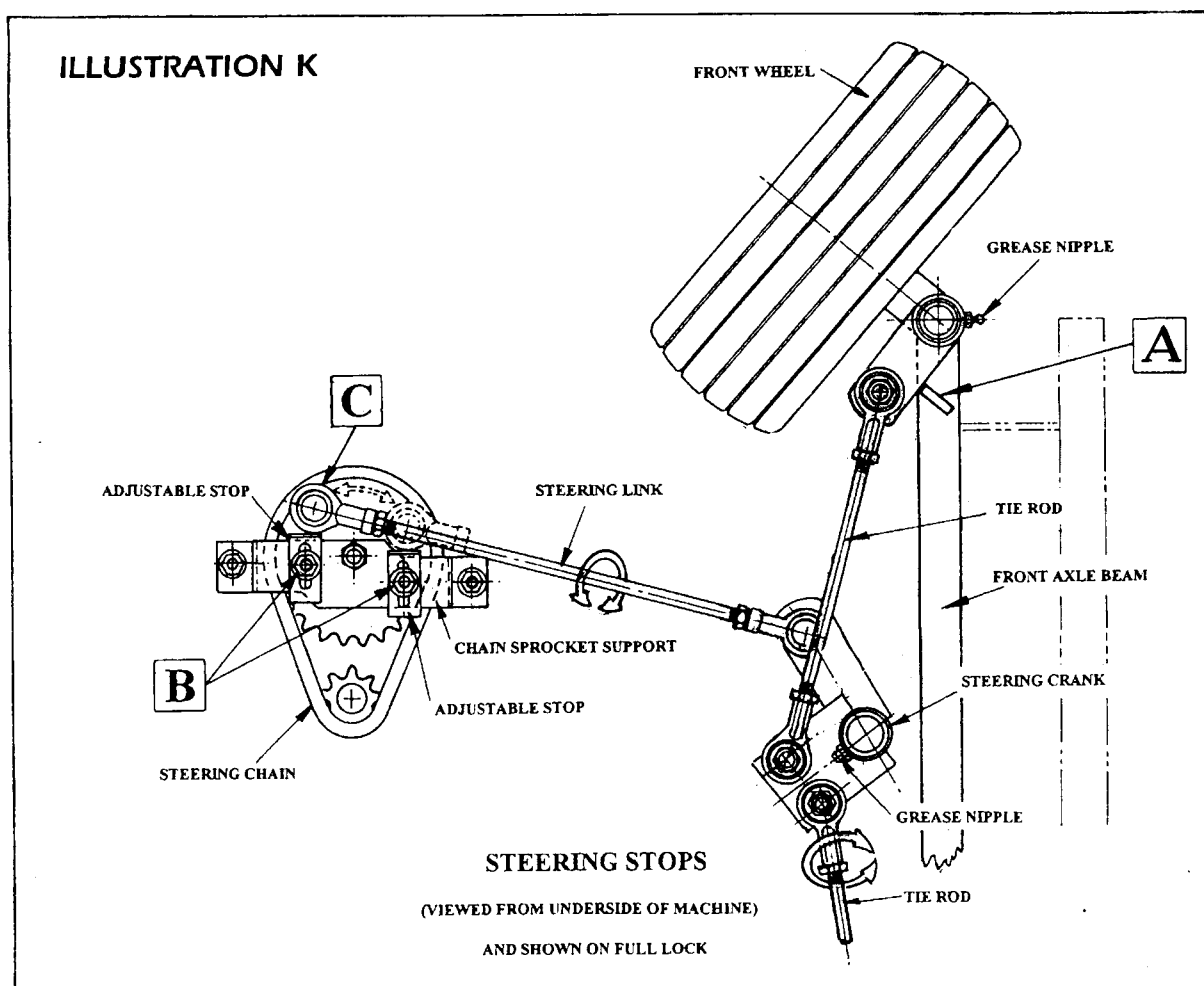

# Park Brake Adjustment

Check effectiveness of the parking brake by its ability to stop the tractor mower by applying the brake to the "IN" position while it is rolling forward with the foot pedal in the neutral position.

## Brake Pad Wear Adjustment

The adjusting screw is located on the brake arm and bears against the sliding brake pad. As the brake pads wear, the brake disc is free to slide along the axle against the fixed pad. This adjusting screw compensates for wear on both pads and at times will need to be adjusted as described below.

- A. Remove the spark plug lead to prevent accidental starting.
- B. Place the brake handle in the "OFF" position.
- C. Loosen the locknut and screw out the adjusting screw until both pads are just lightly touching the brake disc and not binding.
- D. Tighten locknut while holding adjusting screw stationary.
- E. Check that the brake disc rotates freely between the pads and replace the spark plug lead.

## Pad Replacement

- A. Remove the spark plug lead to prevent accidental starting.
- B. Remove the pad retainer.
- C. Remove both brake pads.
- D. Loosen the locknut on the adjusting screw and screw in the adjusting screw. The new pads will be thicker.
- E. Fit the two new brake pads.
- F. Refit the pad retainer.
- G. Re adjust the adjusting screw following steps "A" to "E" of "PARK BRAKE ADJUSTMENT". See illustration "L".
- H. Oil all pivots. **DO NOT OIL BRAKE PADS OR DISC.**

ILLUSTRATION L

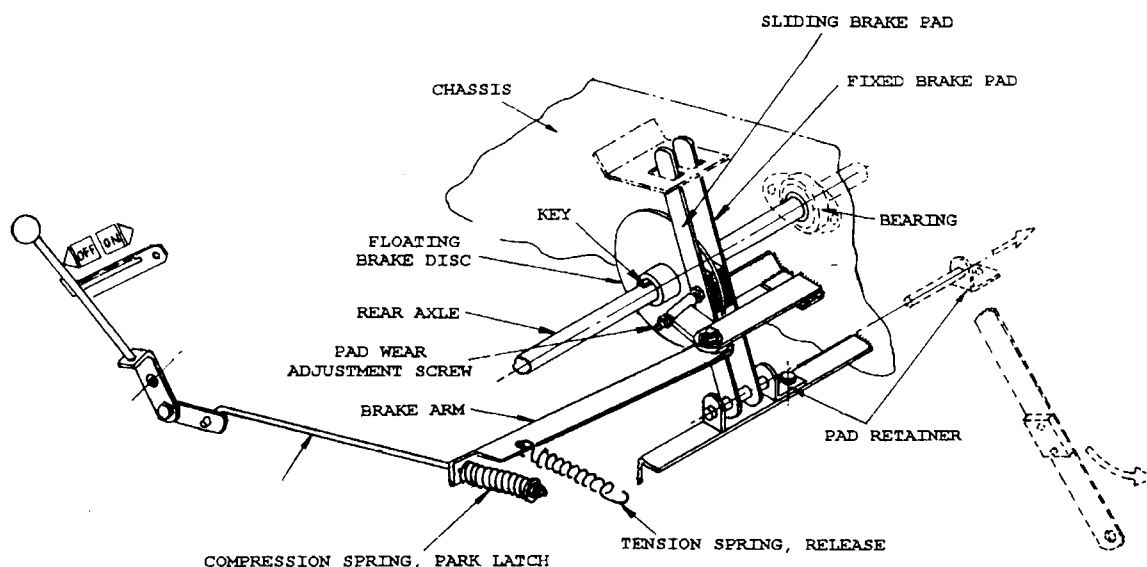

# Electrical Circuits

## V TWIN CYLINDER BRIGGS & STRATTON ENGINE

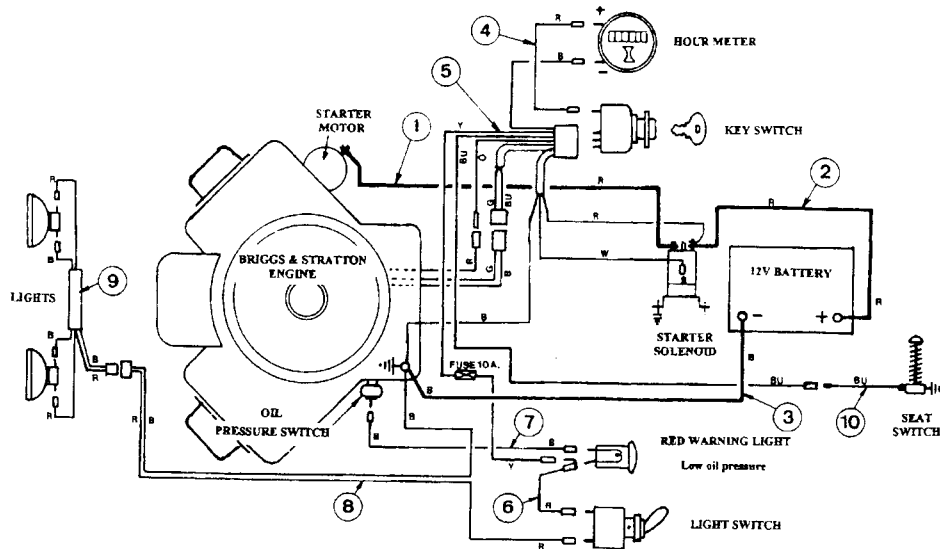

| INDEX | PART NO. | DESCRIPTION                            |
|-------|----------|--|
| 1.    | GT 6129  | Red Cable - Sol to Starter Motor       |
| 2.    | GT 14364 | Red Cable - Battery to Solenoid        |
| 3.    | GT 14370 | Black Cable - Battery to Engine Ground |
| 4.    | GT 20219 | Red Wire - Key Switch to Hour Meter    |
| 5.    | GT 20218 | Wiring Harness - Key Switch            |
| 6.    | GT 20216 | Red Wire - Warning Light               |
| 7.    | GT 20215 | Black Wire - Oil Switch                |
| 8.    | GT 20197 | Wire Harness - Light Switch            |
| 9.    | GT 20196 | Wire Harness - Head Lights             |
| 10.   | GT 12066 | Blue Wire - Seat Switch                |

### COLOUR LEGEND

B - Black  
 O - Orange  
 R - Red  
 W - White  
 Y - Yellow  
 G - Grey  
 BU - Blue

## SINGLE CYLINDER BRIGGS & STRATTON ENGINE

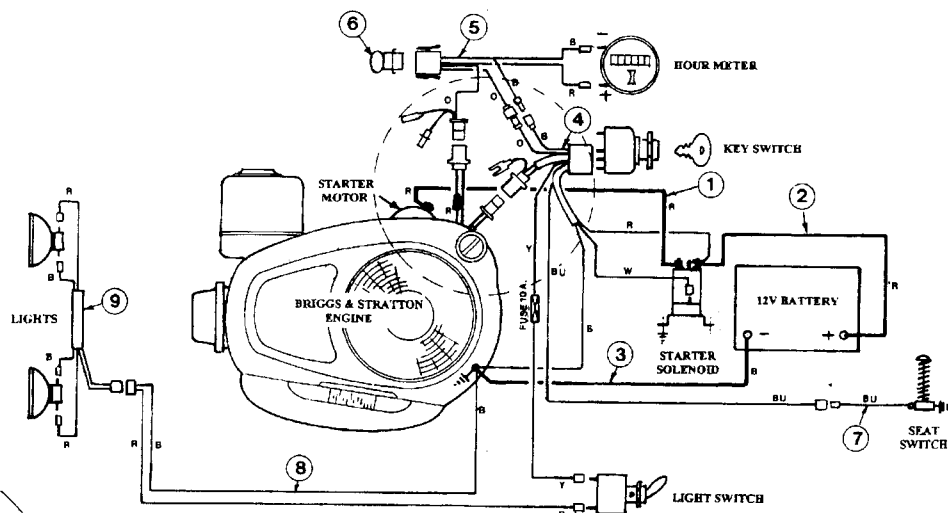

| INDEX | PART NO. | DESCRIPTION                            |
|-------|----------|--|
| 1.    | GT 6129  | Red Cable - Sol to Starter Motor       |
| 2.    | GT14364  | Red Cable - Battery to Solenoid        |
| 3.    | GT14370  | Black Cable - Battery to Engine Ground |
| 4.    | GT20198  | Wiring Harness - Key Switch            |
| 5.    | GT20240  | Wiring Harness - Charge, Hour Meter    |
| 6.    | GT20241  | Plug in Unit - Diode & Capacitor       |
| 7.    | GT12066  | Blue Wire - Seat Switch                |
| 8.    | GT20197  | Wire Harness - Light Switch            |
| 9.    | GT20196  | Wire Harness - Head Lights             |

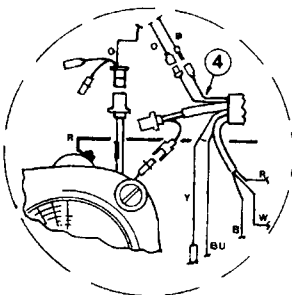

ALTERNATIVE CONNECTION

# Linkages

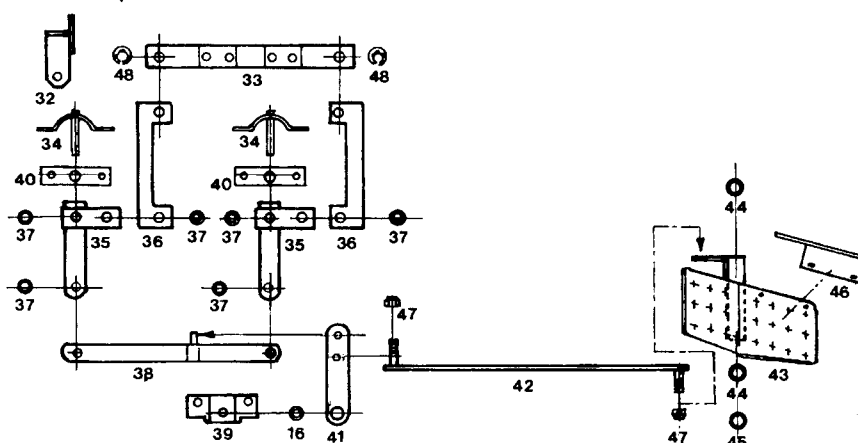

**DRIVE CLUTCH**

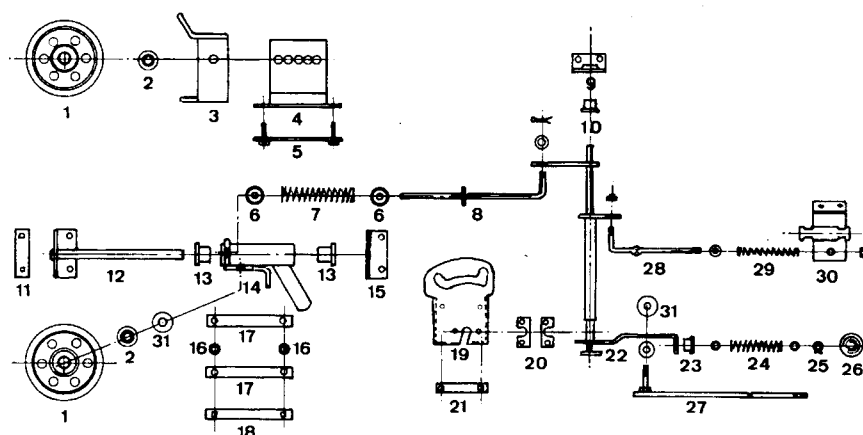

**CUTTER CLUTCH**

| INDEX | PART NO. | DESCRIPTION          |
|-------|----------|----------------------|
| 1     | GT 6901  | V Pulley & Bearing   |
| 2     | GT 6018  | Bearing Adaptor      |
| 3     | GT 20380 | L.H. Belt Guide      |
| 4     | GT 18855 | Fixed Pulley Bracket |
| 5     | GT 13280 | Retainer             |
| 6     | GT 585   | Cup Washer           |
| 7     | GT 14022 | Spring Compression   |
| 8     | GT 22325 | Clutch Rod           |
| 9     | GT 12305 | Bracket              |
| 10    | GD 5525  | Bush                 |
| 11    | GT 21158 | Retainer             |
| 12    | GT 22315 | Rail Assembly        |
| 13    | GT 1766  | Bush                 |
| 14    | GT 22345 | Sliding Bracket      |
| 15    | GT 13776 | Bracket              |
| 16    | GT 730   | Bush                 |
| 17    | GT 14318 | Bar                  |
| 18    | GT 21161 | Retainer             |
| 19    | GT 22165 | Latch                |
| 20    | GT 22166 | Bearing Plate        |
| 21    | GT 21159 | Retainer             |
| 22    | GT 22340 | Shaft Assembly       |
| 23    | GD 5526  | Bush                 |
| 24    | GT 22007 | Spring - Compression |

| INDEX | PART NO. | DESCRIPTION          |
|-------|----------|----------------------|
| 25    | GT 2010  | Circlip              |
| 26    | GT 1565  | Knob                 |
| 27    | GT 22330 | Handle               |
| 28    | GT 18303 | Rod - Cutter Brake   |
| 29    | GT 12032 | Spring - Compression |
| 30    | GT 19801 | Cutter Brake Unit    |
| 31    | GT 1025  | Washer               |
| 32    | GT 18860 | Steady - Clutch Yoke |
| 33    | GT 20945 | Yoke Unit            |
| 34    | GT 20395 | Pivot Pin Assembly   |
| 35    | GT 20405 | Pivot Arm Assembly   |
| 36    | GT 14309 | Clutch Link          |
| 37    | GT 2057  | Retainer             |
| 38    | GT 18785 | F - R Link           |
| 39    | GT 18337 | Pivot Bracket        |
| 40    | GT 22151 | Support              |
| 41    | GT 18318 | Link                 |
| 42    | GT 20390 | F - R Control        |
| 43    | GT 22305 | Foot Pedal           |
| 44    | GT 12394 | Bush                 |
| 45    | GT 580   | Retainer             |
| 46    | GT 22156 | Heat Shield          |
| 47    | GT 1484  | Nyloc Nut            |
| 48    | GT 2036  | Spring Clip          |

PARTS AND SPECIFICATIONS SUBJECT TO CHANGE WITHOUT NOTICE.  
STANDARD HARDWARE ITEMS NOT SHOWN.

# Linkages

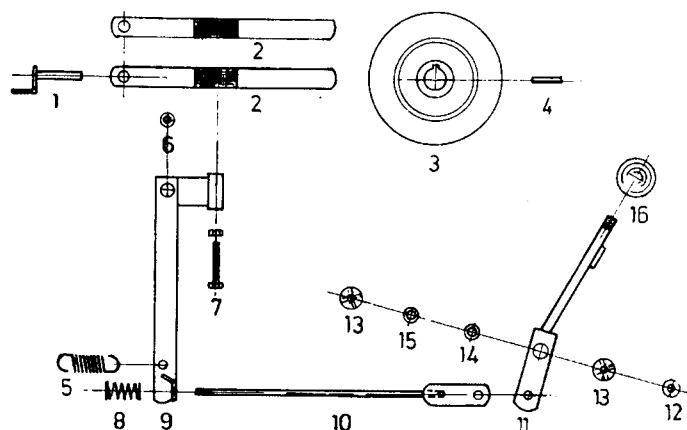

**PARK EMERGENCY BRAKE**

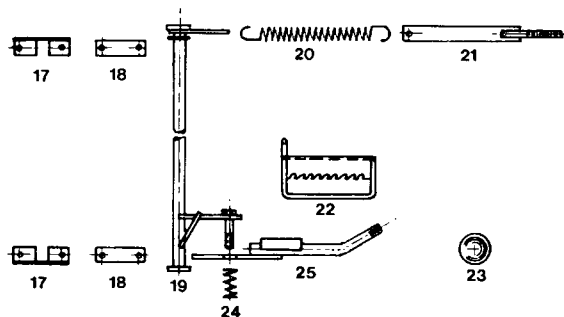

**CUTTER HEIGHT**

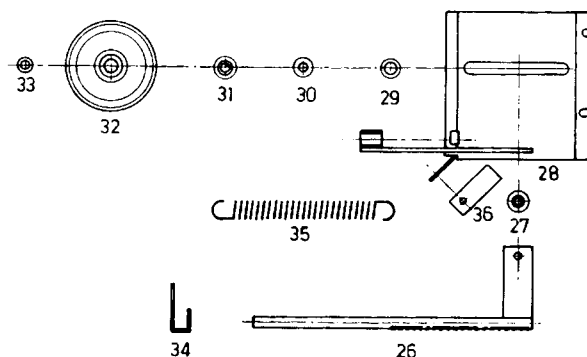

**NOTCH BAR**

| INDEX | PART NO. | DESCRIPTION          |
|-------|----------|----------------------|
| 1     | GT 15270 | Anchor - Brake Pad   |
| 2     | GT 19805 | Brake Pad Unit       |
| 3     | GT 18660 | Brake Disc           |
| 4     | GT 12093 | Key                  |
| 5     | GT 20009 | Spring - Tension     |
| 6     | GT 1851  | Pivot Bush           |
| 7     | GT 1023  | Adjusting Screw      |
| 8     | GT 18048 | Spring - Compression |
| 9     | GT 19005 | Brake Arm            |
| 10    | GT 18805 | Brake Rod            |
| 11    | GT 18980 | Brake Handle         |
| 12    | GT 1012  | Washer               |
| 13    | GT 579   | Wave Washer          |
| 14    | GT 730   | Pivot Bush           |
| 15    | GT 14341 | Shim Washer          |
| 16    | GT 1565  | Knob                 |
| 17    | GT 18313 | Pivot Bracket        |
| 18    | GT 18314 | Packer               |

| INDEX | PART NO. | DESCRIPTION           |
|-------|----------|-----------------------|
| 19    | GT 18820 | Height Adjuster Shaft |
| 20    | GT 20006 | Spring - Tension      |
| 21    | GT 18775 | Tensioner             |
| 22    | GT 21285 | Height Adjuster Rack  |
| 23    | GT 1565  | Knob                  |
| 24    | GT 7071  | Spring - Compression  |
| 25    | GT 18705 | Handle                |
| 26    | GT 18765 | Notch Bar             |
| 27    | GT 608   | Slide Bush            |
| 28    | GT 18760 | Bracket               |
| 29    | GT 23    | Washer                |
| 30    | GT 579   | Wave Washer           |
| 31    | GT 610   | Bearing Adaptor       |
| 32    | GT 7965  | V Pulley Complete     |
| 33    | GT 1012  | Washer                |
| 34    | GT 7308  | Anchor - Spring       |
| 35    | GT 20006 | Spring - Tension      |
| 36    | GT 14023 | Leaf Spring           |

PARTS AND SPECIFICATIONS SUBJECT TO CHANGE WITHOUT NOTICE.  
STANDARD HARDWARE ITEMS NOT SHOWN.

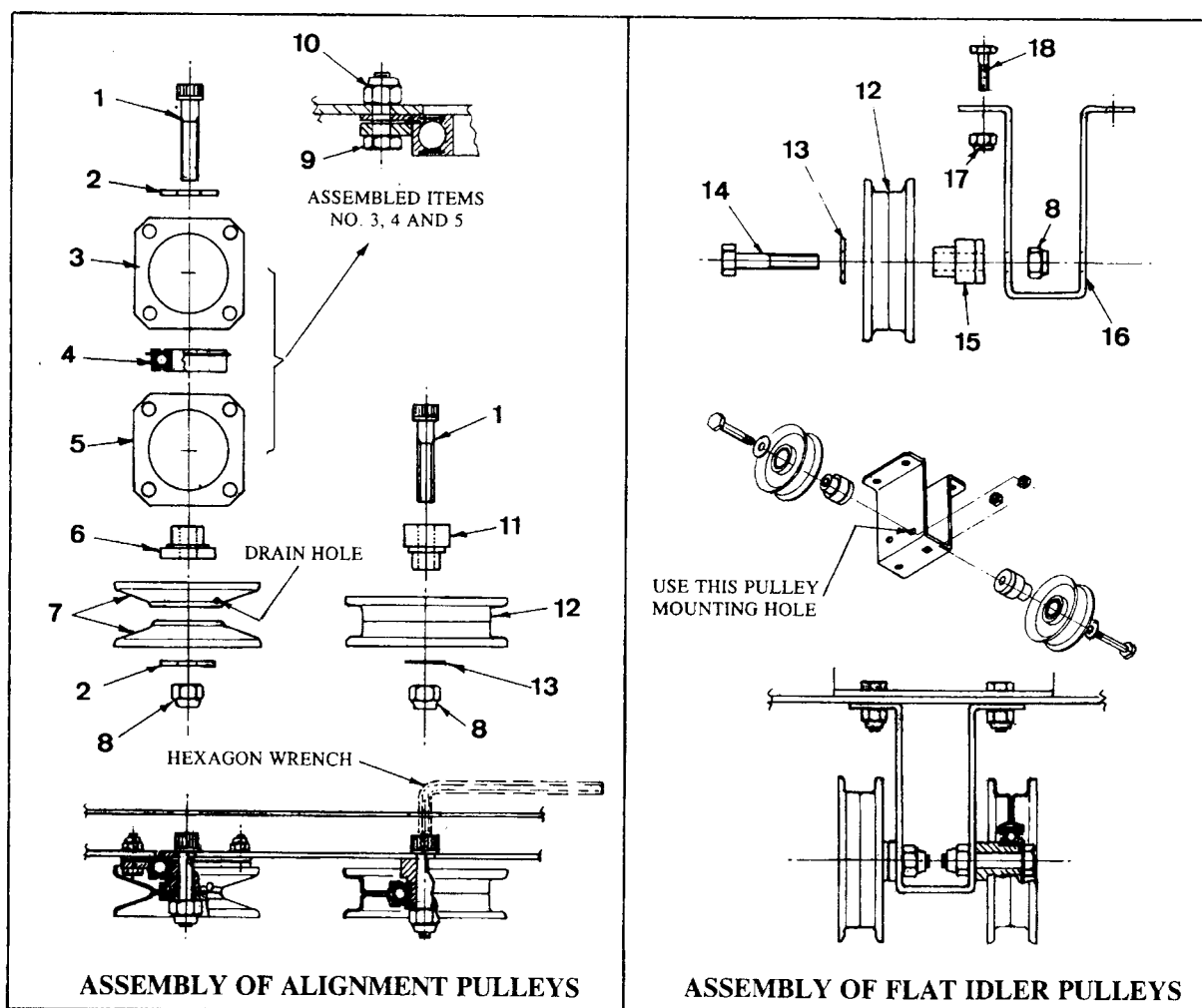

| INDEX | PART NO. | DESCRIPTION                 |
|-------|----------|-----------------------------|
| 1     | GT 2015  | High Tensile Cap Screw      |
| 2     | GT 16317 | Washer                      |
| 3     | GT 22152 | Spacer Plate Thin           |
| 4     | GT 2293  | Ball Bearing with Snap Ring |
| 5     | GT 22153 | Clamp Plate Thick           |
| 6     | GT 22001 | Bearing Adaptor - V Pulley  |
| 7     | GT 22154 | "V" Half Pulley             |
| 8     | GT 2466  | Nyloc Nut                   |
| 9     | GT 1052  | High Tensile Bolt           |

| INDEX | PART NO. | DESCRIPTION                   |
|-------|----------|-------------------------------|
| 10    | GT 97    | Nyloc Nut                     |
| 11    | GT 22002 | Bearing Adaptor - Flat Pulley |
| 12    | GT 1009  | Flat Idler Pulley Complete    |
| 13    | GT 1012  | Washer                        |
| 14    | GT 118   | Bolt                          |
| 15    | GT 18050 | Bearing Adaptor               |
| 16    | GT 18312 | Bracket                       |
| 17    | GT 1020  | Nyloc Nut                     |
| 18    | GT 1455  | Bolt                          |

PARTS & SPECIFICATIONS SUBJECT TO CHANGE WITHOUT NOTICE.

## TO REMOVE "V" ALIGNMENT OR FLAT PULLEYS

- Hold the H.T. cap screw firmly by using a 5/16" Hexagon wrench inserted down a hole in the step through floor area.
- Remove the nyloc nut and washer from the end of cap screw - remove the pulley.

## TO REMOVE THE "V" PULLEY BEARING

- First remove the pulley as described above.
- Remove the four (4) H.T. bolts and nyloc nuts securing the bearing, spacer and clamp plate.

## TO REPLACE "V" PULLEY

- Replace in reverse order as for removal - install bearing first.
- Install bearing, spacer and clamp plate taking care that the snap ring in the bearing is uppermost and the thick clamp plate is under the ring. See illustration. Tighten the four bolts firmly.
- Insert cap screw down through hole in floor making sure that washer item 2 is correctly positioned over top of bearing.
- Fit bearing adaptor, top and bottom pulley halves, ensuring the top pulley half has a water drain hole.
- Fit washer and nyloc nut and tighten firmly.

# Engine and Electrical

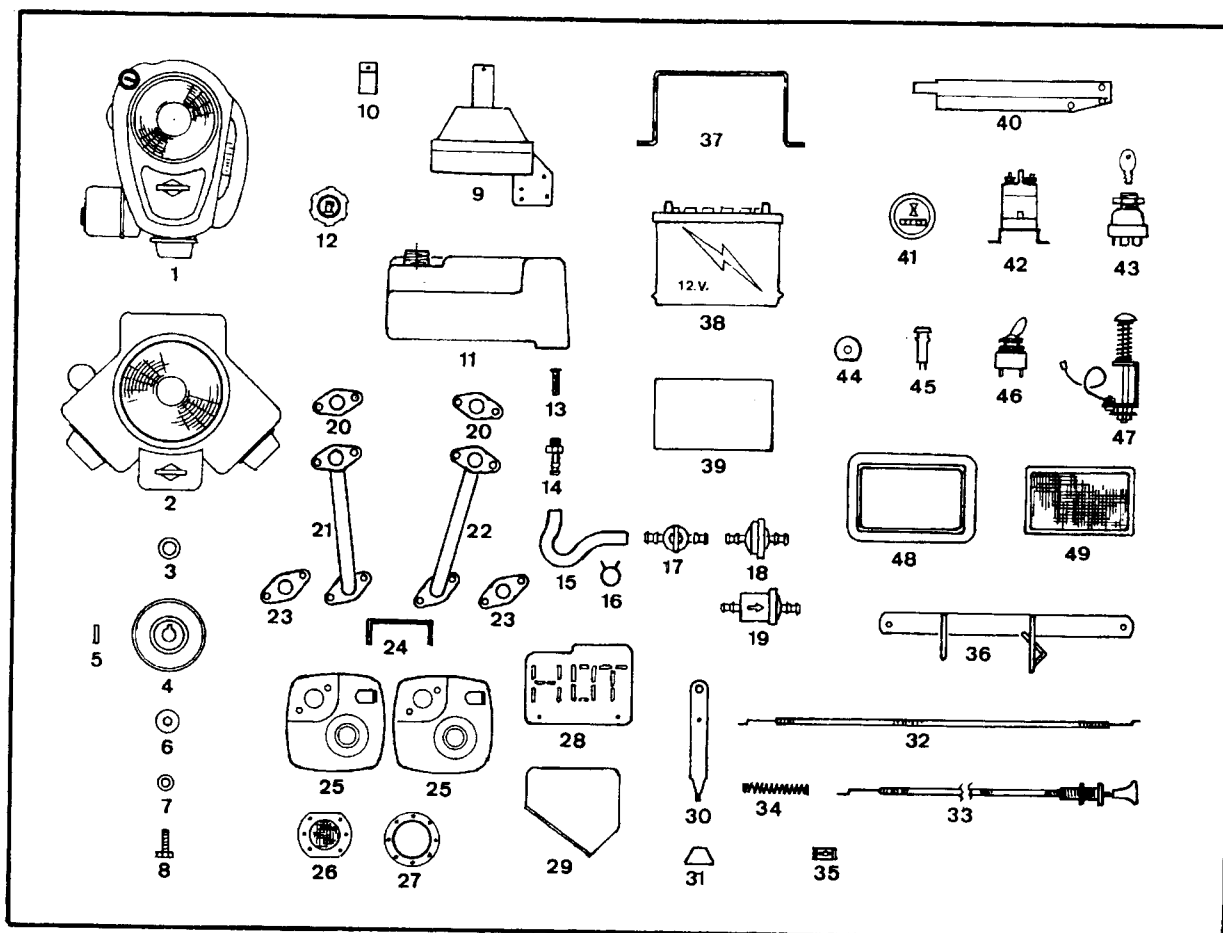

| INDEX | PART NO. | DESCRIPTION                            | INDEX | PART NO.  | DESCRIPTION                           |
|-------|----------|--|-------|-----------|---------------------------------------|
| 1     |          | 11.5 to 15.5 HP Single Cylinder Engine | 26    | GT 20067  | Spark Arrester                        |
| 2     |          | 18 to 25 HP Twin Cylinder Engine       | 27    | GT 20065R | Exhaust Outlet                        |
| 3     | GT 18047 | Spacer Crankshaft Single Cylinder      | 28    | GT 20213  | Heat Shield R.H. Exhaust Pipe         |
| 3     | GT 20058 | Spacer Crankshaft Twin Cylinder        | 29    | GT 22157  | Heat Shield L.H. Foot Rest            |
| 4     | GT 20003 | Pulley - Engine                        | 30    | GT 20169  | Throttle Lever                        |
| 5     | GT 14037 | Key                                    | 31    | GT 2026   | Knob - Throttle Lever                 |
| 6     | GT 3192  | Washer                                 | 32    | GT 20913  | Throttle Cable Single Cylinder        |
| 7     | GT 2511  | Cone Washer                            | 32    | GT 20957  | Throttle Cable Twin Cylinder          |
| 8     | GT 1069  | Bolt                                   | 33    | GT 20057  | Choke Control Cable When Fitted       |
| 9     | GT 20565 | Support - Fuel Tank                    | 34    | GT 20083  | Spring - Choke Return                 |
| 10    | GT 20179 | Clamp - Fuel Tank                      | 35    | GT 1252   | Cable Clamp                           |
| 11    | GT 2250  | Fuel Tank - Bare                       | 36    | GT 20280  | Belt Guide - Single Cyl Engine Pulley |
| 12    | GT 2249  | Cap - Fuel Tank                        | 36    | GT 20595  | Belt Guide - Twin Cyl Engine Pulley   |
| 13    | GT 20185 | Gauze Strainer                         | 37    | GT 21157  | Battery Clamp                         |
| 14    | GT 2252  | Hose Tail                              | 38    | GT 1914   | Battery                               |
| 15    | RM 907   | Fuel Hose x 1m Length                  | 39    | GT 14336  | Rubber Mat - Battery                  |
| 16    | GT 2221  | Hose Clamp                             | 40    | GT 20176  | Support - Electric Harness            |
| 17    | GT 2215  | Fuel Tap                               | 41    | GT 6084   | Hour Meter                            |
| 18    | GT 2309  | Fuel Filter Single Cylinder Engine     | 42    | GT 2220   | Solenoid - Starter Motor              |
| 19    | GT 2310  | Fuel Filter Twin Cylinder Engine       | 43    | GT 2219   | Off-On-Start - Key Switch             |
| 20    | GT 20068 | Gasket - Engine/Exhaust                | 44    | GT 12345  | Insulator Battery Positive Pole       |
| 21    | GT 20555 | Exhaust Pipe R.H. Side                 | 45    | GT 2275   | Oil Failure Light (Twin Cyl. only)    |
| 22    | GT 20560 | Exhaust Pipe L.H. Side                 | 46    | GT 2274   | Light Switch                          |
| 23    | GT 20063 | Gasket - Exhaust/Muffler               | 47    | GT 13831  | Seat Safety Switch Unit               |
| 24    | GT 22160 | Muffler Support Bracket                | 48    | GT 20056  | Rubber Head Light Surround            |
| 25    | GT 20061 | Muffler                                | 49    | GT 20055  | Head Light                            |

PARTS AND SPECIFICATIONS SUBJECT TO CHANGE WITHOUT NOTICE.  
STANDARD HARDWARE ITEMS ARE NOT SHOWN.

# Drive Clutch and Rear Axle

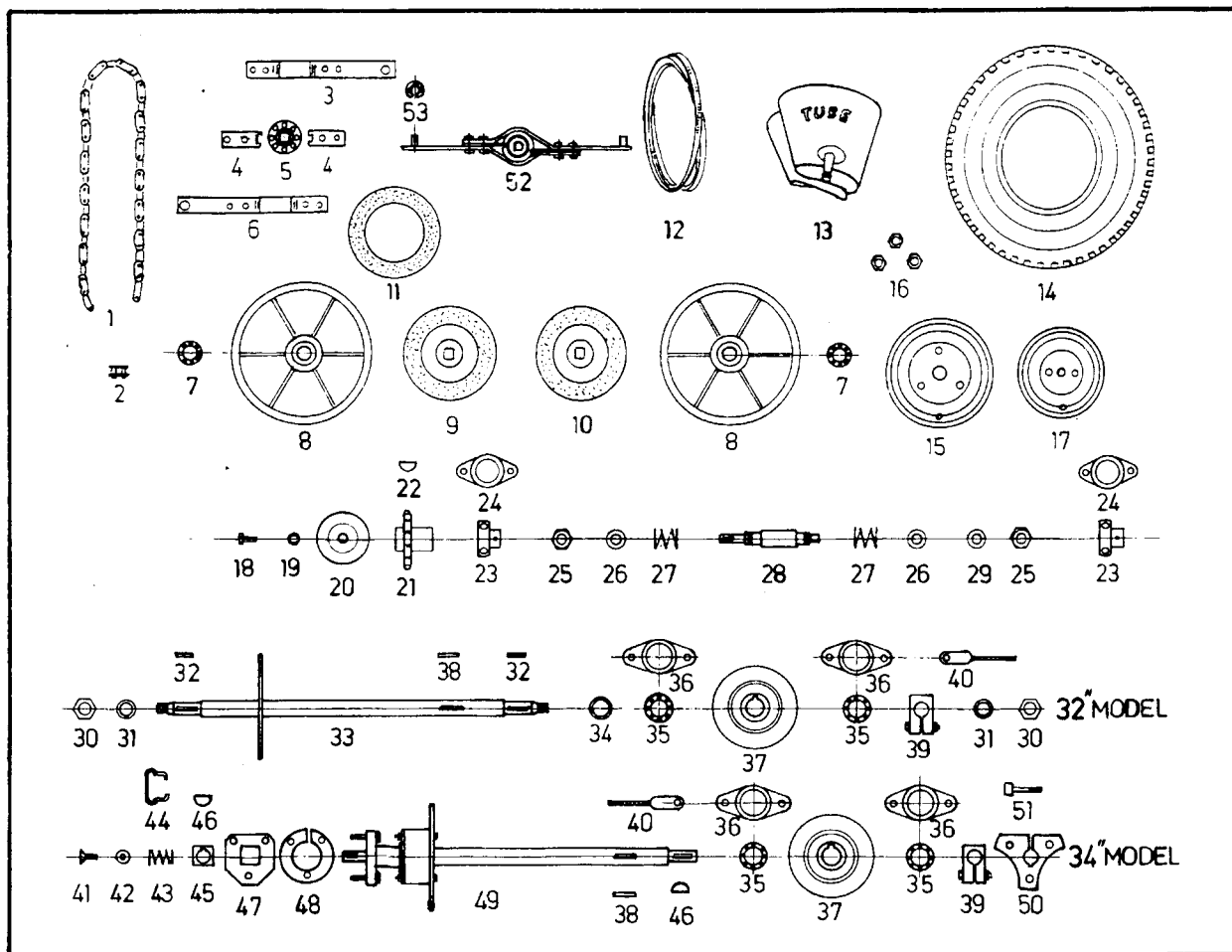

| INDEX | PART NO. | DESCRIPTION                  | INDEX | PART NO. | DESCRIPTION                            |
|-------|----------|------------------------------|-------|----------|--|
| 1     | GT 18006 | Roller Chain                 | 27    | GT 357   | Spring                                 |
| 2     | GT 501   | Collecting Link              | 28    | GT 18031 | Drive Shaft                            |
| 3     | GT 20510 | Yoke - Top Half              | 29    | GT 539   | Shim                                   |
| 4     | GT 20191 | Retainer                     | 30    | GT 2545  | Nyloc Nut                              |
| 5     | GT 20935 | Clutch Bearing Unit          | 31    | GT 1002  | Washer                                 |
| 6     | GT 20515 | Yoke - Bottom Half           | 32    | GT 4121  | Key                                    |
| 7     | GT 2296  | Ball Bearing - Clutch Pulley | 33    | GT 18040 | Rear Axle & Sprocket 32 Model          |
| 8     | GT 920   | Clutch Pulley Complete       | 34    | GT 18310 | Spacer                                 |
| 9     | GT 6855  | L.H. Drive Plate Complete    | 35    | GT 390   | Ball Bearing                           |
| 10    | GT 6855  | R.H. Drive Plate Complete    | 36    | GT 7083  | Bearing Plate                          |
| 11    | GT 6012  | Clutch Lining                | 37    | GT 18660 | Brake Disc                             |
| 12    | GT 20005 | V Belt - Drive               | 38    | GT 12093 | Key                                    |
| 13    | GT 10002 | Tube 32 Model                | 39    | GT 7032  | Clamp                                  |
| 13    | GT 1535  | Tube 34 Model                | 40    | GT 18865 | Chain Adjuster                         |
| 14    | GT 1001  | Tyre 32 Model                | 41    | GT 2425  | Screw                                  |
| 14    | GT1203   | Tyre 34 Model                | 42    | GT 10488 | Spring Retainer                        |
| 15    | GT 2624  | Wheel Hub 34 Model R.H.      | 43    | GT 2958  | Spring                                 |
| 15    | GT 2929  | Wheel Hub 34 Model L.H.      | 44    | GT 2957  | Handle                                 |
| 16    | GT 2861  | Wheel Nut 34 Model Only      | 45    | GT 2956  | Engagement Block                       |
| 17    | GT 2240  | Wheel Hub 32 Model           | 46    | GT 516   | Key                                    |
| 18    | GT 1455  | Set Screw                    | 47    | GT 2955  | Engagement Plate                       |
| 19    | GT 2542  | Cone Washer                  | 48    | GT 2866  | Spacer Ring                            |
| 20    | GT 18334 | Disc - Chain Guard 32 Model  | 49    | GT 2850  | Rear Axle & Differential Unit 34 Model |
| 21    | GT 12102 | 10 Tooth Sprocket            | 50    | GT 1625  | Wheel Flange                           |
| 22    | GT 517   | Key                          | 51    | GT 2517  | Bolt - High Tensile                    |
| 23    | GT 392   | Ball Bearing - Drive Shaft   | 52    | GT 20945 | Yoke Unit                              |
| 24    | GT 7017  | Bearing Plates               | 53    | GT 2036  | Spring Clip                            |
| 25    | GT 347   | Nut                          |       |          |  |
| 26    | GT 7303  | Washer                       |       |          |  |

PARTS AND SPECIFICATIONS SUBJECT TO CHANGE WITHOUT NOTICE.  
STANDARD HARDWARE ITEMS NOT SHOWN.

# Steering and Front Axle

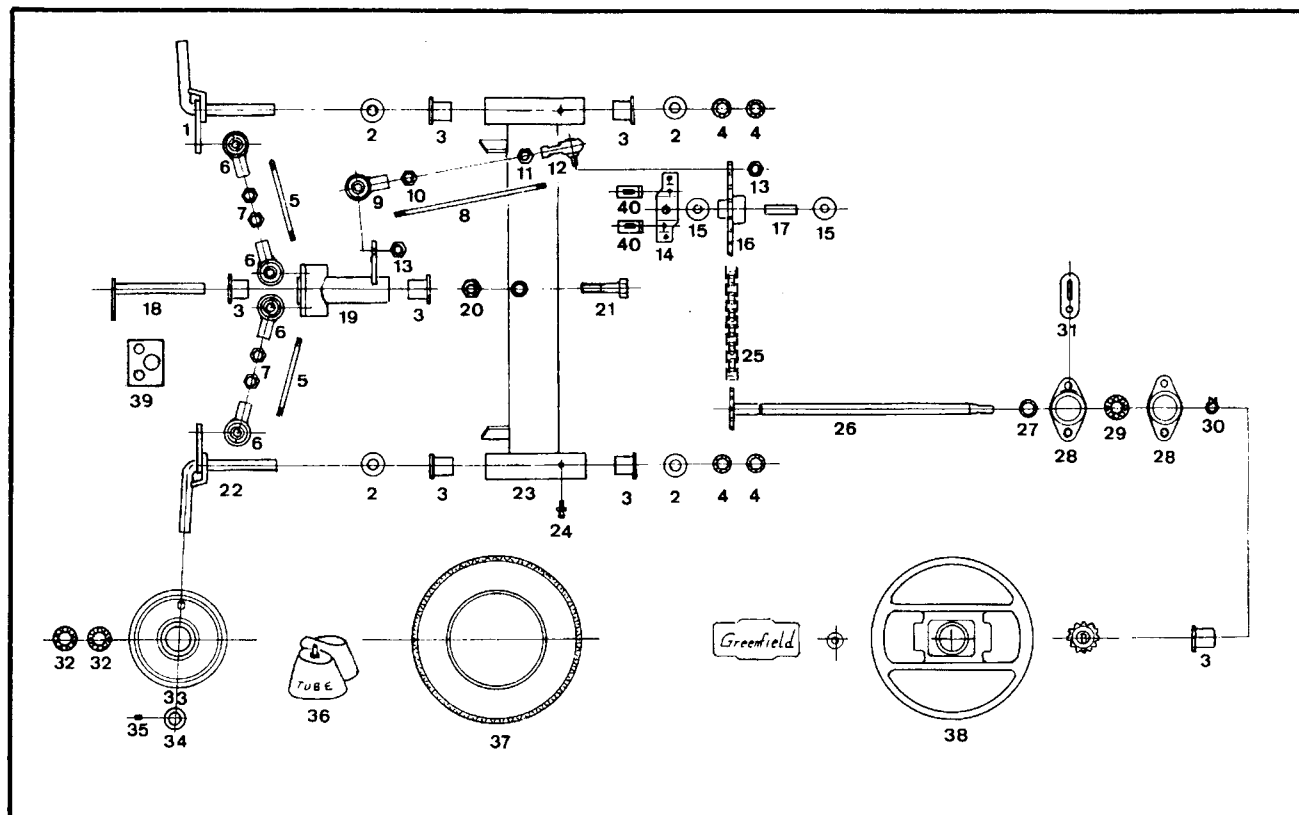

| INDEX | PART NO. | DESCRIPTION                  | INDEX | PART NO.   | DESCRIPTION                      |
|-------|----------|------------------------------|-------|------------|----------------------------------|
| 1     | GT 20495 | R.H. King Pin 32 Model       | 21    | GT 2544    | Bolt 32 Model                    |
| 1     | GT 20540 | R.H. King Pin 34 Model       | 21    | GT 2476    | Bolt 34 Model                    |
| 2     | GT 7304  | Washer                       | 22    | GT 20505   | L.H. King Pin 32 Model           |
| 3     | GT 1766  | Bush                         | 22    | GT 20545   | L.H. King Pin 34 Model           |
| 4     | GT 580   | Retainer                     | 23    | GT 21345   | Axle Beam 32 Model               |
| 5     | GT 18059 | Tie Rod 32 Model             | 23    | GT 20530   | Axle Beam 34 Model               |
| 5     | GT 20052 | Tie Rod 34 Model             | 24    | GT 1924    | Grease Nipple                    |
| 6     | GT 1626  | Tie Rod End 32 Model         | 25    | GT 13813   | Roller Chain Complete            |
| 6     | GT 6044  | Tie Rod End 34 Model         | 26    | GT 18880   | Steering Shaft                   |
| 7     | GT 78    | Lock Nut 32 Model            | 27    | GT 20018   | Spacer                           |
| 7     | GT 2406  | Lock Nut 34 Model            | 28    | GT 7017    | Bearing Plate                    |
| 8     | GT 22004 | Rod - Steering Link 32 Model | 29    | GT 7010    | Ball Bearing                     |
| 8     | GT 22003 | Rod - Steering Link 34 Model | 30    | GT 2470    | Circlip                          |
| 9     | GT 6044  | Tie Rod End                  | 31    | GT 18324   | Locking Tab                      |
| 10    | GT 2406  | Lock Nut                     | 32    | GT 396     | Ball Bearing - Wheel Hub         |
| 11    | GT 2295  | Lock Nut Left Hand Thread    | 33    | GT 7007 UP | Wheel Hub Aluminium 32 Model     |
| 12    | GT 2294  | Tie Rod End Left Hand Thread | 33    | GT 7007    | Wheel Hub Powder coated 34 Model |
| 13    | GT 2090  | Nyloc Nut                    | 34    | GT 7009    | Collar                           |
| 14    | GT 18329 | Support                      | 35    | GT 520     | Socket Set Screw                 |
| 15    | GT 2483  | Brass Washer                 | 36    | GT 456     | Tube                             |
| 16    | GT 20445 | Chain Wheel                  | 37    | GT 455     | Tyre                             |
| 17    | GT 20024 | Bush                         | 38    | GT 1785    | Steering Wheel 32 Model          |
| 18    | GT 18645 | Pivot Pin                    | 38    | GT 2212    | Steering Wheel 34 Model          |
| 19    | GT 20550 | Steering Crank               | 39    | GT 22150   | Reinforcing Plate                |
| 20    | GT 2042  | Nyloc Nut                    | 40    | GT 18317   | Steering Stops                   |

PARTS AND SPECIFICATIONS SUBJECT TO CHANGE WITHOUT NOTICE.  
STANDARD HARDWARE ITEMS ARE NOT SHOWN.

# Cutter Deck

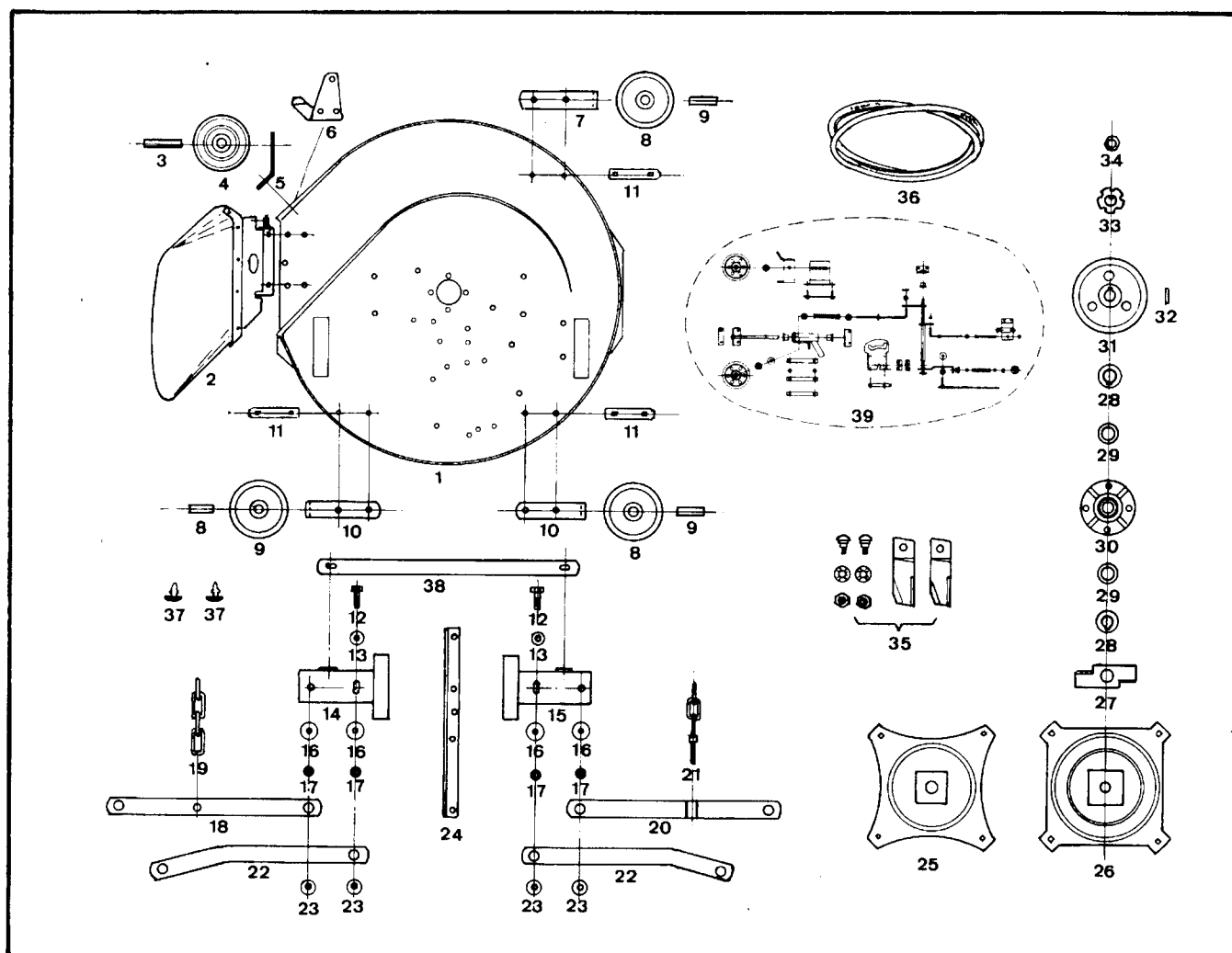

| INDEX | PART NO. | DESCRIPTION                    |
|-------|----------|--------------------------------|
| 1     | GT 22158 | 32 Cutter Deck Drilled Casting |
| 1     | GT 20162 | 34 Cutter Deck Drilled Casting |
| 2     | GT 20936 | Stone Guard                    |
| 3     | GT 20049 | Bush                           |
| 4     | GT 2263  | Domed Jockey Wheel             |
| 5     | GT 20180 | Bracket                        |
| 6     | GT 14392 | Skid Deck 32 Only              |
| 7     | GT 20166 | Bracket 34 Only                |
| 8     | GT 2264  | Jockey Wheel                   |
| 9     | GT 22005 | Bush                           |
| 10    | GT 12362 | Bracket                        |
| 11    | GT 21160 | Retainer                       |
| 12    | GT 3     | Bolt                           |
| 13    | GT 1567  | Cone Washer                    |
| 14    | GT 20610 | L.H. Side Plate                |
| 15    | GT 20605 | R.H. Side Plate                |
| 16    | GT 579   | Wave Washer                    |
| 17    | GT 730   | Bush                           |
| 18    | GT 18835 | L.H. Top Link                  |
| 19    | GT 12346 | Chain                          |

| INDEX | PART NO.      | DESCRIPTION  |
|-------|---------------|--|
| 20    | GT 18965      | R.H. Top Link  |
| 21    | GT 18975      | Chain - Adjust   |
| 22    | GT 22159      | Bottom Link  |
| 23    | GT 1012       | Washer   |
| 24    | GT 20192      | Stiffener 34 Only  |
| 25    | GT 13025      | 32 Cutter Disc & Spindle                                     |
| 26    | GT 20285      | 34 Cutter Disc & Spindle                                     |
| 27    | GT 20214      | Bearing Protector  |
| 28    | GT 20177      | Keyed Washer   |
| 29    | GT 539        | Shim   |
| 30    | GT 13815      | Spindle Housing Complete                                     |
| 31    | GT 14044      | Vee Pulley   |
| 32    | GT 20019      | Key  |
| 33    | GT 14390      | Tab Washer   |
| 34    | GT 2003       | Nut M20 L.H.   |
| 35    | GT 2139       | Blade and Bolt Set   |
| 36    | GT 18005      | V-Belt Cutters   |
| 37    | GT 1760       | Nylon Button   |
| 38    | GT 20223      | Spreader   |
| 39    | Cutter Clutch | See Page 16. "Cutter Clutch" for all component part numbers. |

PARTS AND SPECIFICATIONS SUBJECT TO CHANGE WITHOUT NOTICE.  
STANDARD HARDWARE ITEMS NOT SHOWN.

# Body Work and Seat

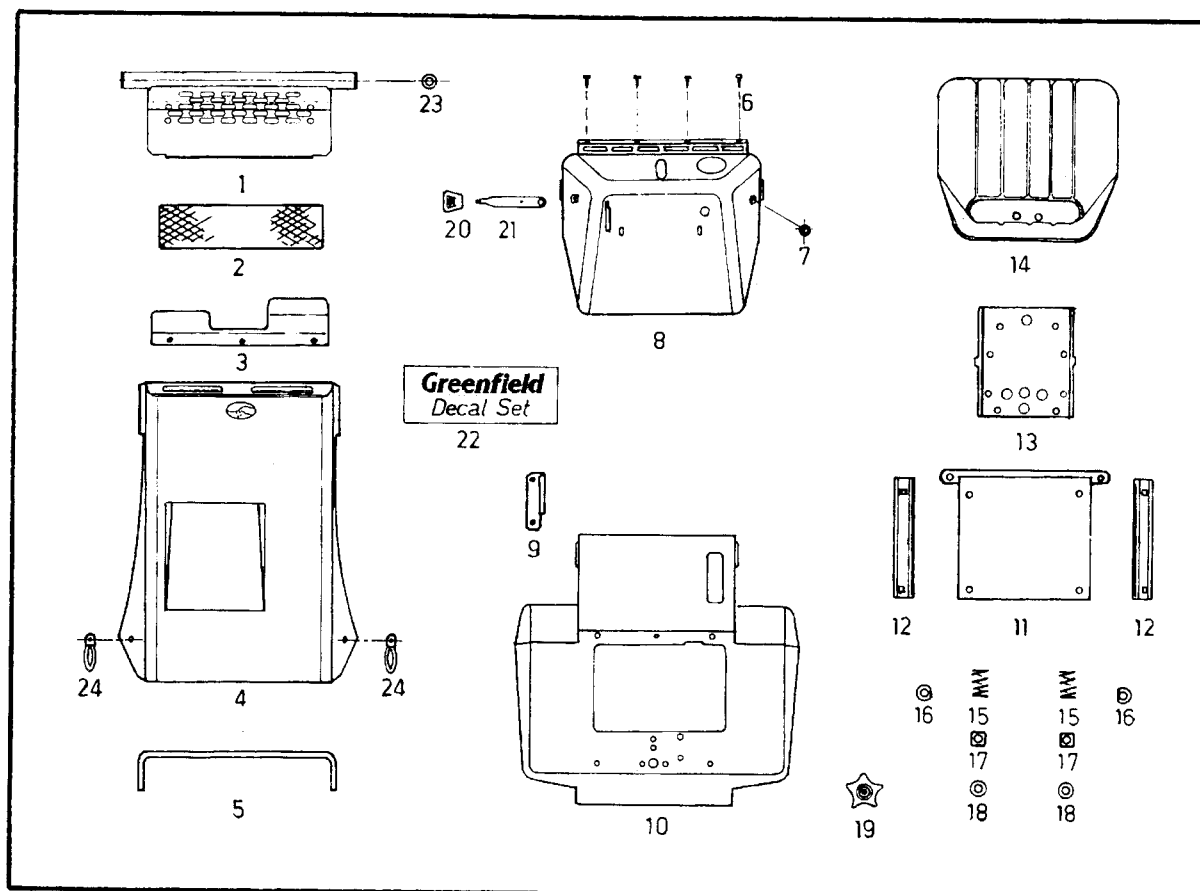

| INDEX | PART NO.      | DESCRIPTION                        | INDEX | PART NO. | DESCRIPTION                     |
|-------|---------------|------------------------------------|-------|----------|---------------------------------|
| 1     | GT 20570      | Muffler Guard/Bumper Twin Cyl Only | 14    | GT8063   | Seat 32 Model                   |
| 2     | GT 22163      | Grille 32 Model Only               | 14    | GT 2283  | Seat 34 Model                   |
| 3     | GT 22162      | Heat Shield Head Lights Single Cyl | 15    | GT 14050 | Spring                          |
| 3     | GT 22161      | Heat Shield Head Lights Twin Cyl   | 16    | GT 10452 | Clamp                           |
| 4     | GT 22320      | Bonnet                             | 17    | GT 10451 | Locating Block                  |
| 5     | RM 906 x 1Mtr | Pinchweld - Front or Rear          | 18    | GT 1660  | Washer                          |
| 6     | GT 6094       | Buffer Grommet                     | 19    | GD 5545  | Knob - Rear Cover               |
| 7     | GT 2254       | Bobbin - Strap                     | 20    | GT 2026  | Knob - Throttle Lever           |
| 8     | GT 20450      | Steering Cowl                      | 21    | GT 20169 | Lever - Throttle                |
| 9     | GT 18336      | Latch - Park Brake                 | 22    | GT 22015 | Decal Sheet 32 Model            |
| 10    | GT 18670      | Rear Cover                         | 22    | GT 22020 | Decal Sheet 34 Single Cyl Model |
| 11    | GT 21340      | Hinged Seat Base                   | 22    | GT 22025 | Decal Sheet 34 Twin Cyl Model   |
| 12    | GT 21343      | Runner                             | 23    | GT 6081  | Plastic Bong - Bumper Bar       |
| 13    | GT 21342      | Seat Support                       | 24    | GT 7015  | Strap - Bonnet Hold Down        |

NOTE: BODY PANELS ARE BARE ITEMS PAINTED.

PARTS AND SPECIFICATIONS SUBJECT TO CHANGE WITHOUT NOTICE.  
STANDARD HARDWARE ITEMS ARE NOT SHOWN.