

Greenfield

Evolution II

MODELS



12-32

HONDA 13^{only} 32



Instructions & Spare Parts

Greenfield Products Pty Ltd

172 Ingram Road, Acacia Ridge, Q 4110 Australia

Fax: (07) 3344 1161 Phone: (07) 3345 6100

Greenfield

Evolution II

Thank you for buying an Australian made Greenfield mower. Follow the manufacturer's operating and maintenance instructions and many years of excellent trouble free service can be expected.

Before operating the mower read the owner's manual carefully. Do not allow children or any person unfamiliar

with the safe operating procedure to operate this mower. Your Greenfield mower has been designed to meet stringent safety standards — but we remind you that a mower is a cutting device — used incorrectly it could cause personal injury.

SAFETY INSTRUCTIONS

1. Do not carry passengers.
 2. Know your controls. Read the operating instructions carefully. Learn how to stop the mower and the engine quickly in an emergency.
 3. Do not mow whilst people, especially children or pets are in the mowing area.
 4. Make sure the area to be mown is clear of sticks, stones, bottles, bones, wire and other debris which could be thrown by the blades.
 5. Do not operate the machine without first inspecting the blades, blade bolts and blade holder for wear or damage.
- DAMAGED BLADES AND WORN BOLTS ARE MAJOR HAZARDS**
- Always replace blades and blade bolts in sets to preserve balance. Replace worn or damaged parts with **GENUINE GREENFIELD** replacement parts only.
- N.B. Use of inferior non-genuine service parts on your Greenfield mower could result in costly damage and even personal injury.
- Refer "Maintenance Instructions", for replacement part numbers and fitting instructions.
6. Check that grass catcher, guards and switches provided by the manufacturer are operating properly and fitted securely. Regularly check all the components on the mower to ensure the machine is in a safe operating condition.
 7. Never mow while barefoot or wearing open sandals or thongs. Wear long trousers and heavy shoes. It is also advisable to wear suitable eye protection.
 8. A mower operator should be in good physical and mental health and not under the influence of any drug or alcohol which might impair vision, co-ordination or judgement.
 9. Replace worn or faulty silencers.
 10. Keep the engine free of grass, leaves or excessive grease. These can be a fire hazard.
 11. Refuel outdoors only. Do not smoke while fuelling engine. Never remove the cap of the fuel tank or add petrol while the engine is running or the engine is hot. Remove fuel cap slowly to relieve any tank pressure. If petrol is spilled do not attempt to start the engine but move the machine away from the area of the spill and avoid creating any source of ignition until petrol vapours have dissipated.
 12. Check for fuel leaks, while refuelling or using the mower. If a fuel leak is detected, do not start the engine until the fuel leak is fixed and the spilled fuel is wiped away.
 13. Do not operate the engine in a confined space where poisonous exhaust fumes (Carbon Monoxide) can collect.
 14. Always disengage the cutting means before starting the engine.
 15. Always mount the mower from the opposite side to the discharge chute.
 16. Exercise extreme caution when on slopes. Reduce speed particularly when making sharp turns to prevent overturning or loss of control. Do not stop or start suddenly when mowing uphill or downhill.
 17. Never operate a ride-on mower across the face of a slope.
 18. Stay alert for holes in the terrain and other hidden hazards.
 19. Before crossing paths, driveways or any other area foreign to mowers, disengage cutting blades and lift cutting attachment to maximum height.
 20. Watch out for traffic when crossing or operating the mower near roadways.
 21. When using any attachment, never direct discharge of material toward bystanders nor allow anyone near the machine while in operation.

22. Before leaving the operator's position -
 - a. disengage all clutches and secure cutting units.
 - b. apply the parking brake.
 - c. stop the engine and remove the key.
23. Stop the engine and disengage the drive to the attachments -
 - a. before refuelling.
 - b. before removing grass catcher or any attachment.
 - c. before making a height adjustment unless adjustment is being made from the operator's position.
 - d. before cleaning blockages.
 - e. before inspecting, cleaning or working on the mower.
 - f. after striking a foreign object (inspect the mower for damage and make necessary repairs before restarting and operating the machine)
 - g. If the machine starts to vibrate abnormally (check immediately)
24. Disengage drive to attachments when not in use or in transporting.
25. Do not over-speed the engine or alter governor settings. Excessive speed is dangerous and shortens the mower's life.
26. Use care when pulling loads or using attachments.
 - a. use only approved drawbar hitch points.
 - b. limit loads to those you can safely control.
 - c. do not turn sharply. Use care when backing up.
27. Store the mower in a well ventilated room away from naked flames such as may be found in hot water heaters.
28. Do not lend or sell the mower without the owner's manual.
29. **WARNING** - Remove spark plug lead to avoid accidental starting **BEFORE** attempting any maintenance or inspection of the mower.

OPERATING INSTRUCTIONS

TO OPERATE:

Do not allow children or any person unfamiliar with the safe operating procedure to use this mower.

Know your controls. Read the following instructions carefully. Learn how to stop the mower and the engine quickly in an emergency.

BEFORE STARTING:

Fuel: Top with clean regular **UNLEADED** petrol only. Make sure the petrol is free from impurities. The petrol tank is located inside the engine compartment of your Greenfield. Raise the bonnet for access.

Engine Oil: Fill to the mark indicated on the dipstick. Don't overfill. Use Castrol GTX or S.A.E. 30 motor oil.

Tyres: Inflate to the pressure indicated on the tyres. Don't over inflate.

TO START:

Disengage blade clutch (Cutters Out) Apply park brake. Turn on fuel tap. For cold starting set throttle control to "CHOKE", push starter button. If engine does not start, set throttle half way then press button again.

IMPORTANT - this Evolution Model Greenfield mower is fitted with a safety 'cut-out' switch activated by the seat. The operator must be seated to start the engine and remain seated while operating the mower.

Foot Pedal: A simple pivoted foot pedal controls forward, neutral and reverse. Increased toe or heel pressure provides speed variation in forward or reverse respectively. Allow pedal to centralise for neutral. The drive pedal can be used to reduce the speed of the mower by applying toe or heel pressure opposite to the directional movement of the mower. Sudden directional changes and/or wheel spinning must be avoided.

Brake : Although, in general use, the drive pedal is used to brake the mower, a hand operated emergency/park brake is also fitted.

The lever is located on the left side in front of the rear mudguard. To apply emergency brake pull and hold brake lever up. To engage parking brake pull lever fully up and backwards into "PARK" position. To release the parking brake, return lever to the "OFF" position.

Cutting Height : The height adjusting lever located on the right side of the mower enables the operator to select the desired cutting height from the nine (9) height settings provided.

Blade Clutch : To engage cutting blades ease the "BLADE CLUTCH" lever located in the control console to the "IN" position. To disengage cutting blades shift the lever to the "OUT" position.

Seat : The operator's seat is adjustable front to rear. To adjust, hinge seat forward, loosen four (4) seat securing bolts, slide seat to position required and retighten bolts.

MAINTENANCE

Crankcase Lubrication - Change engine oil after first 5 hours of operation then every 15 working hours thereafter. Change more often in heavy or dusty conditions. Drain engine oil whilst engine is hot then replace with CASTROL GTX or refer to Engine manufacturers operating booklet Oil Recommendations. Fill to mark indicated on dipstick. **DON'T OVERFILL.**

The Honda O.H.V. engine is fitted with an "Oil-Alert" system which sounds a warning buzzer whenever the oil drops below the safe level. Stop and add oil to the engine.

Air Filter: Service air filter as per engine manufacturer's leaflet. Clean more often in dusty conditions. Never operate the engine without air filter correctly and securely fitted.

Cooling System:

Remove the blower housing and clean out the grass and debris to prevent overheating. Refer engine manufacturer's leaflet.

Lubrication Points:

The Evolution II model Greenfield mower has 3 greasing points. Grease nipples are fitted to the steering lever (between the internal and external drag links), the clutch transfer tube and the height adjuster tube. These points are greased before leaving the factory. Service annually with CASTROL LMM chassis grease. All other exposed pivot joints and slide bushes lubricate with engine oil. Grease nipples on the clutch transfer tube and height adjuster tube, oiling points on clutch arms, notch bar and hand brake mechanism are accessible from under the rear cover. The rear drive chain should be removed, cleaned in kerosene and reoiled with CASTROL chain oil.

WARNING

Remove spark plug lead to avoid accidental starting BEFORE inspecting or replacing cutting blades or belts, also before attempting any form of maintenance or cleaning of the mower.

Blades:

Check the condition of blades, blade bolts and blade holder. Replace if damaged or worn. Damaged blades and worn bolts are major hazards. Always replace worn or damaged blades or bolts in sets to preserve balance. Use only GENUINE Greenfield replacement parts. Use of inferior non-genuine service parts on your Greenfield could result in costly damage and even personal injury. Insist on genuine parts branded Greenfield.

Part numbers for replacement parts —
Cutter Blades GT 2104
Blade Bolt Set GT 2110

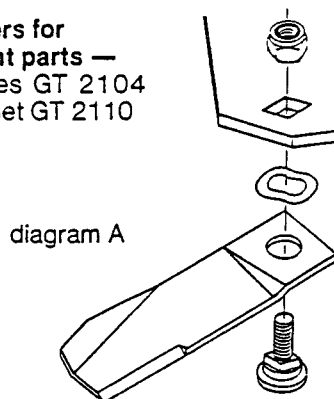

To fit new blades refer to diagram A. Tighten the blade bolt nuts firmly. Correct torque is 44 Nm. (32ft. lbs.) Blades must be free to turn but not loose.

Battery:

Top with distilled water as required. If externally charging, care is needed. Remove one battery terminal and TRICKLE CHARGE ONLY to avoid battery damage.

Tyres:

Inflate to pressure indicated on the tyres. Don't over inflate.

Belts:

Inspect the V belts and replace if damaged.

To remove drive-clutch V belt CT 371

1. Disconnect wire from seat cutout switch and remove rear cover.
2. Lower blade height to "LOW".
3. Remove retaining pin "A" from each end of clutch thrust arm "B". Lift and swing rear clutch link "C" rearwards and lift rear end of thrust arm upwards.
4. With spring release tool "D", remove tension spring "E" from idler pulley notch bar "F".
5. While applying forward pressure on idler pulley "G", pull release lever "H" rearwards, this releases notch bar and allows idler pulley to travel rearwards to permit belt removal.

To replace drive-clutch V belt GT 371

1. Feed the belt down the back of the clutch pulleys "I". From under the machine, guide V belt over rear axle "J", chassis brace "K" over the height adjuster tube "L" and steering arm support "M" then into the bottom groove of engine pulley "N".
2. Fit the belt into both clutch pulleys, into the idler pulley "G" then over the flat idler pulleys "P".
3. Push the idler pulley notch bar firmly forward and replace tension spring using spring release tool.
4. Replace rear clutch link and retaining pins.
5. Replace cover and reconnect wire to seat cut out switch.

To remove Cutter V belt GT 10041

1. Disengage cutter (cutter "OUT") and lower blade height to "LOW".
2. To remove cutter V belt, the drive-clutch V belt must first be removed from the engine pulley. Follow steps 4 and 5 of "To remove drive-clutch V belt" instructions. It is necessary to remove this belt from the engine pulley only.
3. Using two spanners 3/8" BS remove the idler pulleys "Q" and belt guides "R" under the front of the machine.
4. Remove the top belt guide "S" from the cutter pulley "T", loosen the nut on one side, then remove the nut on the other side to allow the guide to swing away.
5. Remove belt from machine.

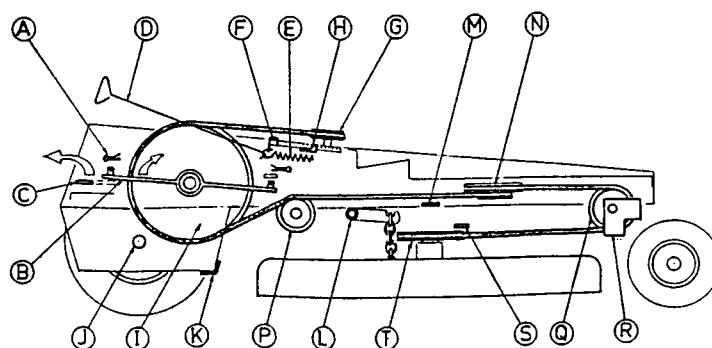

diagram B

To replace Cutter V belt GT10041

1. Refit the idler pulleys to the mounting brackets in this order. On the left side (sliding bracket) pass bolt through rear hole in bracket, while holding bolt slide on belt guide (with cutter brake linkage) then bearing adaptor, large end first. While holding V belt into groove, slip pulley over bolt and onto bearing adaptor with the wings of the guard over the belt. Fit thick washer and nyloc nut. On right hand side, slip thick washer onto bolt, pass bolt through predetermined hole in bracket (refer Cutter Belt Adjustment) slide on belt guide then bearing adaptor, large end first. While holding V belt into groove slip pulley over bolt and onto bearing adaptor, fit another thick washer and nyloc nut. Tighten nuts using two spanners. N.B. check pulleys turn freely inside belt guides with cutter clutch disengaged. (cutter "OUT")
2. Fit belt to the top groove of the engine pulley "N" then to the cutter pulley "T"
3. Replace belt guide "S" over cutter pulley.
4. Fit drive clutch belt into bottom groove of engine pulley and tension belt. (refer "To Replace Drive Clutch Belt")

The part numbers for V belts are —

Drive-Clutch V belt GT 371

Cutters V belt 10041

Use only GENUINE Greenfield replacement parts.

STEERING ADJUSTMENT

To remove excess slack from the steering chain —

1. Open the bonnet and with a 13mm socket loosen the nuts securing the flangette plates and bearing at the base of the steering shaft.
2. With fingers only pull the front bolt in the slot to the right side of the machine. No force is required. Do not overtighten — the chain must have 3mm (1/8") of slack. Refer diagram B.
3. Retighten nyloc nuts.

REAR DRIVE CHAIN ADJUSTMENT

1. Unlock rear nuts on both rear axle flangette bearing mounting plates.
2. Slacken brake shoe pivot bolt to allow shoes to move freely with axle.
3. When adjusting, it is very important that the rear axle remains parallel to the mower chassis. Therefore the adjustment nuts positioned under the rear axle side plates should each be turned no more than a quarter of a turn at a time alternating between the two till the chain has 3mm (1/8") of slack. Don't overtighten. Refer diagram B.
4. Re-tighten both nuts on rear axle flangette bearing mounting Plates.
5. Check that brake shoes are evenly centered around brake drum and re-tighten pivot bolt.

Cutter Belt Adjustment

Both cutter belt idler pulleys can be adjusted to allow for belt stretch. The first adjustment should be required after approximately 10 hours of operation with further adjustments after approximately 50 hours. The right side pulley has four positions available.

When a new belt is fitted this pulley should be fitted in the second hole from the rear, or, if some wear to the pulleys is evident then fit it to the next hole forward. The left side idler pulley bracket has two adjustment holes. The pulley is fitted in the rear hole at the factory and unless extraordinary belt stretch is experienced, adjustments to the right side only should suffice. The cutter belt has an adjustment indicator decal on top of the chassis in front of the engine. When the cutter clutch is engaged and the pointer has travelled into the red zone an adjustment to the position of an idler pulley is required. Remove the pulley by following steps No.1 and 3 of "To Remove Cutter V Belt" instructions. Be sure to note which mounting position the pulley was in then move it to the next position forward. Replace pulley by following step No 1 of "To Replace Cutter V Belt" instructions.

WARNING— Remove spark plug lead to avoid accidental starting BEFORE attempting any maintenance or inspection of the mower.

DIAGRAM B

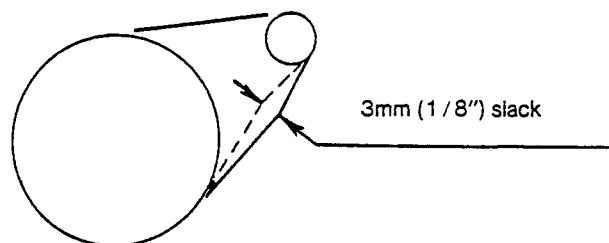

EMERGENCY BRAKE ADJUSTMENT

Screw nut on adjusting screw at top of brake shoes, using 5/16" BS (14mm) socket on a 12" (300mm) extension, this nut is accessible through hole in left side of rear panel just below bumper bar. N.B. Don't overtighten. Jack up rear of machine to check wheels still turn freely with park brake in "OFF" position.

CLEANING:

Don't use a high pressure hose when cleaning. Water can penetrate bearings and cause failure. We suggest that you return your Greenfield to your local Greenfield dealer during winter for an annual preventative maintenance check.

ELECTRICAL CIRCUITS

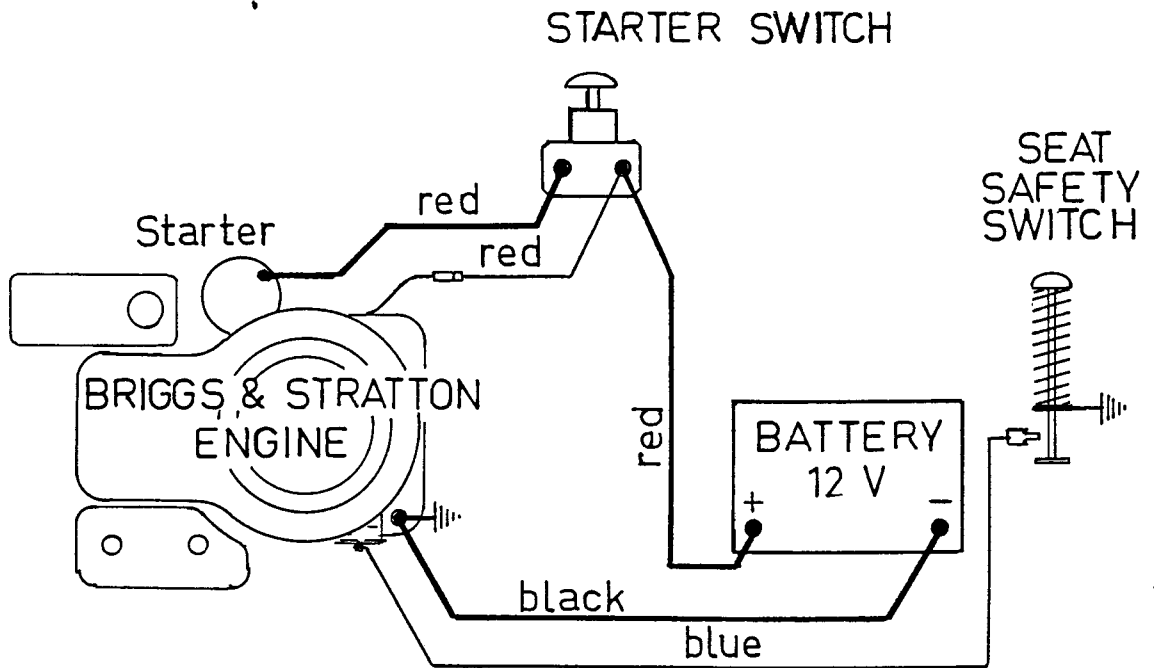

ELECTRICAL CIRCUIT DIAGRAM
EVOLUTION II 12-32

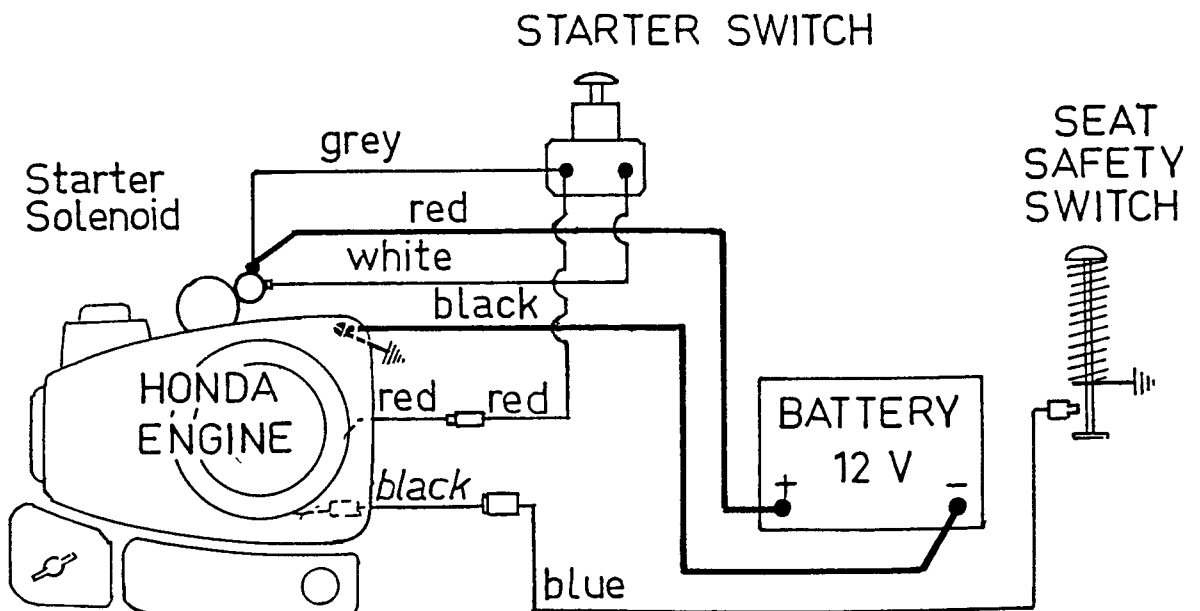

ELECTRICAL CIRCUIT DIAGRAM
EVOLUTION II 13-32

ILLUSTRATION 1

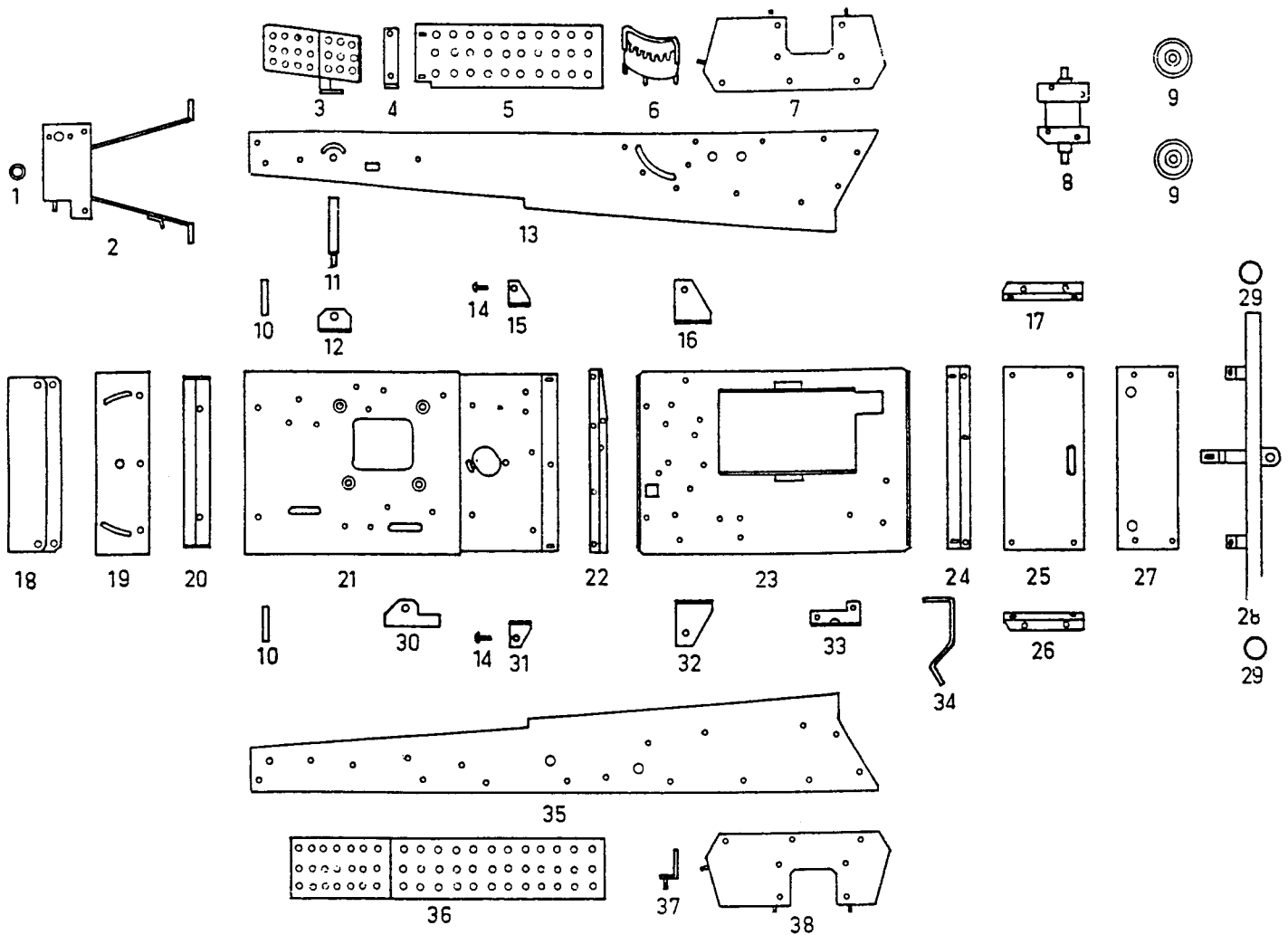

CHASSIS

INDEX PART NO. DESCRIPTION

1	GT 1766	Bush
2	GT11040	Steering Frame
3	GT10690	F-R Foot Pedal
4	GT10466	Support
5	GT10465	R.H. Running Board
6	GT11090	Height Adjuster Rack
7	GT10930	R.H. Side Plate
8	GT11230	Support
9	GT 1009	Pulley
10	GT10485	Belt Guide
11	GT 7042	Foot Pedal Shaft
12	GT10412	Bracket
13	GT11841	R.H. Side Frame
14	GT 1760	Nylon Button
15	GT 7115	Bracket R.H.
16	GT10414	Bracket R.H.
17	GT10449	Bracket R.H.
18	GT10453	Front Bumper
19	GT11110	Backing Plate

INDEX PART NO. DESCRIPTION

20	GT10419	Bonnet Mounting Plate
21	GT10420	Front Frame
22	GT10430	Stiffener
23	GT10890	Clutch Base
24	GT10469	Brace
25	GT10444	Rear Panel Upper
26	GT10450	Bracket L.H.
27	GT10431	Rear Panel Lower
28	GT10880	Rear Bumper Bar
29	GT 6081	Bung
30	GT 6399	Bracket
31	GT 7114	Bracket L.H.
32	GT10415	Bracket L.H.
33	GT10429	Bracket
34	GT10423	Spring Anchor
35	GT11824	L.H. Side Frame
36	GT10470	L.H. Running Board
37	GT11190	Support
38	GT10920	L.H. Side Plate

ILLUSTRATION 2

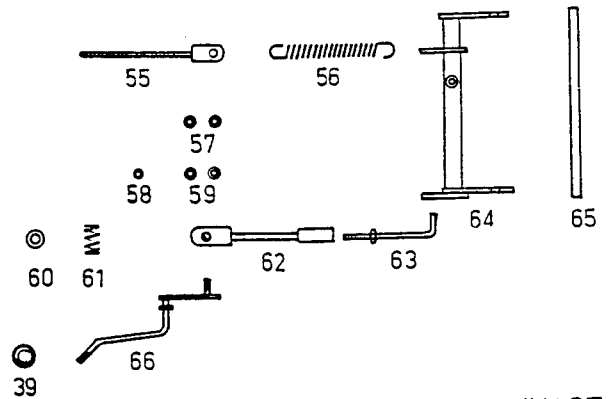
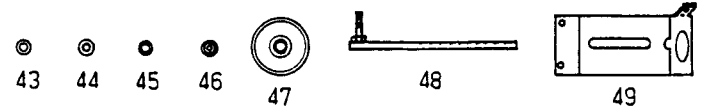
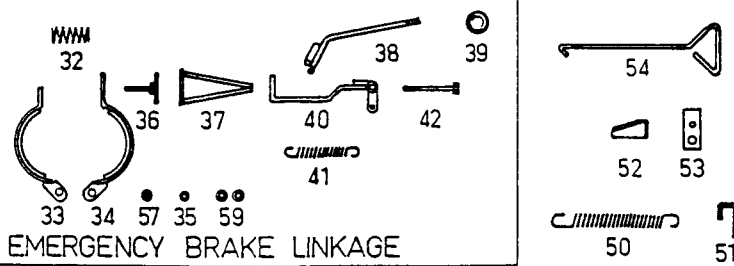
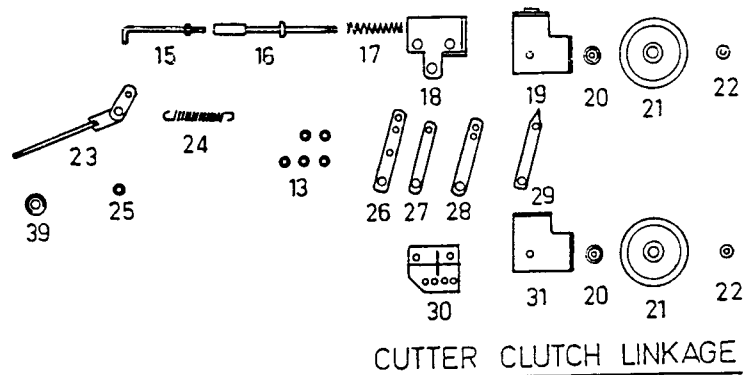
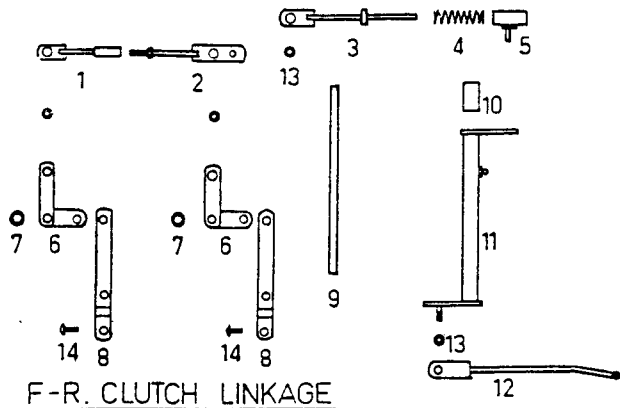

INDEX	PART NO.	DESCRIPTION
1	GT10660	Rear Link
2	GT10650	Front Link
3	GT10680	Overload Link
4	GT 6141	Spring
5	GT10670	Sliding Bush
6	GT10640	Pivot Arm
7	GT10006	Pivot Bush
8	GT10411	Clutch Link
9	GT10011	Shaft
10	GT10012	Spacer
11	GT10720	Transfer Tube
12	GT10710	F-R Control Link
13	GT 730	Pivot Bush
14	GT 1760	Nylon Button
15	GT 8227	Adjusting Arm
16	GT10870	Rod
17	GT 6066	Spring
18	GT 6600	Bracket Sliding
19	GT11180	Belt Guide L - H
20	GT 6018	Bearing Adaptor
21	GT 6901	V Pulley
22	GT 6407	Washer
23	GT10740	Handle
24	GT 6147	Spring
25	GT 1851	Pivot Bush
26	GT 6608	Clutch Arm-Rear
27	GT 6605	Stabilizer Arm
28	GT 6611	Clutch Arm-Front
29	GT 6607	Indicator
30	GT11170	Bracket Fixed
31	GT 6303	Belt Guide R H
32	GT 7071	Spring
33	GT 7996	Brake Shoe Complete
34	GT 7995	Brake Shoe Complete
35	GT 1851	Pivot Bush

INDEX	PART NO.	DESCRIPTION
36	GT11080	Screw
37	GT11050	Calliper
38	GT11070	Handle
39	GT 1565	Knob
40	GT11060	Lever
41	GT 6064	Spring
42	GT 2409	Bolt
43	GT 608	Slide Bush
44	GT 23	Washer
45	GT 579	Wave Washer
46	GT 610	Bearing Adaptor
47	GT 7965	V Pulley
48	GT11210	Notch Bar
49	GT10413	Bracket
50	GT 1554	Spring
51	GT 7308	Spring Anchor
52	GT 6432	Release Lever
53	GT 640	Leaf Spring
54	GT 2071	Spring Release Tool
55	GT10910	Tension Rod
56	GT 6030	Spring
57	GT 1567	Washer
58	GT 730	Pivot Bush
59	GT 1012	Washer
60	GT 23	Washer
61	GT 349	Spring
62	GT10750	Link
63	GT 8227	Adjusting Arm
64	GT10760	Height Adjust Tube
65	GT10014	Shaft
66	GT10770	Lever

This diagram illustrates the components of a vehicle's rear window assembly, numbered 1 through 38. The parts include:

- 1**: Main rear window frame assembly.
- 2**: Small circular fastener or pin.
- 3**: Concentric circular gasket or seal.
- 4**: Small rectangular pin or clip.
- 5**: Small circular fastener or pin.
- 6**: Small circular fastener or pin.
- 7**: Small circular fastener or pin.
- 8**: Small rectangular fastener or clip.
- 9**: Small rectangular fastener or clip.
- 10**: T-shaped metal pin or clip.
- 11**: Long, thin metal rod or pin.
- 12**: Small rectangular fastener or clip.
- 13**: Small triangular fastener or clip.
- 14**: Long, thin metal rod or pin with a pointed end.
- 15**: Wedge-shaped metal component.
- 16**: Small curved metal clip.
- 17**: Large, irregularly shaped metal component, likely a hinge or bracket.
- 18**: Small circular fastener or pin.
- 19**: Small cylindrical fastener or pin.
- 20**: Small circular fastener or pin.
- 21**: Long, thin, curved metal rod or pin.
- 22**: Small circular fastener or pin.
- 23**: Rectangular metal plate or bracket.
- 24**: 12 V. BATTERY.
- 25**: Small curved metal clip.
- 26**: L-shaped metal bracket.
- 27**: Long, thin metal rod or pin with a hook end.
- 28**: Coiled cable or wiring harness.
- 29**: Long, thin metal rod or pin.
- 30**: Small rectangular fastener or clip.
- 31**: L-shaped metal bracket.
- 32**: Small circular fastener or pin.
- 33**: Small circular fastener or pin.
- 34**: Small circular fastener or pin.
- 35**: Small rectangular fastener or clip.
- 36**: Small rectangular fastener or clip.
- 37**: Small rectangular fastener or clip.
- 38**: Small rectangular fastener or clip.

INDEX	PART NO.	DESCRIPTION	INDEX	PART NO.	DESCRIPTION
1	GT 7001	Engine B&S 12 HP	19	* GT10043	Tail
1	GT 6032	Engine Honda 13HP	20	* GT10044	Nut
2	GT10033	Spacer	21	* GT10495	Hose
3	GT10040	Pulley	22	* GT 2024	Clamp
4	GT 1500	Key	23	GT 6320	Rubber Mat
5	GT 520	Grub Screw	24	GT 7099	Battery
6	GT 1750	Washer	25	GT 6062	Spring
7	GT 2021	Spring Washer	26	GT10502	Spring Anchor
8	GT 1069	Bolt	27	GT11826	Battery Clamp
9	GT10464	Oil Channel	28	GT11827	Wiring Harness 12 HP
10	GT11220	Oil Plug Spanner	28	GT11828	Wiring Harness 13 HP
11	GT11825	Throttle Cable 12 HP	29	GT 2079	Bolt
11	GT11824	Throttle Cable 13 HP	30	GT 6021	Spring
12	GT 1252	Cable Clamp	31	GT10433	Bracket
13	GT 2025	Knob	32	GT 1106	Nut
14	GT 6351	Throttle Lever	33	GT 6537	Brass Washer
15	* GT10980	Tank Support	34	GT 4	Nut
16	* GT 8058	Spring	35	GT 1915	Starter Switch
17	* GT 7002	Fuel Tank	36	GT 1995	Starter Button
18	* GT 7005	Cap - Fuel Tank	37		
			38	GT11809	Seat Switch Complete

8

ILLUSTRATION 4

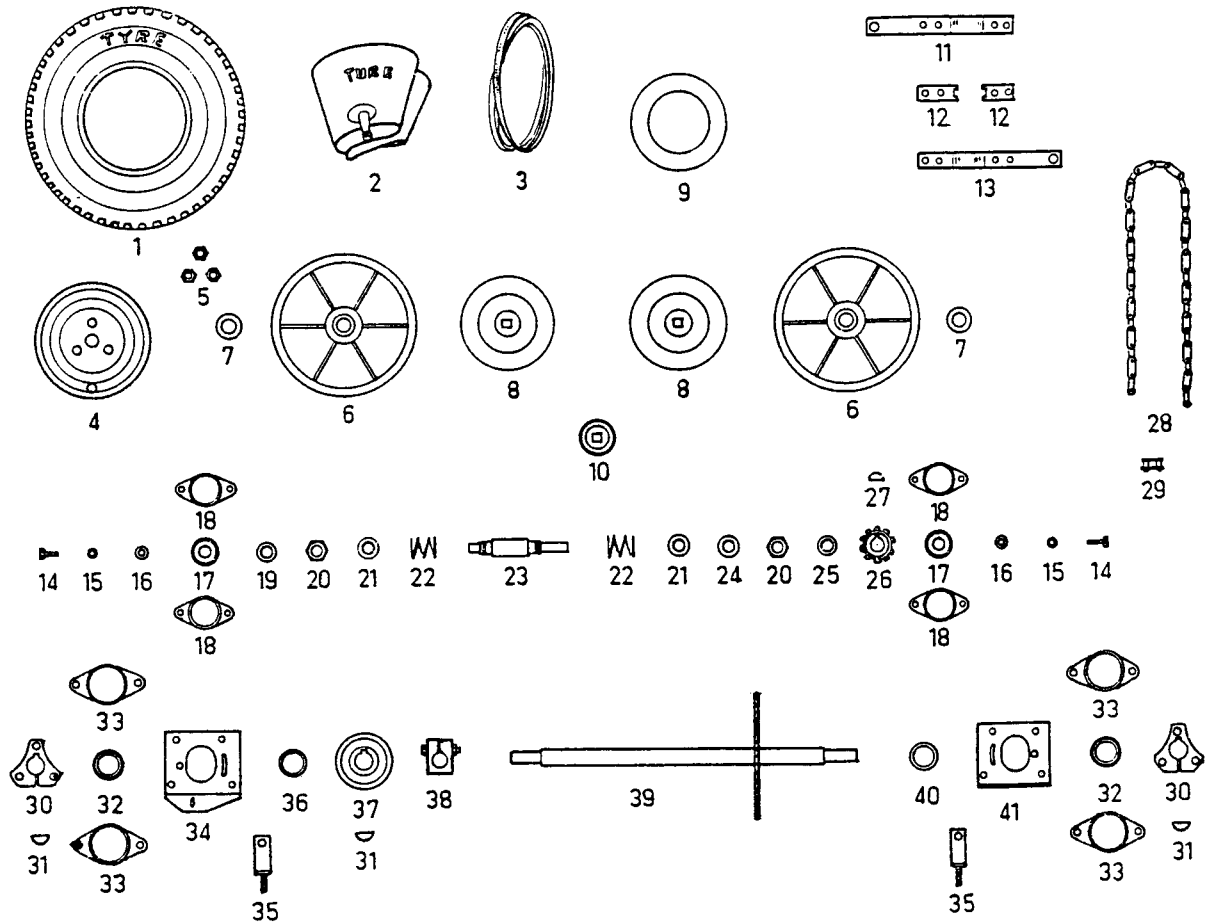

DRIVE CLUTCH & REAR AXLE

INDEX	PART NO.	DESCRIPTION
1	GT10001	Tyre
2	GT10002	Tube
3	GT 371	V Belt-Drive
4	GT 1624	Wheel Hub
5	GT 2011	Wheel Nut
6	GT 6850	Clutch Pulley Complete
7	GT 2206	Bearing
8	GT 926	Drive Plate Complete
9	GT 567	Clutch Lining
10	GT11847	Thrust Bearing Unit
11	GT10620	Yoke Top Half
12	GT10410	Retainer
13	GT10630	Yoke Bottom Half
14	GT 1455	Set Screw
15	GT 2052	Spring Washer
16	GT 7306	Washer
17	GT 7010	Bearing
18	GT 7017	Flangette Plate
19	GT 7304	Washer
20	GT 347	Nut

INDEX	PART NO.	DESCRIPTION
21	GT 7303	Washer
22	GT 357	Spring
23	GT10010	Drive Shaft
24	GT 539	Shim
25	GT10053	Spacer
26	GT 7012	10 Tooth Sprocket
27	GT 517	Key
28	GT10240	Roller Chain
29	GT 501	Connecting Link
30	GT 1625	Wheel Flange
31	GT 516	Key
32	GT 390	Bearing
33	GT 7083	Flangette Plate
34	GT10441	RH Bearing Plate
35	GT10960	Bracket - Adjust
36	GT10023	Spacer
37	GT 7021	Brake Drum
38	GT 7032	Clamp
39	GT10021	Rear Axle
40	GT10022	Spacer
41	GT10440	LH Bearing Plate

ILLUSTRATION 5

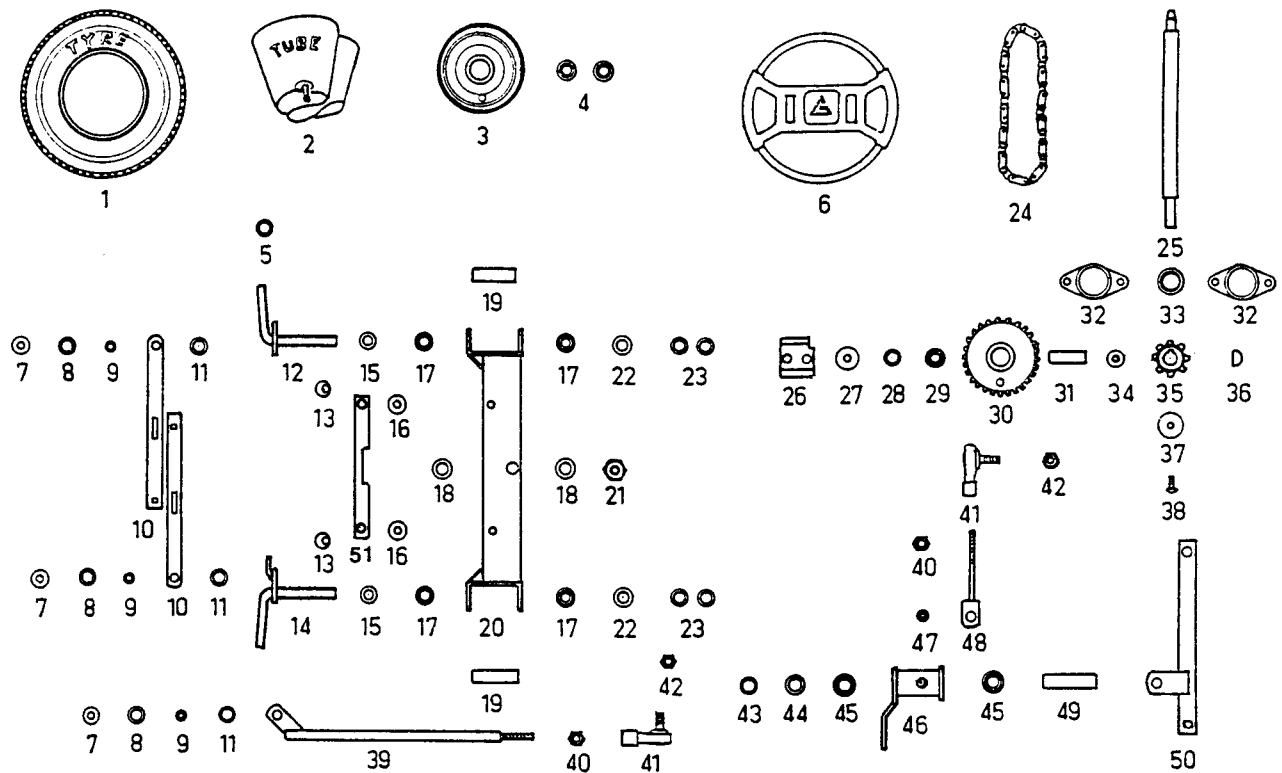

FRONT AXLE & STEERING

INDEX	PART NO.	DESCRIPTION
1	GT 455	Tyre
2	GT 456	Tube
3	GT 7007	Wheel Hub
4	GT 396	Bearing
5	GT 7009	Collar
6	GT 1785	Steering Wheel Complete
7	GT10488	Cup
8	GT 534	Felt Seal
9	GT10037	Pivot Bush
10	GT 6622	Tie Rod
11	GT10038	Nylon Washer
12	GT11020	L.H. King Pin
13	GT 8095	Steering Stop
14	GT10990	R.H. King Pin
15	GT 2018	Washer
16	GT 1660	Washer
17	GT 1766	Bush
18	GT10480	Washer
19	GT10439	Cover
20	GT11010	Axle Beam
21	GT 2042	Nut
22	GT 2014	Washer
23	GT 580	Retainer
24	GT 6876	Roller Chain Complete
25	GT10029	Steering Shaft

INDEX	PART NO.	DESCRIPTION
26	GT10484	Steering Stop
27	GT 1660	Washer
28	GT 579	Wave Washer
29	GT 6056	Bush
30	GT10025	Sprocket
31	GT10024	Sleeve
32	GT 7017	Flangette Plate
33	GT 2207	Bearing
34	GT 1025	Washer
35	GT 6046	Sprocket
36	GT 518	Key
37	GT 6355	Washer
38	GT 2421	Set Screw
39	GT10970	Drag Link
40	GT 2406	Nut
41	GT 6044	Tie Rod End
42	GT 2090	Nut
43	GT 2046	Crinkle Washer
44	GT10027	Spacer
45	GD 5525	Bush
46	GT10940	Steering Link
47	GT 730	Pivot Bush
48	GT10950	Steering Rod
49	GT10026	Sleeve
50	GT11120	Support
51	GT10524	Backing Strip

ILLUSTRATION 6

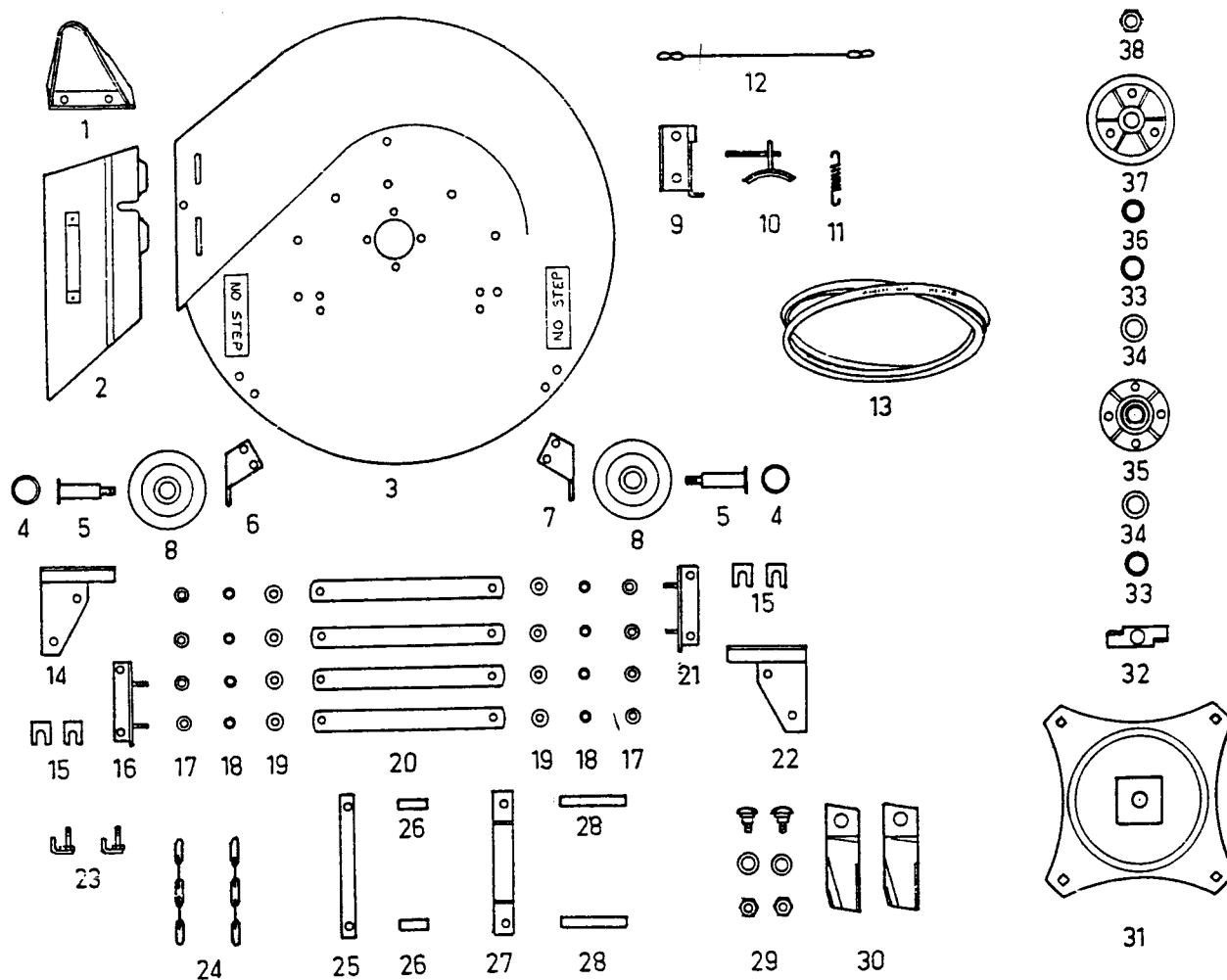

CUTTER DECK

INDEX	PART NO.	DESCRIPTION
1	GT 6631	Deck Skid
2	GT 8125	Stone Guard
3	GT10407	Cutter Deck
4	GT 1930	Wheel Cap
5	GT 1768	Shaft
6	GT 8210	L.H. Bracket
7	GT 8211	R.H. Bracket
8	GT 1638	Wheel Assembly
9	GT10401	Bracket
10	GT11801	Cutter Brake
11	GT 6124	Spring
12	GT10039	Pull Cable
13	GT10041	V Belt - Cutters
14	GT10860	L.H. Side Plate
15	GT10463	Shim
16	GT10830	L.H. Bracket
17	GT 579	Wave Washer
18	GT 730	Pivot Bush
19	GT 1012	Washer

INDEX	PART NO.	DESCRIPTION
20	GT10432	Lifting Link
21	GT10820	R.H. Bracket
22	GT10850	R.H. Side Plate
23	GT11290	Hook Bolt
24	GT10434	Lifting Chain
25	GT10486	Upper Belt Guide
26	GT10404	Upper Spacer
27	GT10403	Lower Belt Guide
28	GT10405	Lower Spacer
29	GT 2110	Blade Bolt Set
30	GT 2104	Blade
31	GT 8370	Disc and Spindle
32	GT 8205	Bearing Wiper
33	GT 635	Spacer
34	GT 589	Shield
35	GT 7988	Spindle Housing Unit
36	GT10034	Spacer
37	GT 6075	Pulley
38	GT 2003	Nut

ILLUSTRATION 7

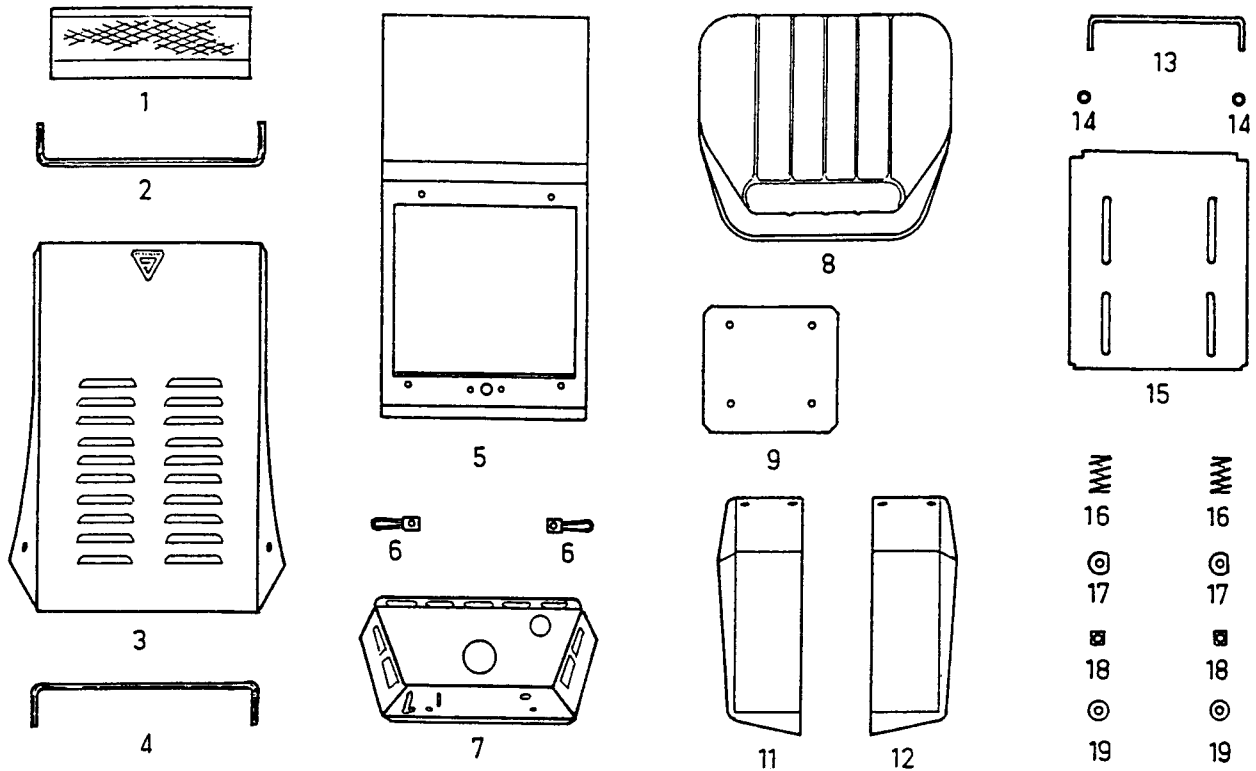

BODYWORK , COVERS & SEAT

INDEX	PART NO.	DESCRIPTION
1	GT10512	Grill
2	GT10478	Pinchweld Front
3	GT11831	Bonnet 12-32
3	GT11832	Bonnet 13-32
4	GT10479	Pinchweld Rear
5	GT11829	Rear Cover 12-32
5	GT11830	Rear Cover 13-32
6	GT 7015	Strap
7	GT11844	Steering Cowl 12-32
7	GT11834	Steering Cowl 13-32
8	GT 8063	Seat

INDEX	PART NO.	DESCRIPTION
9	GT10437	Backing Piece
10		
11	GT10780	LH Mudguards
12	GT10790	RH Mudguards
13	GT10417	Seat Hinge
14	GT 730	Pivot Bush
15	GT10416	Seat Base
16	GT10005	Spring
17	GT10452	Clamp
18	GT10451	Locating Block
19	GT 1660	Washer