

Greenfield

SP102

Evolution

Three

10.5 HP 30

12.5 HP 30

MODELS

12.5 HP 32

12.5 HP 38

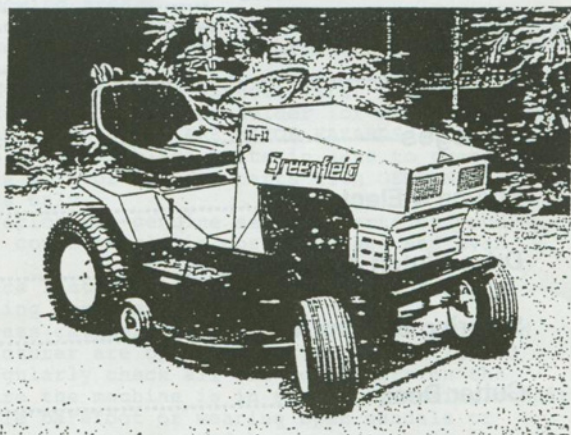

Instructions & Spare Parts

Greenfield Products Pty Ltd
172 Ingram Rd, Acacia Ridge, Q 4110 Australia
Fax (07) 344 1161 Phone (07) 345 6100

CONTENTS

Safety Instructions	1
Operating Instructions	2
Maintenance	
Blades & Belts	4
Maintenance	
Chains & Brakes	7
Electrical Circuits	8
Differential Instructions	9
Spare Parts	
Chassis	10
Linkages	11
Engine & Electrics	12
Drive Clutch & Rear Axle	13
Steering & Front Axle	14
Cutter Deck	15
Body Work & Seat	16
Service Record	17

Greenfield

Evolution

Thank you for buying an Australian made Greenfield mower. Follow the manufacturer's operating and maintenance instructions and many years of excellent trouble free service can be expected.

Before operating the mower read the owner's manual carefully. Do not allow children or any person unfamiliar with the safe operating procedure to operate this mower. Your Greenfield mower has been designed to meet stringent safety standards - but we remind you that a mower is a cutting device - used incorrectly it could cause personal injury.

SAFETY INSTRUCTIONS

1. Do not carry passengers.
 2. Know your controls. Read the operating instructions carefully. Learn how to stop the mower and the engine quickly in an emergency.
 3. Do not mow whilst people, especially children or pets are in the mowing area.
 4. Make sure the area to be mown is clear of sticks, stones, bottles, bones, wire and other debris which could be thrown by the blades.
 5. Do not operate the machine without first inspecting the blades, blade bolts and blade holder for wear or damage.
- DAMAGED BLADES AND WORN BOLTS ARE MAJOR HAZARDS
Always replace blades and blade bolts in sets to preserve balance. Replace worn or damaged parts with GENUINE GREENFIELD replacement parts only.
- N.B. Use of inferior non-genuine service parts on your Greenfield mower could result in costly damage and even personal injury.
Refer "Maintenance Instructions", for replacement part numbers and fitting instructions.
6. Check that grass catcher, guards and switches provided by the manufacturer are operating properly and fitted securely. Regularly check all the components on the mower to ensure the machine is in a safe operating condition.
 7. Never mow while barefoot or wearing open sandals or thongs. Wear long trousers and heavy shoes. It is also advisable to wear suitable eye protection.
 8. A mower operator should be in good physical and mental health and not under the influence of any drug or alcohol which might impair vision, co-ordination or judgement.
 9. Replace worn or faulty silencers.
 10. Keep the engine free of grass, leaves or excessive grease. These can be a fire hazard.
 11. Refuel outdoors only. Do not smoke while fuelling engine. Never remove the cap of the fuel tank or add petrol while the engine is running or the engine is hot. Remove fuel cap slowly to relieve any tank pressure. If petrol is spilled do not attempt to start the engine but move the machine away from the area of the spill and avoid creating any source of ignition until petrol vapours have dissipated.
 12. Check for fuel leaks, while refuelling or using the mower. If a fuel leak is detected, do not start the engine until the fuel leak is fixed and the spilled fuel is wiped away.

13. Do not operate the engine in a confined space where poisonous exhaust fumes (carbon Monoxide) can collect.
14. Always disengage the cutting means before starting the engine.
15. always mount the mower from the opposite side to the discharge chute.
16. Exercise extreme caution when on slopes. Reduce speed particularly when making sharp turns to prevent overturning or loss of control. Do not stop or start suddenly when mowing uphill or downhill.
17. Never operate a ride-on mower across the face of a slope.
18. Stay alert for holes in the terrain and other hidden hazards.
19. Before crossing paths, driveways or any other area foreign to mowers, disengage cutting blades and lift cutting attachment to maximum height.
20. Watch out for traffic when crossing or operating the mower near roadways.
21. When using any attachment, never direct discharge of material toward bystanders nor allow anyone near the machine while in operation.
22. Before leaving the operator's position -
 - a. disengage all clutches and secure cutting units.
 - b. apply the parking brake.
 - c. stop the engine and remove the key.
23. Stop the engine and disengage the drive to the attachments -
 - a. before refuelling.
 - b. before removing grass catcher or any attachment.
 - c. before making a height adjustment unless adjustment is being made from the operator's position.
 - d. before cleaning blockages.
 - e. before inspecting; cleaning or working on the mower.
 - f. after striking a foreign object (inspect the mower for damage and make necessary repairs before restarting and operating the machine)
 - g. if the machine starts to vibrate abnormally (check immediately)
24. Disengage drive to attachments when not in use or in transporting.
25. Do not over-speed the engine or alter governor settings. Excessive speed is dangerous and shortens the mower's life.
26. Use care when pulling loads or using attachments.
 - a. use only approved drawbar hitch points.
 - b. limit loads to those you can safely control.
 - c. do not turn sharply. Use care when backing up.
27. Store the mower in a well ventilated room away from naked flames such as may be found in hot water heaters.
28. Do not lend or sell the mower without the owner's manual.
29. WARNING - Remove spark plug lead to avoid accidental starting BEFORE attempting any maintenance or inspection of the mower.

OPERATING INSTRUCTIONS

BEFORE STARTING:

Fuel: Top with clean regular UNLEADED petrol only. Make sure the petrol is free from impurities. The petrol tank is located inside the engine compartment of your Greenfield. Raise the bonnet for access.

Engine Oil: Fill to the mark indicated on the dipstick. Don't overfill. For oil specification refer to "Crankcase Lubrication" in the maintenance section of this book.
Tyres: Inflate to the pressure indicated on the tyres. Don't over inflate.

TO START:

Disengage blade clutch (Cutters Out) Apply park brake. Turn on fuel tap. For cold starting set throttle control to "CHOKE", push starter button. If engine does not start, set throttle half way then press button again. Do not allow children or any person unfamiliar with the safe operating procedure to use this mower. Know your controls. Read the following instructions carefully. Learn how to stop the mower and the engine quickly in an emergency.

IMPORTANT - This Evolution Model Greenfield mower is fitted with a safety 'cut-out' switch activated by the seat. The operator must be seated to start the engine and remain seated while operating the mower.

Foot Pedal: A simple pivoted foot pedal controls forward, neutral and reverse. Increased toe or heel pressure provides speed variation in forward or reverse respectively. Allow pedal to centralise for neutral. (The pedal also doubles as a brake by applying toe or heel pressure opposite to the directional movement of the mower.) Sudden directional changes and/or wheel spinning must be avoided.

Park Brake: The park brake lever is located in front of the right side rear mudguard, this lever has two positions, shift lever out and rearwards to engage park brake.

To disengage, shift lever out and forward. The sprung loaded mechanism will self engage when mower is moved slightly forward or backwards. Can also be used as an emergency brake.

Cutting Height: The height adjusting lever located in the control console enables the operator to select the desired cutting height. To change cutting height, pull lever to the right then slide up or down to the selected setting.

Blade Clutch: The blade clutch lever is located on the cutter deck alongside the right hand running board. To engage cutting blades shift this lever to the "IN" position. To disengage cutting blades shift the lever to the "OUT" position.

Seat: The operator's seat is adjustable front to rear. To adjust, hinge seat forward, loosen four seat securing bolts, slide seat to position required and retighten bolts.

TO STOP:

Apply park brake, disengage cutter blades (cutter out) allow engine to cool down by idling approximately 30 seconds before switching off. Set throttle control to "STOP" position, turn petrol tap off (if fitted).

MAINTENANCE

WARNING: Remove the spark plug lead to avoid accidental starting BEFORE attempting any maintenance or inspection if the mower.

CRANKCASE LUBRICATION: Change engine oil after the first 5 hours of operation then every 15 working hours thereafter. Change more often in heavy or dusty conditions. Drain engine oil whilst engine is hot then replace with a quality S.A.E. 30 S.F. motor oil or refer to the Engine Manufacturers Operating booklet oil recommendations. Fill to the mark indicated on the dipstick. Don't OVERFILL. To check oil level, place the mower on level ground, remove dipstick and wipe clean. Replace dipstick screwing correctly into position. Remove again and sight oil level. Dipstick must be firmly in place when engine is running.

AIR FILTER: Service air filter as per the engine manufacturers booklet. Clean more often in dusty conditions. Never operate the engine without the air filter correctly and securely fitted.

COOLING SYSTEM: Remove the blower housing and clean out the grass and debris to prevent overheating. Refer to engine manufacturers booklet.

BATTERY: Top with distilled water to the correct level as required. If externally charging, care is needed. Remove the negative battery terminal and TRICKLE CHARGE ONLY to avoid battery damage.

WARNING: Do not let the battery discharge during winter, trickle charge regularly.

WHEELS: The rear wheel nuts should be re-tensioned after the first 5 hours of operation, then regularly with your preventative maintenance checks.

TYRES: Inflate to pressure indicated on the tyres. Don't over inflate.

BELTS: Inspect the V belts regularly and replace if damaged. Part Numbers for V belts are -

Drive V Belt GT12004	38" Cutters V Belt GT2705
32" Cutters V Belt GT376	38" Spindles V Belt GT2704

BLADES: Check the condition of blades, blade bolts and blade holder. Replace if damaged or worn. Damaged blades or worn bolts are major hazards. Always replace worn or damaged blades or bolts in sets to preserve balance. Use only GENUINE Greenfield replacement parts. Use of inferior non-genuine service parts on your Greenfield could result in costly damage or even personal injury. Insist on genuine parts branded Greenfield.

Part numbers for Blades and Bolts are

32" Cutter Blade and Bolt Set GT2139
32" Cutter Blade Set GT2138
38" Cutter Blade and Bolt Set GT2144
38" Cutter Blade Set GT2145

To fit new blades refer to Diagram A. Tighten the blade bolt nuts firmly. Correct torque is 44Nm. (32ft. lbs)
Blades must be free to turn but not loose.

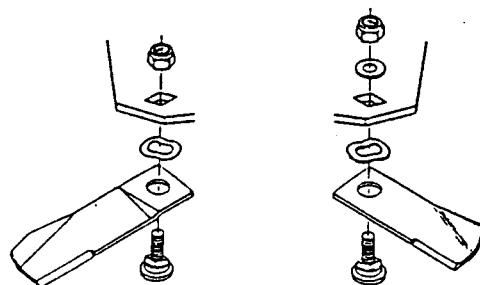

diagram A
32" cut

Diagram A
38" cut

CHASSIS LUBRICATION: Your Evolution 3 Greenfield mower has 5 greasing points. A grease nipple is fitted to each king pin, one each side of the front axle beam. A grease nipple is fitted to the steering link and is accessible from under the chassis next to the drive control pedal. A grease nipple is fitted to the steering shaft tube located behind the steering cowl and easily reached from the engine area. A grease nipple is also fitted to the lifting shaft which supports the cutter deck, this nipple is accessible through an opening in the frame with the rear cover removed. Don't use a high pressure grease gun.

Apply a light coating of grease to the slide bush area on the notch bar bracket and to both slide rails on the cutter clutch unit mounted on the rear of the cutter deck. Service these locations as required with CASTROL LMM chassis grease or equivalent. All other exposed pivoting joints to be lubricated with engine oil. The rear drive chain should be removed, cleaned in kerosene and recoiled with CASTROL chain oil. Refit and adjust the drive chain as per "Rear drive chain adjustment" instruction.

TO REMOVE DRIVE V BELT:

1. Remove the spark plug lead to prevent accidental starting.
2. Hinge up the seat and disconnect the wire to the seat cut out switch. Remove rear cover.
3. Lower the blade height to the "LOW" position.
4. Swing back the bracket supporting the rear clutch link.
5. Remove the retaining clip from the back end of the clutch yoke. Lift off rear clutch link and swing rearward.
6. With the spring release hook tool, remove the tension spring from the idler pulley notch bar.
7. Release the notch bar leaf spring by inserting the hook tool between the tab on inside edge of the notch bar and the leaf spring, rotate the hook tool and hold leaf spring in a released position to allow the idler pulley to slide freely rearwards to permit belt removal.
8. To remove the drive V belt from the engine pulley the cutter V belt must first be removed. Follow steps No 1, 2 and 3 of "To remove cutter V belt" instructions. Now remove the drive V belt from the engine pulley.
9. Lift the drive V belt off both flat idler pulleys and remove the belt through the opening at the rear clutch link.

TO REPLACE DRIVE V BELT:

1. Feed the belt down the back of the clutch pulleys and onto the top groove of the engine pulley.
If the cutter V belt is in position on the engine pulley remove the belt by following steps No 1, 2 and 3 of "To remove cutter V belt" instructions.
2. Fit the belt into both clutch pulleys then into the idler pulley on the notch bar, this pulley will need to be in the fully rearward position.
3. Fit the belt over both flat idler pulleys.
4. Replace the notch bar tension spring using the hook tool.
5. Replace the rear clutch link and the retaining clip.
Reposition the support around the rear clutch link.
6. Refit the cutter V belt into the bottom groove of the engine pulley by following step No 2 of "To replace cutter V belt" instructions.

7. Replace the rear cover and reconnect the wire to the seat cut out switch.

TO REMOVE CUTTER V BELT:

1. Remove the spark plug lead to prevent accidental starting
2. Lower the blade height to the "LOW" position and disengage the cutters, blade clutch "OUT"
3. Remove the V belt from the engine pulley by manoeuvring the belt down between the pulley and belt guide pins.
4. Using 3/8" B.S. spanners remove the fixed clutch pulley and belt guide and the sliding clutch pulley and belt guide located on the cutter deck.
5. Remove the belt guide from the cutter pulley by loosening the nuts on each side and removing the nut at the front of the belt guide.
6. Remove the belt from the machine.

TO REPLACE CUTTER V BELT:

1. Refit the idler pulleys to the mounting brackets in this order - Insert the bolt through the bracket. Position the belt guard over the bolt against the bracket with a guard wing at the top, bottom and rear. The bearing adaptor, large end first then slips over the bolt. While holding the V belt into the pulley groove slide the pulley over the bolt and onto the bearing adaptor. "Note that the heavy cast iron pulley is fitted onto the left side of machine" With the wings of the guard over the belt and pulley fit the thick flat washer and nyloc nut. Retighten using two spanners.
2. Fit the belt to the bottom groove of the engine pulley ensuring belt is inside belt guide pins then to the cutter pulley.
3. Replace the belt guide around the cutter pulley and tighten the nyloc nuts.
4. Replace the spark plug lead. Run engine and engage cutters to check V belt operation.
5. NOTE A belt run in period is required as follows - With height adjusting lever in green band (position 4, 5 or 6) engage cutter blades for approximately ten minutes.

CUTTER BELT ADJUSTMENT

With the cutter clutch lever in the "OUT" position the cutter belt should be sufficiently disengaged to allow the cutter blades to come to a complete stop in approximately 7 seconds. The correct amount of belt slack and the efficient operation of the cutter brake control this stopping time. A spring loaded idler pulley maintains the correct belt tension when the blade clutch lever is in the "IN" position.

The left side cutter belt idler pulley can be adjusted to allow for belt stretch. The first adjustment should be required after approximately 5 hours of operation with further adjustments after approximately 50 hours. This left side pulley bracket has five bolt hole positions available plus a sliding adjustable base.

To adjust belt, loosen two 5/16" B.S. nyloc nuts on the pulley bracket base and slide bracket rearwards, retighten nuts. Unless some wear to the pulley is evident or extraordinary belt stretch is experienced adjustment to the sliding bracket only should suffice.

Should this pulley need repositioning in another hole, replace pulley by following Step No 1 of "To replace Cutter Belt" instruction. When a new belt is fitted this pulley should be fitted in the centre hole and the sliding bracket reset to maximum forward position.

The manufacturer recommends all Greenfields be returned to an authorised Greenfield dealer for normal servicing i.e. oil changes, air filters etc. at the times indicated in the maintenance section and by the engine manufacturer. The manufacturer also recommends a maintenance and safety inspection be performed biannually or every 50 working hours by an authorised Greenfield dealer. To comply with conditions for both standard and extended warranty offered by the manufacturer refer to the warranty leaflet.

STEERING ADJUSTMENT

To remove excess slack from the steering chain -

1. Remove spark plug lead to prevent accidental starting
2. Disconnect wire to seat cut out switch and remove rear cover.
3. Loosen the 5/16 B.S. nyloc nut on the chain arm adjuster. With fingers only pull the arm away from the steering shaft, no force is required. Do not overtighten - the chain must have 3mm of slack. Refer diagram B
4. Retighten nyloc nut. Replace the rear cover and reconnect the seat cut out switch. Replace the spark plug lead.

PARK BRAKE ADJUSTMENT

1. Check that the brake arm moves freely on the pivot bush by swinging arm forward against spring.
2. Check clearance between the brake arm and the brake disc in the "OFF" position is 3mm. Refer diagram C
3. With the brake lever in the "ON" position check the brake arm lug fully engages into the recess in the brake disc.

REAR DRIVE CHAIN ADJUSTMENT

1. Unlock the rear nuts on both rear axle flangette bearing mounting plates.
2. When adjusting, it is very important that the rear axle remains parallel to the mower chassis. Therefore the adjustment nuts positioned below the rear axle side plates should each be turned no more than a quarter of a turn at a time alternating between the two till the chain has 3mm of slack. Don't overtighten. Refer to diagram B
3. Retighten both nuts on rear axle flangette bearing mounting plates.
4. Check that the brake arm engages fully into park brake disc and the brake arm clearance in the off position is correct. Refer to "Park Brake Adjustment".

STEERING & REAR DRIVE

PARK BRAKE ADJUSTMENT

CHAIN ADJUSTMENT

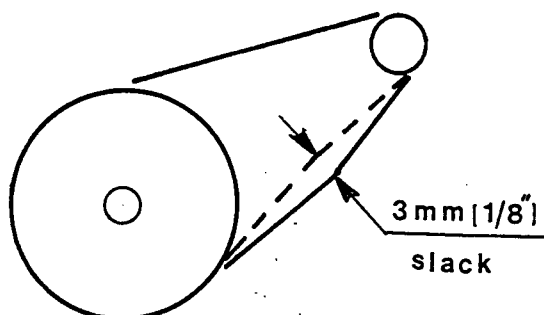

Diagram B

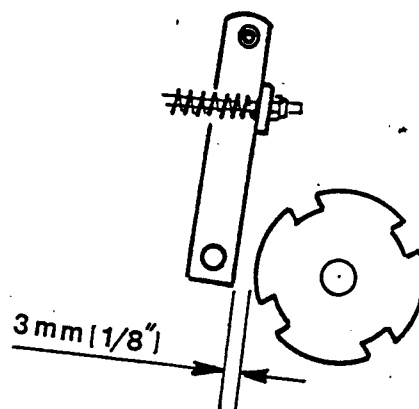
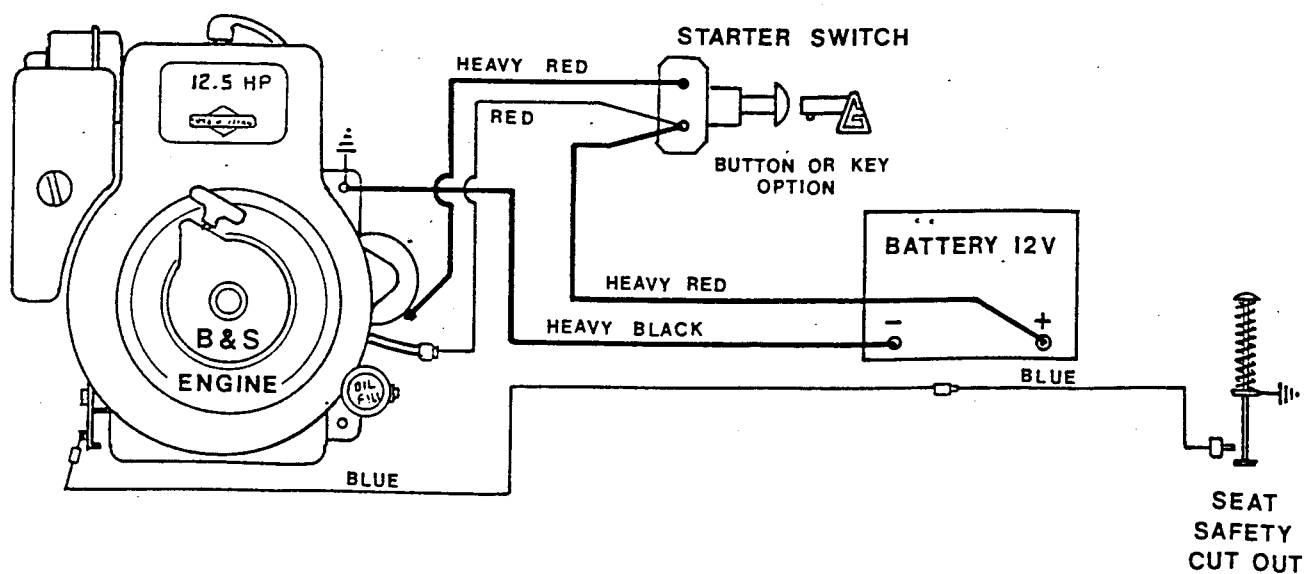

Diagram C

ELECTRICAL CIRCUIT



OPERATING AND SAFETY INSTRUCTIONS FOR MACHINES FITTED WITH DIFFERENTIAL.

This Greenfield EVOLUTION Mower features a revolutionary new type differential. This differential offers the operator the option of the full differential action of the rear wheels necessary for fine lawns, or the ability to "lock out" the differential when operating on slopes or uneven terrain.

With the differential operating, climbing hill, particularly diagonally across slopes, can, in some situations be unsafe. This is due to the operation of a differential. When one wheel loses traction the vehicle will stop. With the differential "lock out" engaged, potentially dangerous situations are eliminated because both wheels are continually driving. The mower now has the ability to continue its forward motion up or across the slope removing any necessity to reverse down slopes.

When requiring the rear wheels to differential, the "lock out" mechanism located in the left side rear hub is pulled out with the wire handle and held out by placing handle over end of shaft.

When the locked differential is required, release the handle from end of shaft, the sprung loaded "lock out" mechanism will self engage when the machine is rolled slowly forward with steering wheel turned fully either to right or left.

Do not attempt this procedure from the operators seat or while engine is running.

If for any reason the left side rear wheel needs to be removed, the "lock out" mechanism should first be engaged, this enables the wheel hub to pass over mechanism. When replacing wheel, check that sliding block freely slides into engagement plate before finally tightening wheel-nuts.

If in the unlikely event a differential does fail, the unit should be returned to the manufacturer intact. Units which have been previously dismantled will not be considered for warranty.

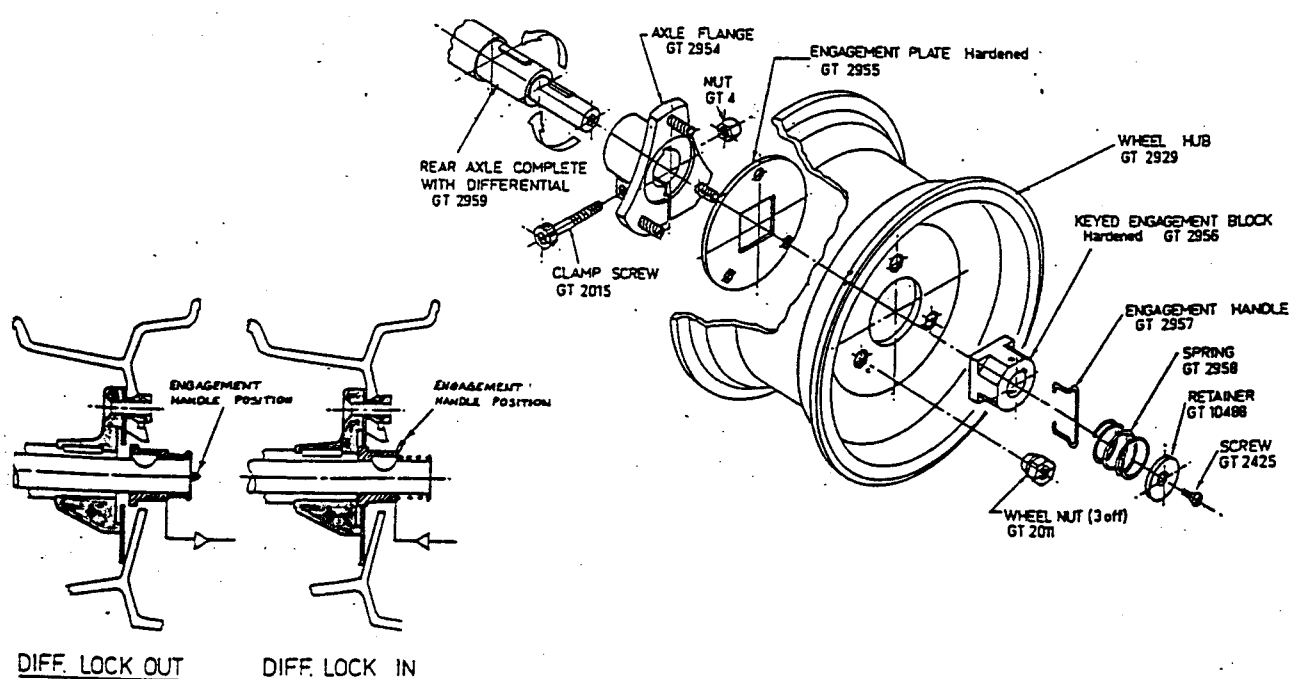
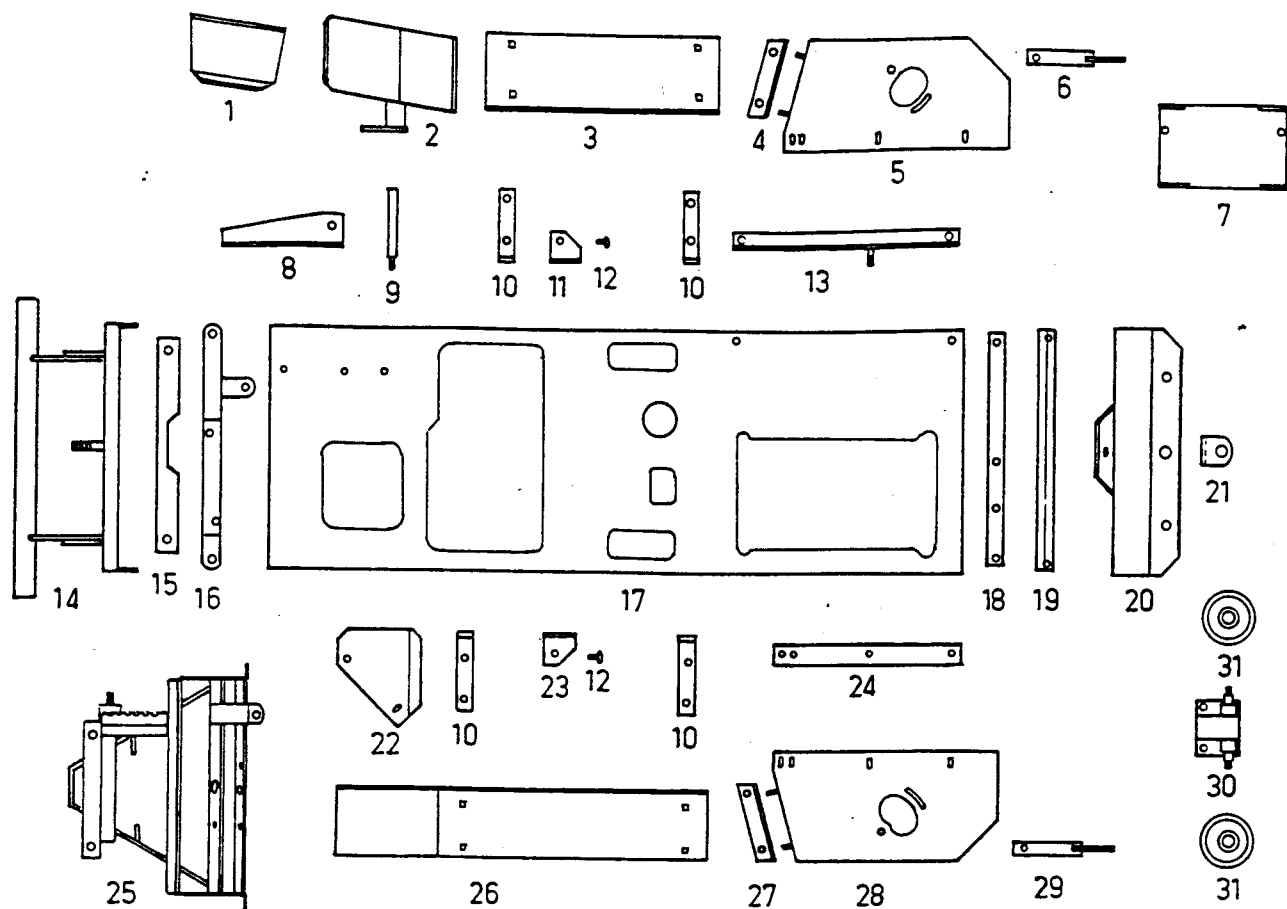

Illustration 1



CHASSIS

INDEX	PART NO.	DESCRIPTION	INDEX	PART NO.	DESCRIPTION
1	GT 12365	Heat Shield	18	GT 12335	Stiffener
2	GT 13040	F-R Foot Pedal	19	GT 12316	Brace
3	GT 12314	R.H. Running Board	20	GT 13130	Rear Panel
4	GT 12960	R.H. Pivot Bracket	21	GT 12338	Tow Bar Bracket
5	GT 13120	R.H. Side Plate	22	GT 12336	Heat Shield L.H.
6	GT 13170	Chain Adjuster .	23	GT 7115	L.H. Bracket
7	GT 13150	Battery Tray	24	GT 12326	Packing Piece
8	GT 12331	Bracket Pedal Support	25	GT 12750	Steering Bracket
9	GT 12042	Shaft - Pedal	26	GT 12313	L.H. Running Board
10	GT 12312	Support Running Board	27	GT 13260	L.H. Pivot Bracket
11	GT 7114	R.H. Bracket	28	GT 13110	L.H. Side Plate 30" Model
12	GT 1760	Nylon Button	28	GT 13090	L.H. Side Plate 32" Dlx Model
13	GT 13240	Support Brace	29	GT 13170	Chain Adjuster 30" Model
14	GT 12620	Front Bumper and Plate	29	GT 13160	Chain Adjuster 32" Dlx Model
15	GT 10524	Backing Strip	30	GT 13190	Idler Pulley Bracket
16	GT 12890	Support Bracket	31	GT 1009	Idler Pulley
17	GT 12610	Main Frame			

Note: Standard hardware items are not shown

Illustration 2

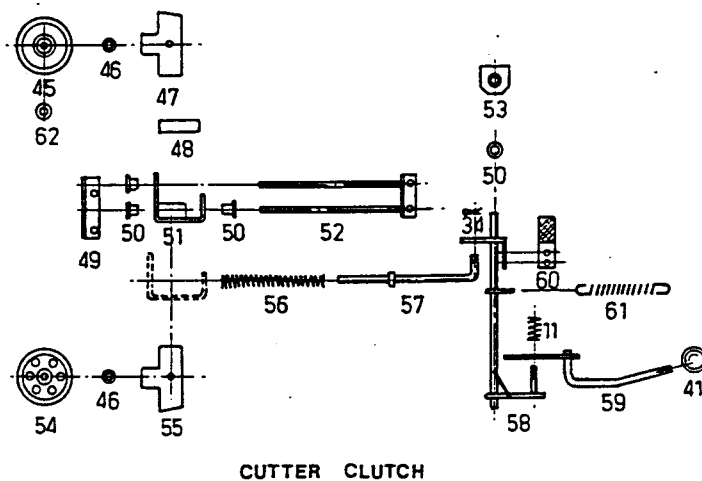
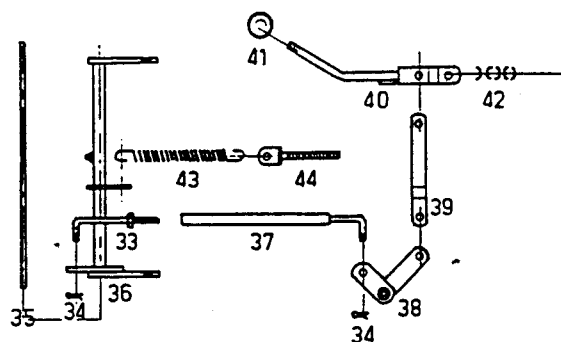
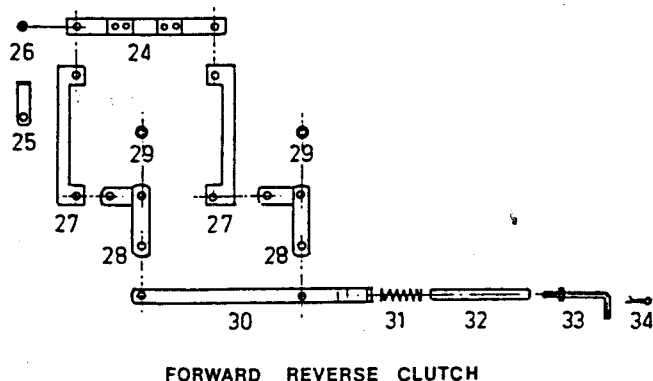
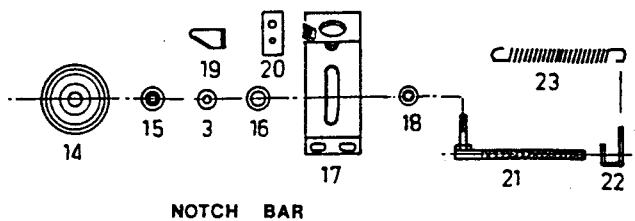
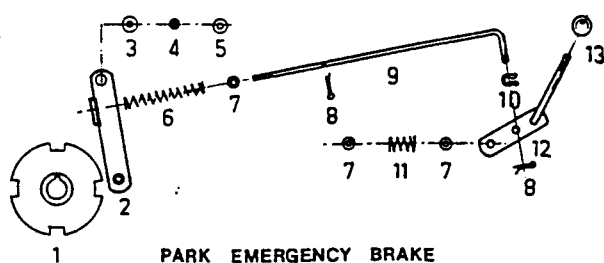

LINKAGE

INDEX	PART NO.	DESCRIPTION	INDEX	PART NO.	DESCRIPTION
1	GT 13250	Park Brake Disc	32	GT 12005	F-R Rod
2	GT 13350	Brake Arm	33	GT 8227	Adjusting Arm
3	GT 579	Wave Washer	34	GT 165	Split Pin
4	GT 730	Pivot Bush	35	GT 10011	Shaft
5	GT 1025	Washer	36	GT 13060	Height Adjust. Tube
6	GT 12032	Spring	37	GT 13070	Height Adjust. Link
7	GT 1035	Washer	38	GT 13050	Pivot Arm
8	GT 167	Split Pin	39	GT 13080	Link
9	GT 12360	Brake Rod	40	GT 12770	Lifting Handle
10	GT 144	Circlip	41	GT 1565	Knob
11	GT 7071	Spring	42	GT 1567	Spring Washer
12	GT 13220	Brake Lever	43	GT 6030	Spring
13	GT 524	Knob	44	GT 12930	Tensioner
14	GT 7965	V Pulley	45	GT 6868	V Pulley Complete
15	GT 610	Bearing Adaptor	46	GT 6018	Bearing Adaptor
16	GT 23	Washer	47	GT 12670	L-H Belt Guide
17	GT 12332	Bracket	48	GT 12358	PVC Cover
18	GT 608	Slide Bush	49	GT 13310	Bracket
19	GT 6432	Release Lever	50	GD 5525	Bush
20	GT 640	Leaf Spring	51	GT 13803	Sliding Bracket Complete
21	GT 6434	Notch Bar	52	GT 12730	Rail Bracket
22	GT 7308	Spring Anchor	53	GT 12305	Bracket
23	GT 1554	Spring	54	GT 6901	V Pulley
24	GT 13833	Yoke Unit Complete	55	GT 13030	R-H Belt Guide
25	GT 12356	Steady	56	GT 12008	Spring
26	GT 2010	Circlip	57	GT 12740	Rod
27	GT 12306	Clutch Link	58	GT 13370	Cutter Clutch Shaft
28	GT 10640	Pivot Arm	59	GT 13360	Handle
29	GT 10006	Pivot Bush	60	GT 13801	Cutter Brake
30	GT 12319	F-R Control Link	61	GT 9090	Spring
31	GT 6141	Spring	62	GT 395	Bearing

Note: Standard hardware items are not shown.

Illustration 3

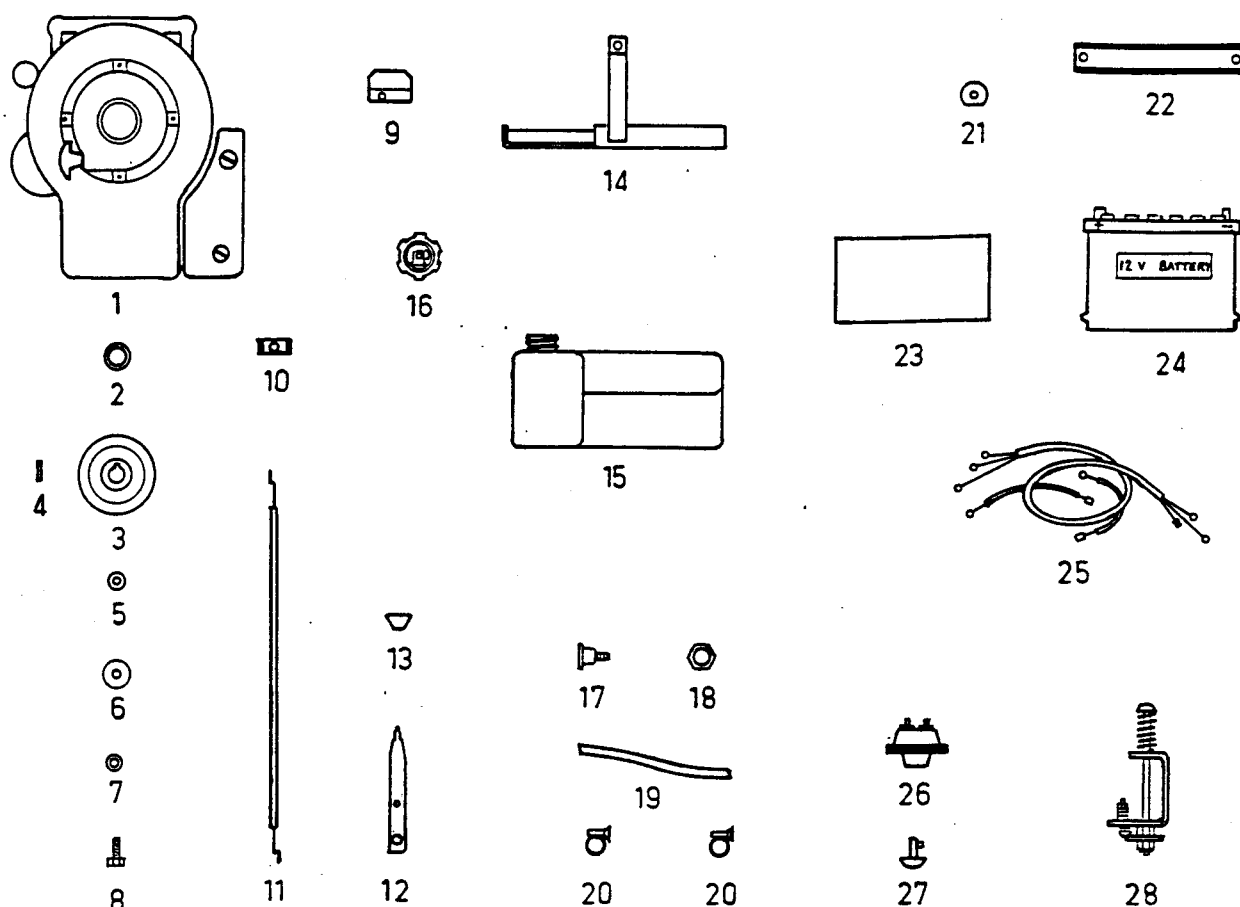

ENGINE & ELECTRICS

INDEX	PART NO.	DESCRIPTION	INDEX	PART NO.	DESCRIPTION
1	GT 2208	Engine	15	GT 6027	Fuel Tank
2	GT 12034	Spacer	16	GT 6031	Cap - Fuel Tank
3	GT 12025	Pulley	17	GT 10043	Hose Tail
4	GT 4121	Key	18	GT 10044	Nut
5	GT 12022	Extension	19	GT 12343	Hose
6	GT 1750	Washer	20	GT 2024	Clamp
7	GT 2021	Spring Washer	21	GT 12345	Insulator + Terminal
8	GT 2044	Bolt	22	GT 12329	Battery Clamp
9	GT 12344	Exhaust Deflector	23	GT 12330	Rubber Mat
10	GT 1252	Cable Clamp	24	GT 1914	Battery
11	GT 13804	Throttle Cable	25	GT 13806	Wiring Harness
12	GT 12353	Throttle Lever	26	GT 1915	Starter Switch
13	GT 2025	Knob	27	GT 1995	Starter Button
14	GT 12820	Fuel Tank Support	28	GT 11809	Seat Switch Unit

Note: Standard hardware items are not shown.

Illustration 4

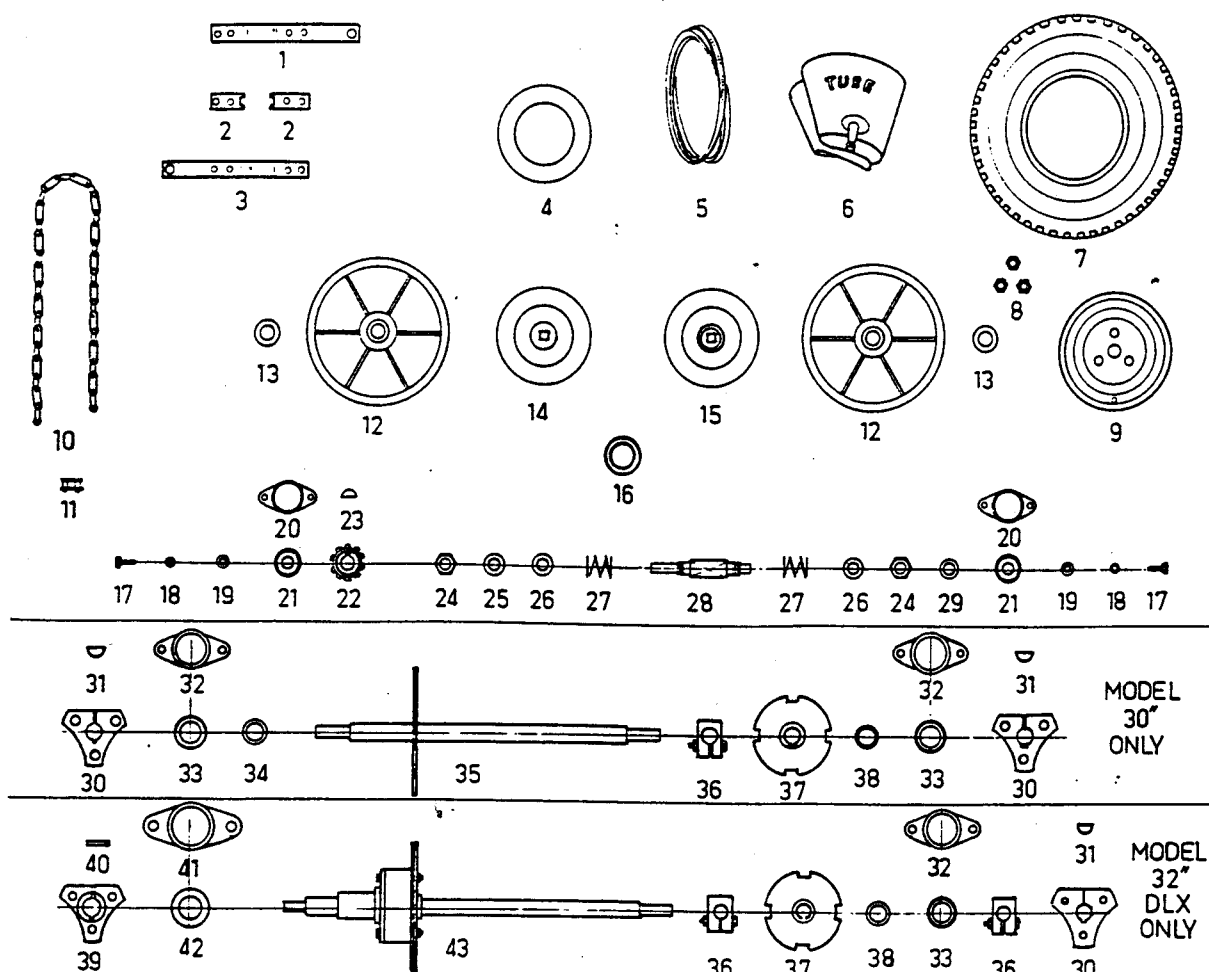

DRIVE CLUTCH & REAR AXLE

INDEX	PART NO.	DESCRIPTION	INDEX	PART NO.	DESCRIPTION
1	GT 10620	Yoke Top Half	21	GT 7010	Bearing
2	GT 12364	Retainer	22	GT 12020	11 Tooth Sprocket
3	GT 10630	Yoke Bottom Half	23	GT 517	Key
4	GT 6012	Clutch Lining	24	GT 347	Nut
5	GT 12004	Special V Belt - Drive	25	GT 539	Shim
6	GT 10002	Tube Model 30"	26	GT 7303	Washer
6	GT 1535	Tube Model 32" Dlx	27	GT 357	Spring
7	GT 10001	Tyre Model 30"	28	GT 10010	Drive Shaft
7	GT 1203	Tyre Model 32" Dlx	29	GT 7304	Washer
8	GT 2001	Wheel Nut	30	GT 1625	Wheel Flange
9	GT 1624	Wheel Hub	31	GT 516	Key
9	GT 2929	Wheel Hub Model 32 Dlx Left Side	32	GT 7083	Flangette Plates
10	GT 12041	Roller Chain	33	GT 390	Bearing
11	GT 501	Connecting Link	34	GT 12018	Spacer Long
12	GT 920	Clutch Pulley Complete	35	GT 12016	Rear Axle and Sprocket
13	GT 2206	Bearing	36	GT 7032	Clamp
14	GT 6855	L.H. Drive Plate	37	GT 13250	Park Brake Disc
15	GT 6856	R.H. Drive Plate	38	GT 9013	Spacer Short
16	GT 855	Bearing	39	GT 2954	Wheel Flange
17	GT 1455	Set Screw	40	GT 2995	Key
18	GT 2052	Spring Washer	41	GT 2210	Flangette Plates
19	GT 7306	Washer	42	GT 2209	Bearing
20	GT 7017	Flangette Plate	43	GT 2959	Rear Axle and Differential Unit

Note: Standard hardware items are not shown.

Illustration 5

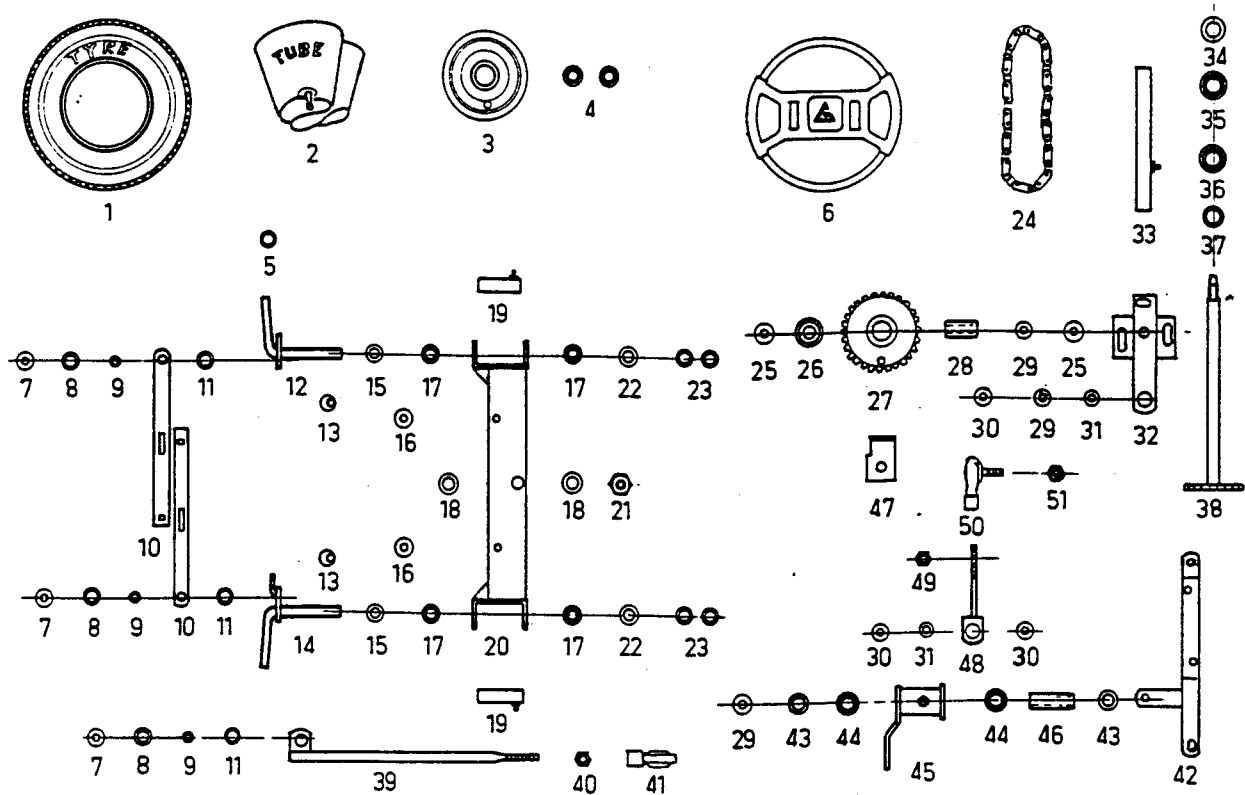

STEERING & FRONT AXLE

INDEX	PART NO.	DESCRIPTION	INDEX	PART NO.	DESCRIPTION
1	GT 455	Tyre	27	GT 10025	Sprocket
2	GT 456	Tube	28	GT 10024	Sleeve
3	GT 7007	Wheel Hub	29	GT 579	Wave Washer
4	GT 396	Bearing	30	GT 1012	Washer
5	GT 7009	Collar	31	GT 730	Bush
6	GT 1785	Steering Wheel Complete	32	GT 13320	Arm Chain Adjuster
7	GT 10488	Cup	33	GT 12315	Cover
8	GT 534	Felt Seal	34	GT 7009	Collar
9	GT 10037	Pivot Bush	35	GT 1766	Bush
10	GT 12366	Tie Rod	36	GT 6056	Bush
11	GT 10038	Nylon Washer	37	GT 12029	Spacer
12	GT 12860	L.H. King Pin	38	GT 13140	Steering Shaft & Sprocket
13	GT 8095	Steering Stop	39	GT 12880	Drag Link
14	GT 12850	R.H. King Pin	40	GT 1436	Nut
15	GT 2018	Washer	41	GT 1626	Tie Rod End
16	GT 1660	Washer	42	GT 12890	Support Bracket
17	GT 1766	Bush	43	GT 23	Washer
18	GT 10480	Washer	44	GD 5525	Bush
19	GT 10439	Cover	45	GT 12840	Steering Link
20	GT 12630	Axle Beam Model 30"	46	GT 12011	Sleeve
20	GT 13410	Axle Beam Model 32"	47	GT 12357	Chain Retainer
21	GT 2042	Nut	48	GT 12870	Steering Rod
22	GT 2014	Washer	49	GT 2406	Nut
23	GT 580	Retainer	50	GT 6044	Tie Rod End
24	GT 13813	Roller Chain Complete	51	GT 2090	Nut
25	GT 1025	Washer			
26	GT 6056	Bush			

Note: Standard hardware items are not shown

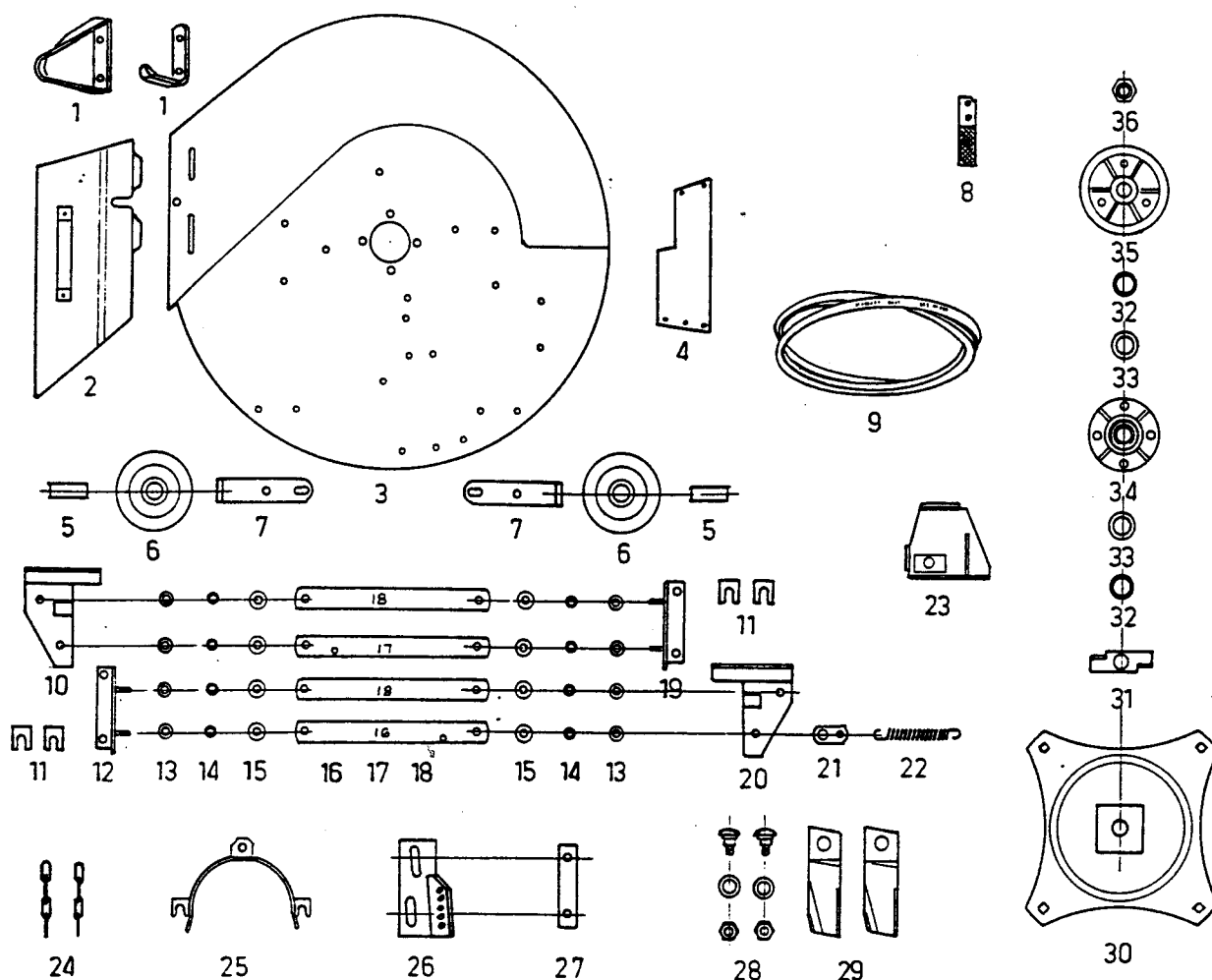

CUTTER DECK

INDEX	PART NO.	DESCRIPTION	INDEX	PART NO.	DESCRIPTION
1	GT 12363	Deck Skid Model 30"	19	GT 12960	R.H. Pivot Bracket
1	GT 6631	Deck Skid Model 32" Dlx	20	GT 12970	R.H. Side Plate
2	GT 8125	Stone Guard	21	GT 12323	Spring Anchor
3	GT 12350	Cutter Deck Model 30"	22	GT 9090	Spring
3	GT 12349	Cutter Deck Model 32" Dlx	23	GT 12990	Latch - Cutter Clutch
4	GT 12348	Infill Model 32" Dlx Only	24	GT 12346	Lifting Chain
5	GT 8501	Bush	25	GT 13210	Belt Guide
6	GT 12010	Jockey Wheel	26	GT 13270	Fixed Pulley Bracket
7	GT 12362	Bracket	27	GT 13280	Bolt Retainer
8	GT 13801	Cutter Brake	28	GT 2110	Blade Bolt Set
9	GT 376	Special V Belt - Cutters	29	GT 2139	Blade Set
10	GT 13340	L.H. Side Plate	30	GT 13180	Disc and Spindle Model 30"
11	GT 10463	Shim (When required)	30	GT 13010	Disc and Spindle Model 32" Dlx
12	GT 13260	L.H. Pivot Bracket	31	GT 8205	Bearing Wiper
13	GT 579	Wave Washer	32	GT 635	Spacer
14	GT 730	Pivot Bush	33	GT 589	Shield
15	GT 1012	Washer	34	GT 13815	Spindle Housing Unit Complete
16	GT 12940	L.H. Top Link	35	GT 12014	Pulley
17	GT 12950	R.H. Top Link	36	GT 2003	Nut
18	GT 7406	Bottom Link			

Note: Standard hardware items are not shown.

Illustration 7

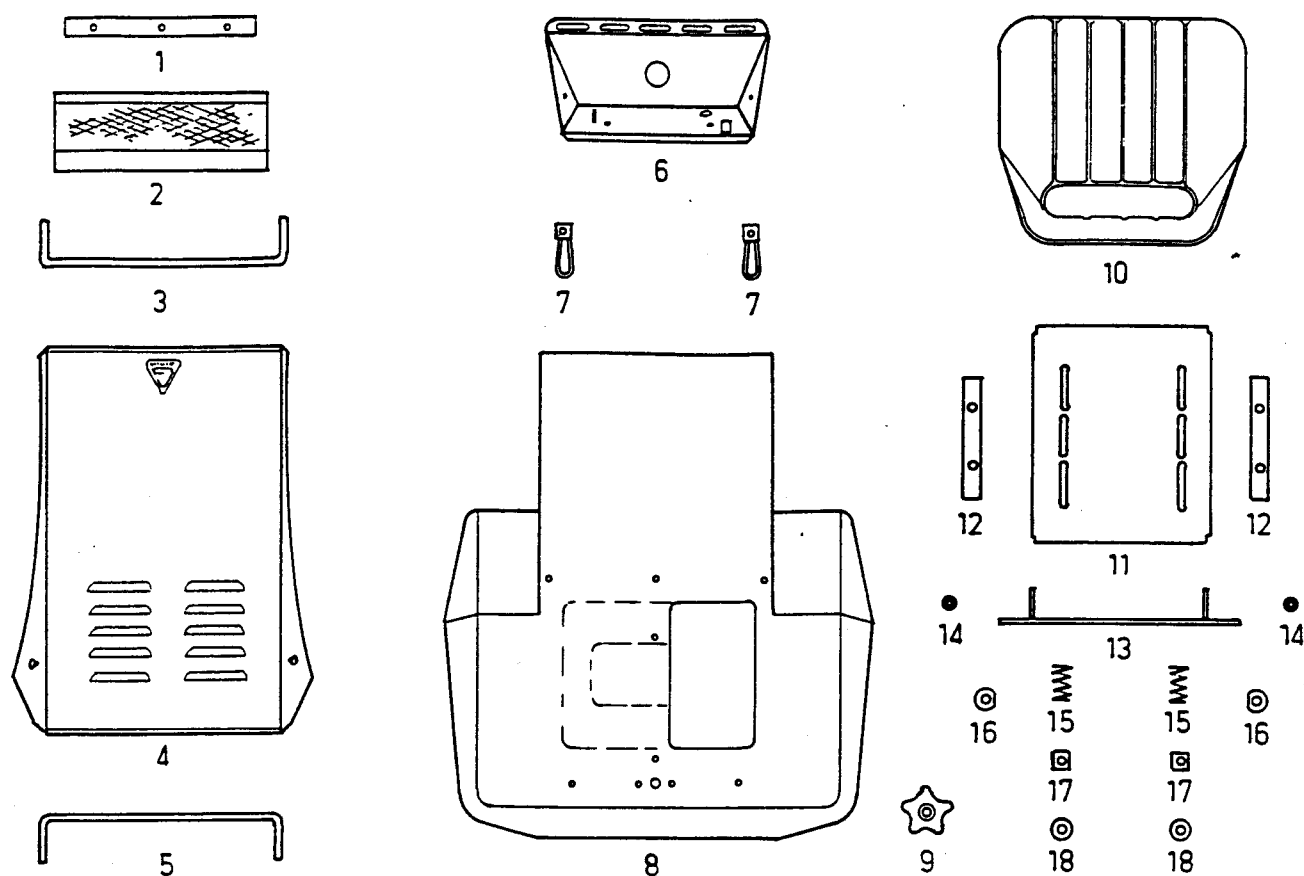
**BODYWORK & SEAT**

INDEX	PART NO.	DESCRIPTION	INDEX	PART NO.	DESCRIPTION
1	GT 10513	Strip	9	GT 13807	Knob - Rear Cover
2	GT 10512	Grille	10	GT 2211	Seat Model 30"
3	GT 12354	Pinchweld Front	10	GT 8064	Seat Model 32" Dlx
4	GT 12650	Bonnet Bare	11	GT 12310	Seat Base
4	GT 13832	Bonnet Complete Model 30"	12	GT 10508	Packing
4	GT 13830	Bonnet Complete Model 32" Dlx	13	GT 12710	Seat Hinge
5	GT 12355	Pinchweld Rear	14	GT 730	Pivot Bush
6	GT 13824	Steering Cowl	15	GT 10005	Spring
7	GT 7015	Strap	16	GT 10452	Clamp
8	GT 13290	Rear Cover Bare	17	GT 10451	Locating Block
8	GT 13825	Rear Cover Complete Model 30"	18	GT 1660	Washer
8	GT 13826	Rear Cover Complete Model 32" Dlx			

Note: Standard hardware items are not shown

SUPPLEMENTARY DETAILS FOR MACHINES FITTED WITH A 38" CUTTING DECK

PART NO	DESCRIPTION
GT2790	CUTTER DECK HOUSING MODEL 38"
GT2760	DISC AND SPINDLE
GT2144	CUTTER BLADE & BOLT SET
GT2145	CUTTER BLADE SET
GT7984	SPINDLE HOUSING UNIT
GT 589	BEARING SHIELD
GT 635	SPACER
GT2735	BEARING WIPER
GT2781	SPACER - PULLEY
GT2706	V PULLEY - CUTTER SPINDLE
GT2800	STUB SHAFT ASSY
GT2822	DOUBLE PULLEY UNIT (COMPLETE)
GT2728	ARM ASSY - FLAT IDLER PULLEY
GT2821	FLAT IDLER PULLEY (COMPLETE)
GT1554	TENSION SPRING
GT2741	SLIDE BAR ASSY
GT2770	CUTTER CLUTCH HANDLE ASSY
GT1766	NYLON BUSH
GT6030	TENSION SPRING
GT12930	SPRING TENSIONER
GT2742	L.H. ENGAGING ARM
GT2745	R.H. ENGAGING ARM
GT2736	STABILISER ARM
GT2820	CUTTER BRAKE ARM UNIT
GT2723	BELT GUARD ASSY
GT2815	LIFTING CHAIN ASSY
GT12010	JOCKEY WHEEL
GT8501	BUSH - JOCKEY WHEEL
GT2705	CUTTER V BELT
GT2704	SPINDLE V BELT
GT13620	ARM SUPPORT ASSY FOR ATTACHING CUTTER DECK
GT12373	LOWER LINK " " " "
GT13630	UPPER LINK " " " "