

SP104

# Greenfield

## OWNER'S MANUAL INSTRUCTIONS AND SPARE PARTS

12086 ~~120~~  
340



---

### EVOLUTION III

Models:	10.5 - 30"	13 - 32"	13 - 32" Deluxe
---------	------------	----------	-----------------

---

**Greenfield** Products Pty Ltd

172 Ingram Rd, Acacia Ridge, Qld. Australia 4110. Fax (07) 344 1161. Phone: (07) 345 6100

EVOLUTION III

# Contents

<b>Safety Instructions</b>		2
<b>Operating Instructions</b>		4
<b>Differential Instructions</b>		6
<b>Maintenance</b>	General	7
<b>Maintenance</b>	Blades and Belts	8
<b>Maintenance</b>	Chains, Steering and Parking Brake	12
<b>Electrical Circuits</b>		14
<b>Spare Parts</b>	Chassis	15
	Linkages	16
	Engine and Electrics	17
	Drive Clutch and Rear Axle	18
	Steering and Front Axle	19
	Cutter Deck	20
	Body Work and Seat	21
<b>Service Record</b>		22
<b>Guarantee</b>		23
<b>Other Greenfield Products</b>		24



**Greenfield** 

**Australian Made Since 1966**

**© Greenfield Products Pty Ltd**

All details are correct at the time of printing but are subject to change without notice.

## Evolution III

Thank you for buying an Australian made **Greenfield** tractor mower. Follow the manufacturer's operating and maintenance instructions and many years of excellent trouble free service can be expected.

**Before operating** the mower **read the owner's manual carefully**. Do not allow children or any person unfamiliar with the safe operating procedure to operate this mower. Your Greenfield mower has been designed to meet stringent safety standards - but we remind you that a mower is a cutting device - **used incorrectly it could cause personal injury**.

## Safety Instructions

1. Do not carry passengers.
2. Know your controls. Read the operating instructions carefully. Learn how to stop the mower and the engine quickly in an emergency.
3. Do not mow whilst people, especially children or pets are in the mowing area.
4. Make sure the area to be mown is clear of sticks, stones, bottles, bones, wire and other debris which could be thrown by the blades.
5. Do not operate the machine without first inspecting the blades, blade bolts and blade holder for wear or damage. **Damaged blades and worn bolts are major hazards**. Always replace blades and blade bolts in sets to preserve balance. Replace worn or damaged parts with **genuine Greenfield** replacement parts only. N.B. Use of inferior non-genuine service parts on your Greenfield mower could result in costly damage and even personal injury. Refer "Maintenance Instructions", for replacement part numbers and fitting instructions.
6. Before using, check that the grass catcher, safety switches and guards provided by the manufacturer are operating properly and fitted securely. Regularly check all the components on the mower to ensure the machine is in a safe operating condition.
7. Never mow while barefoot or wearing open sandals or thongs. Wear long trousers and heavy shoes. It is also important that you wear suitable eye protection.
8. A mower operator should be in good physical and mental health and not under the influence of any drug or alcohol which might impair vision, co-ordination or judgement.
9. Replace worn or faulty exhaust mufflers.
10. Keep the engine free of grass, leaves or excessive grease. These can be a fire hazard.
11. Refuel outdoors only. Do not smoke while fuelling engine. Never remove the cap of the fuel tank or add petrol while the engine is running or if the engine is hot, allow it to cool. Remove fuel cap slowly to relieve any tank pressure. If petrol is spilled do not attempt to start the engine but move the machine away from the area of the spill and avoid creating any source of ignition until petrol vapours have dissipated.
12. Check for fuel leaks, while refuelling or using the mower. If a fuel leak is detected, do not start the engine until the fuel leak is fixed and the spilled fuel is wiped away.
13. Do not operate the engine in a confined space where poisonous exhaust fumes (carbon monoxide) can collect.
14. Always disengage the cutting blades from the operator's seat before starting or stopping the engine.

15. Always mount the mower from the opposite side to the discharge chute.
16. Exercise extreme caution when on slopes. Reduce speed particularly when making sharp turns to prevent overturning or loss of control. Do not stop or start suddenly when mowing uphill or downhill.
17. Never operate a ride-on mower across a slope steeper than what you would comfortably drive a car across.
18. Stay alert for holes in the terrain and other hidden hazards.
19. Before crossing paths, driveways or any other area foreign to mowers, reduce engine speed, disengage cutting blades and lift cutting attachment to maximum height.
20. Watch out for traffic when crossing or operating the mower near roadways. Always mow with the grass deflector properly fitted.
21. When mowing, never direct discharge of material toward bystanders nor allow anyone near the machine while in operation.
22. Before leaving the operator's position -
  - (a) Disengage the cutting blades.
  - (b) Apply the parking brake.
  - (c) Stop the engine and remove the starter button or key (whichever is fitted).
23. Disengage the drive to the cutting blades and stop the engine -
  - (a) Before refuelling
  - (b) Before removing grass catcher or any attachment.
  - (c) Before making a height adjustment unless adjustment is being made from the operator's position.
  - (d) Before clearing blockages.
  - (e) Before inspecting, cleaning or working on the mower.
  - (f) After striking a foreign object (inspect the mower for damage and make necessary repairs before restarting and operating the machine).
  - (g) If the machine starts to vibrate abnormally (check immediately)
24. Disengage drive to the cutting blades when not in use or in transporting.
25. Do not over-speed the engine or alter governor settings. Excessive speed is dangerous and shortens the mower's life.
26. Use care when pulling loads or using attachments.
  - (a) Use only the approved drawbar hitch point.
  - (b) Limit loads to those you can safely control.
  - (c) Do not turn sharply. Use care when backing up.
27. Store the mower in a well ventilated room away from naked flames such as may be found in some hot water heaters.
28. Do not lend or sell the mower without the owner's manual.
29. **Warning** - Remove spark plug lead to avoid accidental starting before attempting any maintenance or inspection of the mower.

# Operating Instructions

## BEFORE STARTING

### Fuel

Top with clean regular **Unleaded** petrol only. Make sure the petrol is free from impurities, particularly water. The petrol tank is located inside the engine compartment of your Greenfield. Raise the bonnet for access. Do not use stale petrol in your mower, add clean fresh fuel for every mowing.

### Engine Oil

Fill to the **FULL** mark indicated on the dipstick. Use SAE 30 SF oil. Don't overfill. Refer to "Crankcase Lubrication" in the maintenance section of this book.

### Tyres

Inflate to the pressure indicated on the tyres. Usually 20psi (140KPa) on the front and 10psi (70KPa) on the rear. Don't over inflate.

## TO START

Apply park brake, disengage blade clutch (Cutters Out). Turn on fuel tap (if fitted). For cold starting set throttle control to "Choke", Turn Starter Key or push starter button (whichever is fitted) ten (10) seconds, maximum to avoid overheating the starter motor. Make sure to return the key to the **RUN** position after the engine starts or each time you attempt to start it. If engine does not start it may be flooded. Set throttle half way then Turn Key or Push Button Again. Do not allow children or any person unfamiliar with the safe operating procedure to use this mower. Know your controls. Read the following instructions carefully. Learn how to stop the mower and the engine quickly in an emergency.

**Important** - This Evolution Model Greenfield mower is fitted with a safety 'cut-out' switch activated by the seat. The operator must be seated to start the engine and remain seated while operating the mower. If you don't remain seated the engine will stop. This safety switch must be kept functional for your protection. Adjustment is easily done if ever necessary.

## TO OPERATE

A simple pivoted foot pedal controls forward, neutral and reverse. Toe pressure to move forward, heel pressure to move in reverse. Increased toe or heel pressure provides speed variation in forward or reverse respectively. Allow pedal to centralise for neutral. The drive pedal can also be used as a brake by applying toe or heel pressure opposite to the directional movement of the mower. Sudden or violent directional changes and/or wheel spinning must be avoided.

### Park Brake

The park brake lever is located in front of the right side rear mudguard, this lever has two positions, shift lever out and rearwards to engage the park brake. To disengage, shift lever out and forward. The spring loaded mechanism will self engage when mower is moved slightly forward or backwards. This brake can also be used for stopping the mower in an emergency. The park brake positively locks the rear axle and wheels for transport.

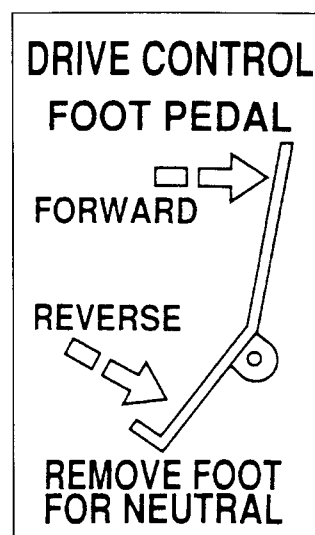

### Cutting Height

The height adjustment lever located to the right of the steering console enables the operator to select the desired cutting height. To alter the cutting height move the lever to the right then shift upwards or downwards to select the setting then release to lock in position. An indicator panel displays the setting. Keep the indicator in the green band for maximum belt life.

### Blade Clutch

The blade clutch lever is located on the cutter deck alongside the right hand side running board. To engage the cutting blades, move this lever fully rearward, then away from the running board to lock the clutch lever into the engaged position. To disengage the cutting blades, pull the lever towards the machine and gradually move the lever to the "OUT" position. Always disconnect blades (OUT) before dismounting.

### Seat

The operator's seat is adjustable front to rear. To adjust, hinge seat forward, loosen four seat securing bolts, slide seat to position required and retighten bolts. Oil pivots occasionally.

## TO STOP

Reduce engine speed, disengage cutter blades (cutters out) apply park brake, allow engine to cool down by idling approximately 30 seconds. Set throttle control to "stop" position to switch engine off.

**Then, and only then, dismount from the driver's seat.** Turn fuel tap off (if fitted).

# Greenfield Patented Differential

## Instructions and Hints

The Greenfield Evolution mower features a revolutionary new type of differential. This differential offers the operator the option of the full differential action of the rear wheels for improved steering and a tight turning circle, whilst eliminating rear wheel scuffing on fine lawns. Most people will run their Greenfield with the differential operating all the time. This is the preferred method of operation and is accomplished by keeping the handle hooked over the end of the rear axle (See "A" below).

**Important:** Do not attempt to engage or disengage the differential lock from the operator's seat or while the engine is running.

In some situations, such as extremely wet areas or if hill climbing, you may choose to lock the differential for improved traction. You accomplish this by releasing the handle from the end of the rear axle. The lock will automatically engage when released (See "B" below).

To return the differential to the operating position (see "A" below) turn the steering wheel either to the left or the right; then rock the mower back and forth while simultaneously pulling out on the engagement handle and hook it over the end of the rear axle. Lubricate if necessary.

If the left side rear wheel is removed, make sure the keyed engagement block slides freely into the engagement plate square before the final tightening of the wheel nuts.

Greenfield differentials are lubricated and sealed for life at the factory. If in the unlikely event that your differential needs service, it must be returned to Greenfield intact. **Differentials that have been tampered with or dismantled will NOT be considered for warranty.** Normal warranty is 12 months for private use and 3 months for commercial use. Extended warranty is available for up to 3 years for private use or 6 months for commercial use. See your Greenfield dealer for details. Service and spares for the differential are only available through the factory during the warranty period.

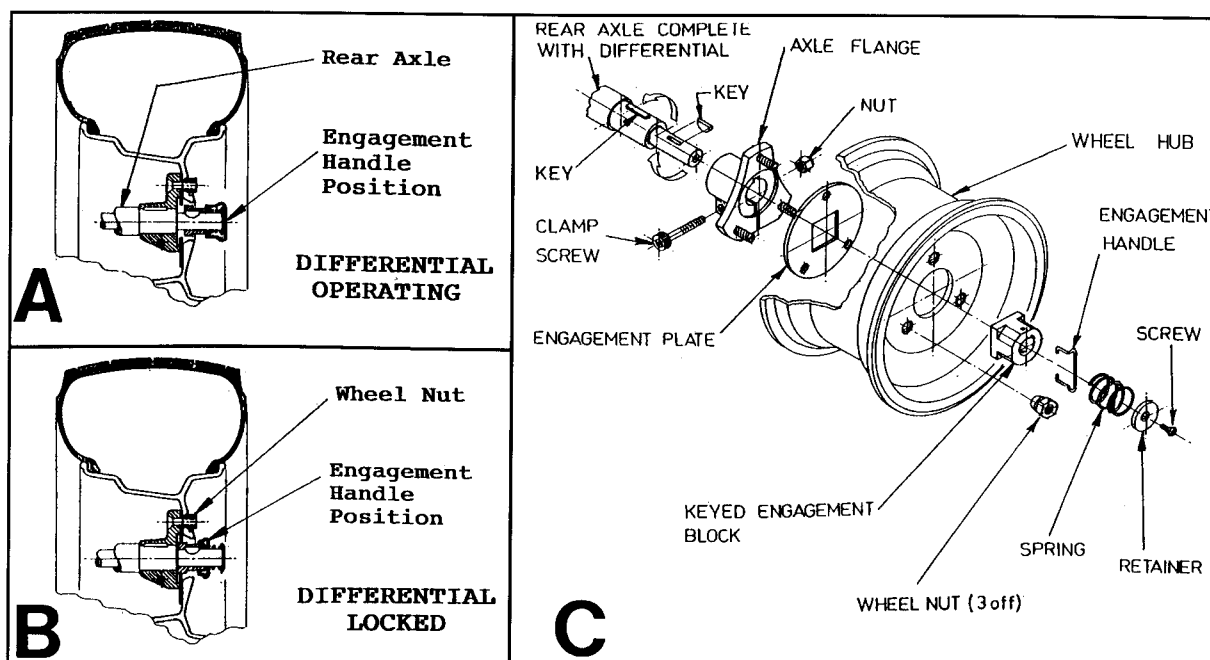

# Maintenance

**Warning:** Remove the spark plug lead to avoid accidental starting BEFORE attempting any maintenance or inspection of the mower.

## Crankcase Lubrication

Change engine oil after the first 5 hours of operation then every 6 months or 25 working hours, whichever comes first. Change more often in heavy work or dusty conditions. Drain engine oil whilst engine is warm then replace with a quality S.A.E. 30 S.F. motor oil (refer to the Engine Manufacturers Operating booklet oil recommendations). Fill to the full mark indicated on the dipstick. Don't overfill. To check oil level, position the mower on level ground, remove dipstick and wipe clean. Replace dipstick screwing correctly into position. Remove again and sight oil level. Dipstick must be firmly in place when the engine is running.

## Air Filter

Service air filter as per the engine manufacturers booklet. Clean or replace more often in dusty conditions. Never operate the engine without the air filter correctly and securely fitted – rapid and expensive wear will occur.

## Cooling System

Remove the blower housing and clean out the grass and debris to prevent engine overheating. Refer to engine manufacturer's booklet.

## Battery

Top with distilled water to the correct level as required. If externally charging, care is needed. TRICKLE CHARGE ONLY to avoid battery damage.

**Warning:** Do not let the battery discharge during winter, trickle charge regularly, at least once a month.

## Wheels

The rear wheel nuts should be re-tensioned after the first 5 hours of operation to 78Nm (58 ft.lbs) on 10.5 HP models and 44Nm (33ft.lbs) on 13 HP models, then regularly with your preventative maintenance checks.

## Tyres

Inflate to pressure indicated on the tyres. Usually 20psi (140KPa) on the front and 10psi (70KPa) on the rear.

## Cleaning

Never wash your Greenfield with a high pressure washgun. You could blast water and dirt past the seals in the bearings and cause premature bearing failures and rusted pivot points.

- Never wash your Greenfield right after you use it. The quenching contraction effect from hosing off the machine when it's at operating temperature could also draw water and dirt into the bearings and cause premature bearing failures.
- The best way to clean your Greenfield is to use an air hose to blow the loose grass, etc. from around pulleys, belts and the top of the cutter deck. Wash the exterior with a sponge and bucket, then rinse off with a hose and wipe it down the same as you would your car. For maximum machine life, do not spray water on the pulleys and bearings.
- Clear off all grass and other debris from your Greenfield each time before you use it. Sticks, stones or an accumulation of grass and other debris will damage belts and fracture pulleys if they go through between the pulley and belt.



## BLADES AND BELTS

### Belts

Greenfield "V" belts are self adjusting but cutter belts may need occasional adjustment within their tensioning range (see page 11). Inspect the "V" belts regularly and replace if damaged. Part Numbers for V belts are -

Drive V Belt GT12004

Cutters V Belt GT376

**Important** - For long service life, **use only genuine Greenfield branded V belts**, refuse substitutes.

### Blades

Check condition of blades, blade bolts and blade holder. Replace if damaged or worn. Worn or damaged blades and bolts are major hazards. Always replace worn or damaged blades and bolts in sets to preserve balance. **Use only Genuine Greenfield branded replacement parts.** Use of inferior non-genuine replacement parts on your Greenfield could result in costly damage or even personal injury. Part Numbers for Blades and Bolts are:

Cutter Blade and Bolt Set GT2139

To fit new blades refer to Illustration A.

Tighten the blade bolt nuts firmly. Correct torque is 44Nm. (32ft. lbs). Blades must be free to turn but not loose. Lightly oil the blade pivot point before fitting.

**Illustration A**

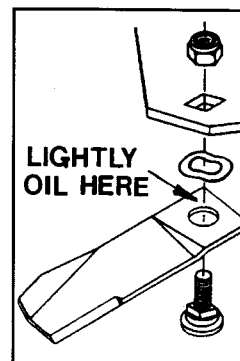

### Chassis Lubrication

Your Evolution 3 Greenfield mower has 5 greasing points (refer Illustration B).

1. Grease every 6 months or 50 hours. Grease nipples are fitted to the king pin housings in the front axle beam.
2. A grease nipple is fitted to the steering pivot assembly GT13760 accessible from under the chassis adjacent to the drive control pedal.
3. A grease nipple is fitted to the steering tube located inside the steering console.
4. A grease nipple is also fitted to the lifting shaft which raises and lowers the cutting deck. This nipple is accessible through an opening in the frame with the rear cover removed.

Grease these locations with a quality No. 2 lithium base grease or equivalent. It is recommended your grease gun be fitted with a flexible hose. All other exposed pivoting joints, lever points and slides are to be lubricated with engine oil. The rear drive chain should be removed, thoroughly cleaned in kerosene and reoiled with a quality chain oil every 50 hours, more often if hosed.

**Illustration B – Evolution III - Grease Points**

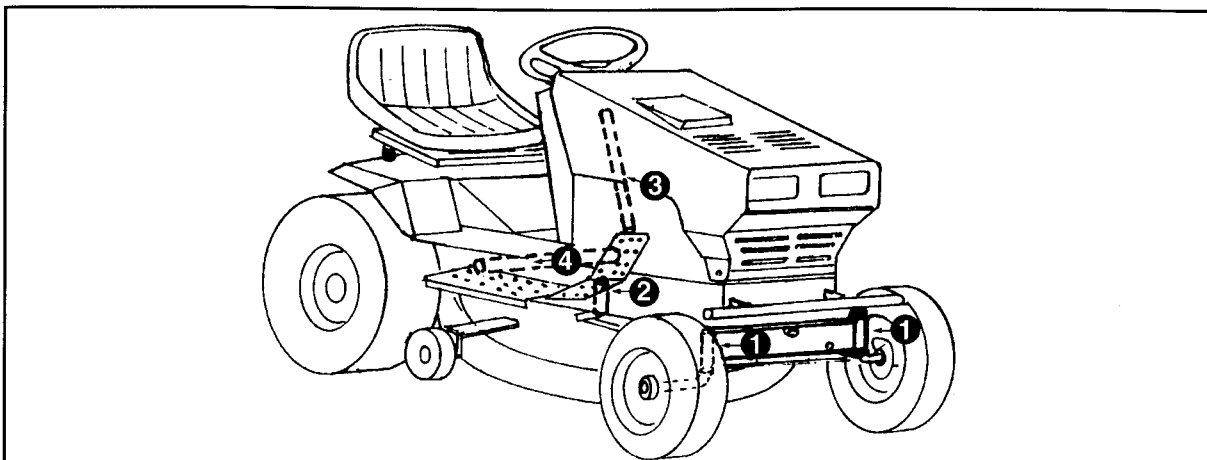

## To Remove Rear Drive Belt

1. Remove the spark plug lead to prevent accidental starting.
2. Lift up the seat and disconnect the wire to the seat cut out switch by pulling apart the spade connector on the blue wire by the top of the battery. Remove the rear cover by undoing the star knob under the seat and removing the rear cover and seat assembly.
3. Set the blade height to the "LOW" position.
4. Swing back the steady bracket supporting the rear clutch link (refer Illustration C).
5. Remove the retaining pin from the back end of the clutch yoke. Lift off the rear clutch link and swing rearward (refer Illustration D).
6. With the spring release hook tool provided (see Illustration E), remove the tension spring from the idler pulley notch bar.
7. Release the notch bar leaf spring by inserting the hook tool between the leaf spring and the notch bar. Rotate the hook tool and hold the leaf spring in a released position allowing the idler pulley to slide freely rearwards to permit belt removal (refer Illustration E).
8. To remove the drive V belt from the engine pulley the cutter V belt must first be removed. Follow steps No. 1, 2 and 3 of "To remove cutter V belt" instructions. Now remove the drive V belt from the engine pulley.
9. Lift the drive V belt off both flat idler pulleys and remove the belt through the opening at the rear clutch link.

**Illustration C**

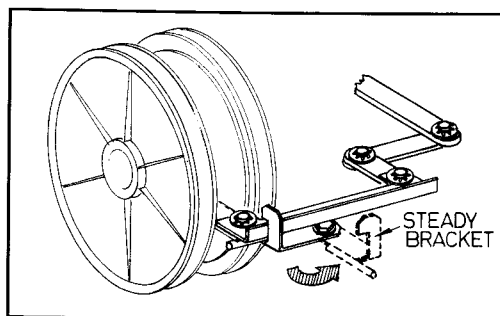

**Illustration D**

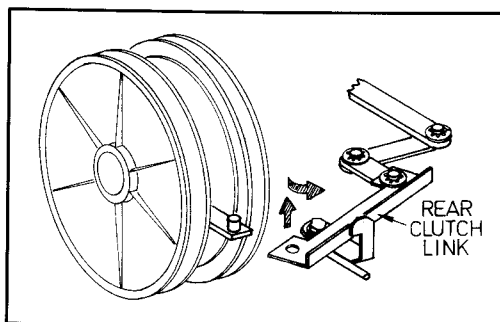

**Illustration E**

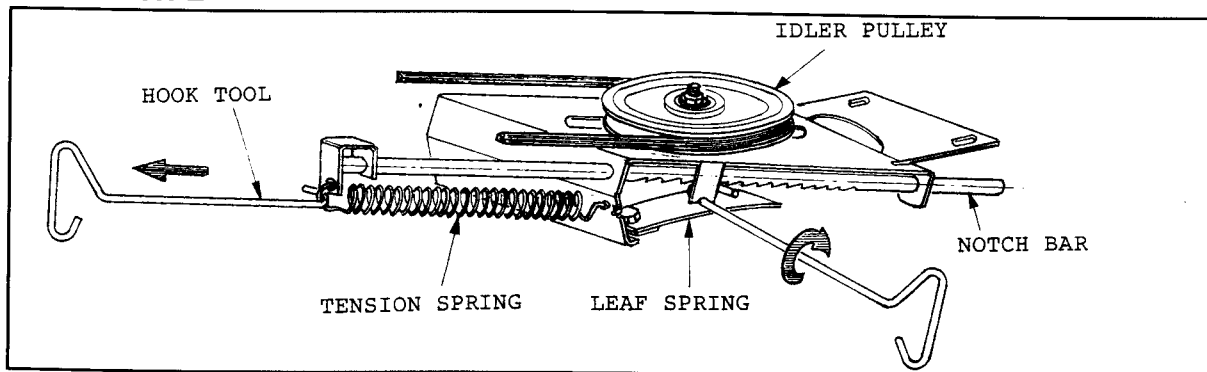

## To Replace Rear Drive V Belt

1. Feed the belt down the back of the clutch pulleys and onto the top groove of the engine pulley. If the cutter V belt is in position on the engine pulley, remove the belt by following steps No. 1, 2 and 3 of "To remove cutter V belt" instructions.
2. Fit the belt into both clutch pulleys then into the idler pulley on the notch bar, this pulley will need to be in the fully rearward position.
3. Fit the belt over both flat idler pulleys.
4. Replace the notch bar tension spring using the hook tool.
5. Replace the rear clutch link and the retaining clip.

6. Swing the steady bracket forward to support the rear clutch link.
7. Refit the cutter V belt into the bottom groove of the engine pulley by following step No. 2 of "To replace cutter V belt" instructions.
8. Replace the rear cover and reconnect the wire to the seat safety cut out switch.
9. Replace spark plug lead.

### To Remove Cutter V Belt

1. Remove the spark plug lead to prevent accidental starting.
2. Lower the blade height to the "LOW" position and disengage the cutters, blade clutch "OUT".
3. Remove the V belt from the engine pulley by manoeuvring the belt down between the pulley and belt guide pins.
4. Remove the fixed clutch pulley and belt guide and the sliding clutch pulley and belt guide located on the cutter deck (see Illustration F).
5. Remove the belt guide from the cutter pulley by loosening the nuts on each side and removing the nut at the front of the belt guide.
6. Remove the belt from the machine.

### Illustration F

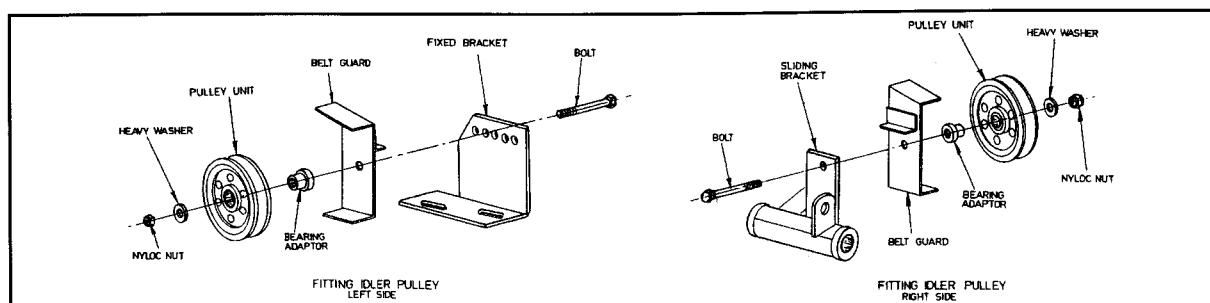

### To Replace Cutter V Belt

1. Refit the idler pulleys to the mounting brackets in this order – Insert the bolt through the bracket. Position the belt guard over the bolt against the bracket with a guard wing at the top, bottom and rear. The bearing adaptor, large end first then slips over the bolt. While holding the V belt into the pulley groove, slide the pulley over the bolt and onto the bearing adaptor. With the wings of the guard over the belt and pulley, fit the thick flat washer and nyloc nut (see Illustration F).

**Important** - Check that pulleys turn freely inside belt guards with belt disengaged.

2. Fit the belt to the bottom groove of the engine pulley ensuring belt is inside belt guide pins then to the cutter pulley.
3. Replace the belt guide around the cutter pulley and tighten the nyloc nuts.
4. Replace the spark plug lead. From the operator's seat, run engine and engage cutters to check V belt operation. (refer cutter belt adjustment page 11).

**Note** - A belt run-in period is required as follows. With the height adjusting lever in the green band (mid height position) engage cutter blades and run for a minimum of ten minutes at medium engine speed. Ideally, a total run-in time would be approximately one hour, during which time you can cut grass, on a mid height position.

## Cutter Belt Adjustment

**Warning:** Remove the spark plug lead to avoid accidental starting **BEFORE** attempting any maintenance or inspection of the mower.

With the cutter clutch lever in the "OUT" position (disengaged) the cutter belt should be sufficiently disengaged to allow the cutter blades to come to a complete stop in approximately 7 seconds. The correct amount of belt slack and the efficient operation of the cutter brake control this stopping time. The spring loaded clutch idler pulley maintains the correct belt tension when the blade clutch lever is in the "Engaged" position.

The left side of the cutter belt idler pulley can be adjusted to allow for belt stretch. The first adjustment should be checked after approximately 5 hours of operation with further checks after approximately 50 hours. Adjust if necessary.

This left side pulley bracket has five bolt hole positions available plus a sliding adjustable base.

To adjust belt, loosen two nyloc nuts on the pulley bracket base and slide bracket rearwards, retighten nuts. This should suffice unless some extraordinary wear has occurred. If further adjustment is required you can relocate the pulley to a different hole.

The manufacturer recommends all Greenfields be returned to your authorised Greenfield dealer for normal servicing i.e. oil changes, air filters etc. at the times indicated in the maintenance section and by the engine manufacturer. The manufacturer also recommends a maintenance and safety inspection be performed every 6 months or every 50 working hours by your authorised Greenfield dealer to comply with the conditions for both standard and extended warranty offered by the manufacturer, refer to the warranty leaflet.

## CHAINS AND BRAKES

### Steering Chain Adjustment

1. Remove the spark plug lead to prevent accidental starting.
2. Work from under the bonnet area at the rear of the engine, loosen both nyloc nuts on the chain adjusting bracket. Refer to Illustration G.
3. With fingers only, push the chain adjusting bracket to the left to tighten the steering chain to a maximum of 3mm slack as shown in Illustration H. Do not overtighten.
4. Re-tension both nyloc nuts.
5. Always check steering stop adjustments after adjusting the steering chain because the chain adjustment can affect the stops.
6. Replace the spark plug lead.

**Illustration G**

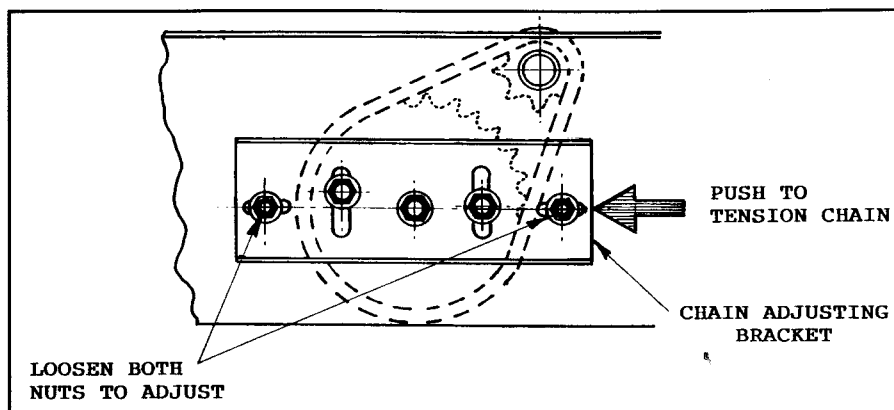

**Illustration H**

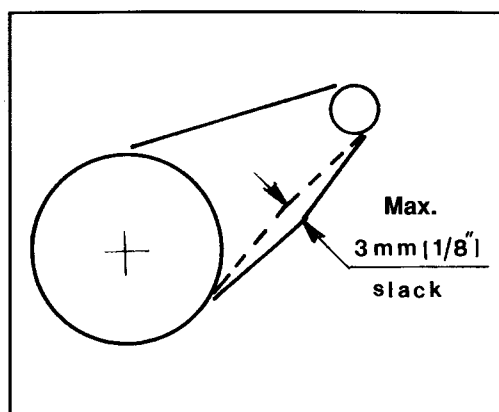

## Steering Stop Adjustment

1. Remove spark plug lead.  
Always perform your steering chain adjustment before you adjust the steering stops because the chain adjustment can affect the stops.
2. Lift up the seat and disconnect the wire to the seat cut out switch by pulling apart the spade connector on the blue wire by the top of the battery. Remove the rear cover by undoing the star knob below the seat and removing the rear cover and seat assembly.
3. Loosen the two screws at each side securing the step through cover, then lift off this cover
4. Loosen the two stops on the chain adjuster Bracket (refer Illustration J, item B).
5. Turn the steering wheel full lock to the right till the right hand king pin is hard against the fixed stop "A".
6. Slide right side bolt stop "B" in chain adjuster bracket until bolt head hits against tie rod end securing nut "C" then move the bolt away to give a clearance of approximately  $\frac{1}{2}$  mm between bolt "B" and nut "C". If securing nut "C" will not hit bolt stop "B" you may have to adjust drag link or steering rod to give you more travel.
7. Turn the steering wheel full lock to the left then repeat step 6 listed above.
8. To check your adjustments are correct turn steering wheel to either lock, noting stop "A" contacts momentarily before stop "B". This will ensure smallest turning circle without unnecessary strain on the steering components.

**Note** - Front wheels are set parallel to 1.5mm ( $\frac{1}{16}$ " ) toe-in.

## Rear Drive Chain Adjustment

1. **Important:** Always check park brake adjustment after adjusting the drive chain because the chain adjustment affects the park brake adjustment.
2. Disconnect spark plug lead to prevent accidental starting.
3. Remove rear cover and seat assembly. (refer No. 2 - Steering Stop Adjustment).
4. Raise and block up rear of mower. Remove rear wheels for access to flange plates.
5. Loosen the four rear axle flange bearing mounting plates (2 on each side) (see Illustration K).

Illustration J

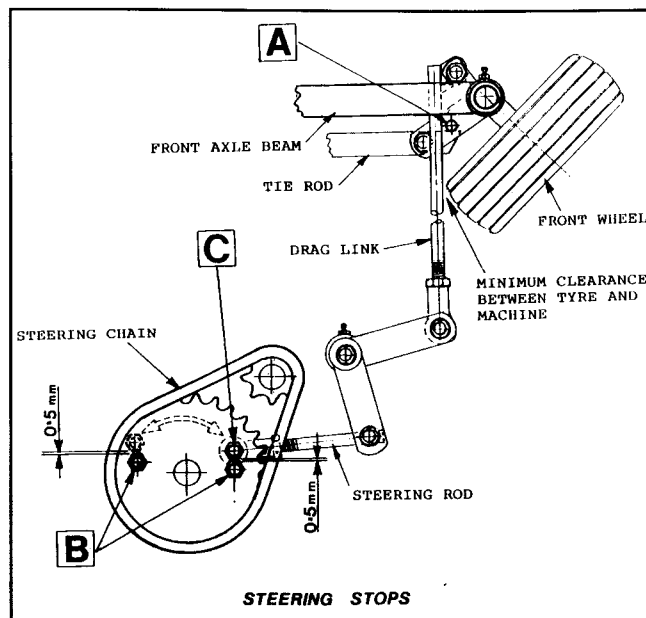
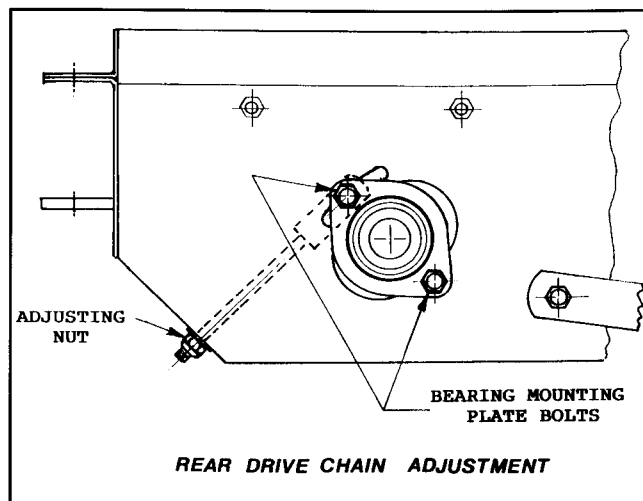

Illustration K



6. Adjust the chain by turning the adjusting nuts positioned below the rear axle side plates clockwise to tighten the chain. It is very important to adjust each side evenly so the rear axle remains parallel to the mower chassis and the sprockets are in alignment. It is suggested that you turn each nut no more than a quarter of a turn at a time alternating between the two until the chain has 3mm slack as shown in Illustration H. Do not overtighten.
7. Re-tension rear axle flange bearing mounting plate bolts.
8. Re-fit and tension rear wheels to 78Nm (58ft.lbs.) on 10.5HP Model and 44Nm (33ft.lbs.) on 13HP Models.
9. Re-fit rear cover and reconnect blue safety switch wire.

### Park Brake Adjustment

1. Always perform your drive chain adjustment before the park brake adjustment.
2. Check that the brake arm moves freely on the pivot bush by swinging the arm forward against the spring. Lubricate if necessary.
3. Check clearance between the brake arm and the brake disc in the "Off" position is approximately 3mm (refer Illustration L). Adjust with nut as shown.
4. With the brake lever in the "On" position check the brake arm lug fully engages into the recess in the brake disc.
5. Refit spark plug lead.

Illustration L

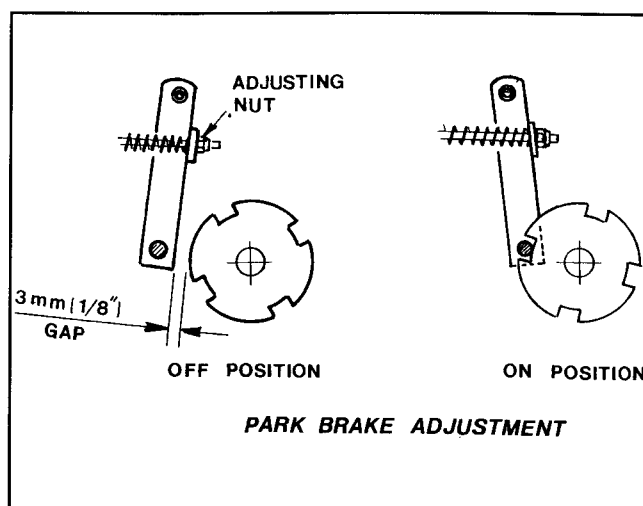

## Electrical Circuits

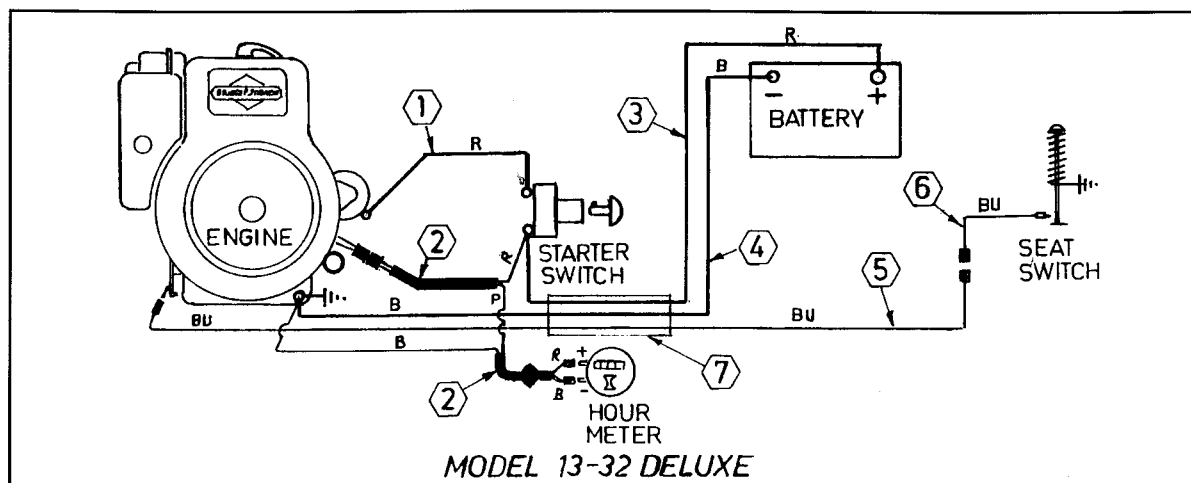
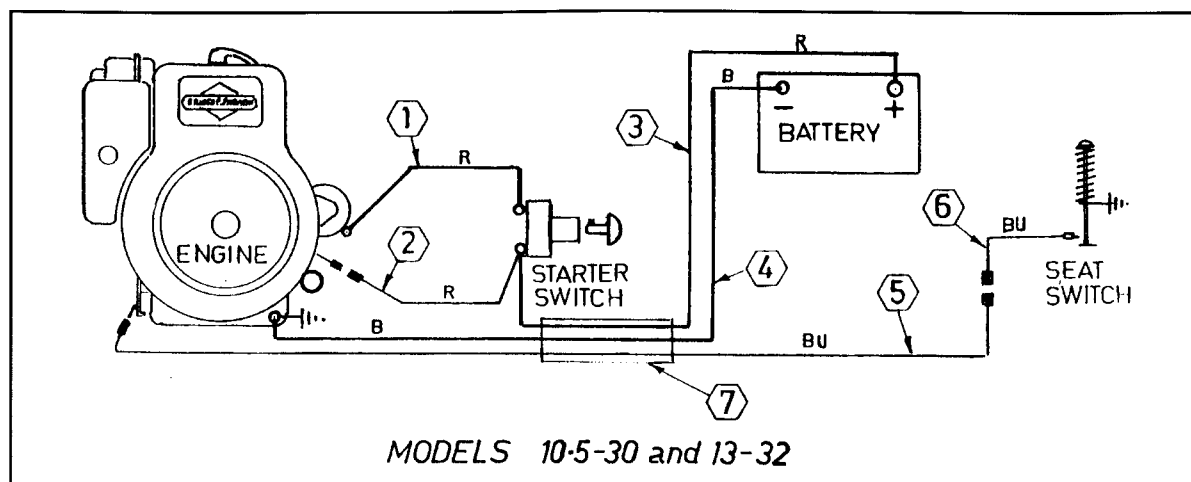

INDEX	PART NO.	DESCRIPTION
-------	----------	-------------

1	GT 9051	Red Cable - Starter Switch to Starter Motor
2	GT 12065	Red wire - Charging Wire, Model 10.5-30
2	GT 12064	Red Wire - Charging wire, Model 13-32
2	GT 12067	Wire Harness - Charging & Hour Meter, Model 13-32 Deluxe
3	GT 12062	Red Cable - Battery positive to starter switch
4	GT 10473	Black Cable - Battery negative to engine base
5	GT 12061	Blue wire - Seat Switch to engine cut out
6	GT 12066	Blue wire - Seat switch
7	GT 12063	Back spaghetti tube

### COLOUR LEGEND

B	-	BLACK
P	-	PURPLE
R	-	RED
BU	-	BLUE

PARTS AND SPECIFICATIONS SUBJECT TO CHANGE WITHOUT NOTICE



# Chassis

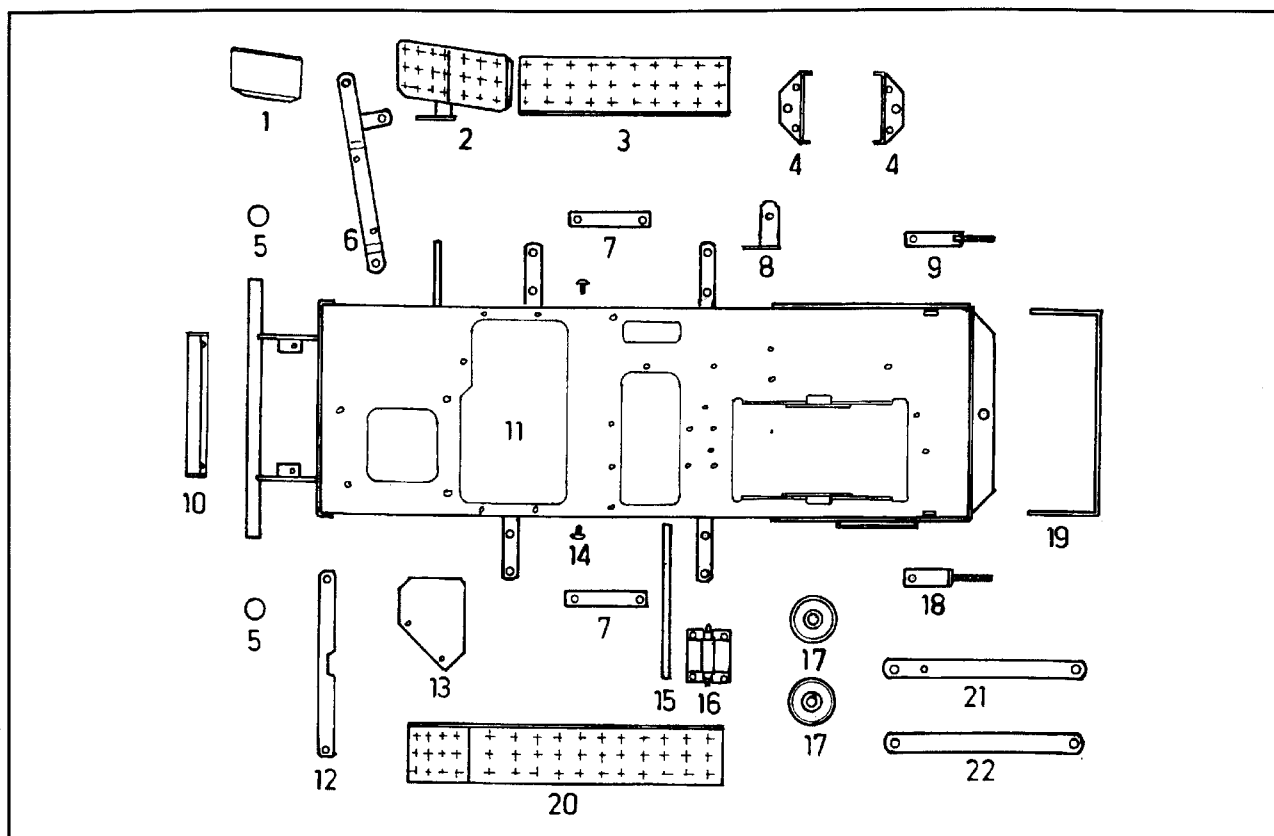

INDEX	PART NO.	DESCRIPTION	INDEX	PART NO.	DESCRIPTION
1	GT 12365	Heat Shield	12	GT 10524	Backing Strip
2	GT 13040	F-R Foot Pedal	13	GT 12336	Heat Shield - Left Side
3	GT 12369	R.H. Running Board	14	GT 1760	Nylon Button
4	GT 14353	Battery Bracket	15	GT 10011	Shaft - Height Adjust
5	GT 6081	Plastic Cap	16	GT 13305	Idler Pulley Bracket
6	GT 12890	Support Bracket	17	GT 1009	Flat Idler Pulley
7	GT 13610	Nut Retainer	18	GT 13170	L.H. Chain Adjuster 30 & 32 Models
8	GT 14316	Support - Wiring Harness	18	GT 13575	L.H. chain Adjuster 32 Deluxe only
9	GT 13170	R.H. Chain Adjuster	19	GT 12390	Support - Rear Cover
10	GT 12367	Bonnet Hinge (13HP only)	20	GT 13640	L.H. Running Board
11	GT 13375	Chassis Model 10.5-30	21	GT 13530	Top Link - Cutter Deck
11	GT 13385	Chassis Model 13-32	22	GT 7406	Bottom Link - Cutter Deck 13HP Models
11	GT 13395	Chassis Model 13-32 Deluxe	22	GT 12396	Bottom Link - Cutter Deck 10.5HP Model

PARTS AND SPECIFICATIONS SUBJECT TO CHANGE WITHOUT NOTICE.

STANDARD HARDWARE ITEMS ARE NOT SHOWN

# Linkages

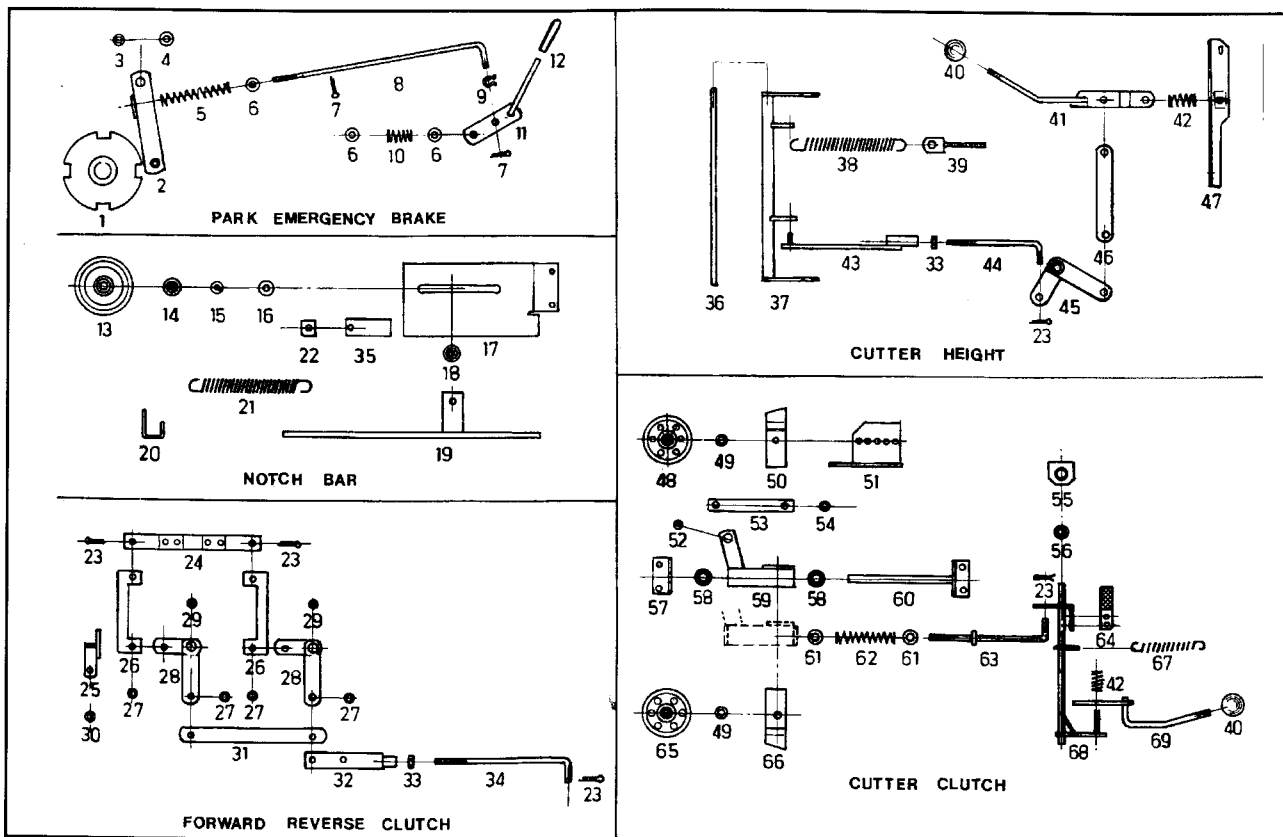

## INDEX PART NO. DESCRIPTION

1	GT 13250	Park Brake Disc
2	GT 13355	Brake Arm
3	GT 730	Pivot Bush
4	GT 1025	Washer
5	GT 12032	Spring - Compression
6	GT 1035	Washer
7	GT 167	Split Pin
8	GT 12360	Brake Rod
9	GT 144	Circlip
10	GT 1294	Spring - Compression
11	GT 13220	Brake Lever
12	GT 2227	Cap
13	GT 7965	V Pulley & Bearing complete
14	GT 610	Bearing Adaptor
15	GT 597	Wave Washer
16	GT 23	Washer
17	GT 13545	Bracket
18	GT 608	Slide Bush
19	GT 13550	Notch Bar
20	GT 7308	Spring Anchor
21	GT 1554	Spring - Tension
22	GT 12371	Packer
23	GT 165	Split Pin
24	GT 13883	Yoke Unit Complete
25	GT 14685	Steady Bracket
26	GT 14354	Clutch Link
27	GT 2057	Retainer
28	GT 15095	Pivot Arm
29	GT 1851	Pivot Bush
30	GT 1477	Crinkle Washer
31	GT 14355	F-R Link
32	GT 15105	Adjustable Link
33	GT 36	Nut
34	GT 14356	Clutch Rod
35	GT 14023	Leaf Spring

## INDEX PART NO. DESCRIPTION

36	GT 10011	Shaft - Height Adjust
37	GT 13440	Height Adjust Tube
38	GT 6030	Spring - Tension
39	GT 12930	Tensioner
40	GT 1565	Knob
41	GT 13605	Lifting Handle
42	GT 7071	Spring - Compression
43	GT 13450	Adjusting Link
44	GT 8227	Link
45	GT 13645	Pivot Arm
46	GT 13460	Lifting Arm
47	GT 13615	Support Bracket
48	GT 6901	V Pulley & Bearing complete
49	GT 6018	Bearing Adaptor
50	GT 13790	L.H. Belt Guide
51	GT 13270	Fixed Pulley Bracket
52	GT 535	Felt Oil Pad
53	GT 14318	Bar (2 required)
54	GT 730	Spacer
55	GT 12305	Bracket
56	GD 5525	Bush
57	GT 13776	Bracket
58	GT 6056	Bush
59	GT 13780	Sliding Bracket
60	GT 13775	Rail Assembly
61	GT 585	Cup
62	GT 14024	Spring - Compression
63	GT 12770	Clutch Rod
64	GT 13801	Cutter Brake Pad
65	GT 6901	V Pulley & Bearing complete
66	GT 13785	R.H. Belt Guide
67	GT 9090	Spring - Tension
68	GT 13370	Cutter Clutch Shaft
69	GT 13360	Handle

PARTS AND SPECIFICATIONS SUBJECT TO CHANGE WITHOUT NOTICE.

STANDARD HARDWARE ITEMS ARE NOT SHOWN

## Engine & Electrics

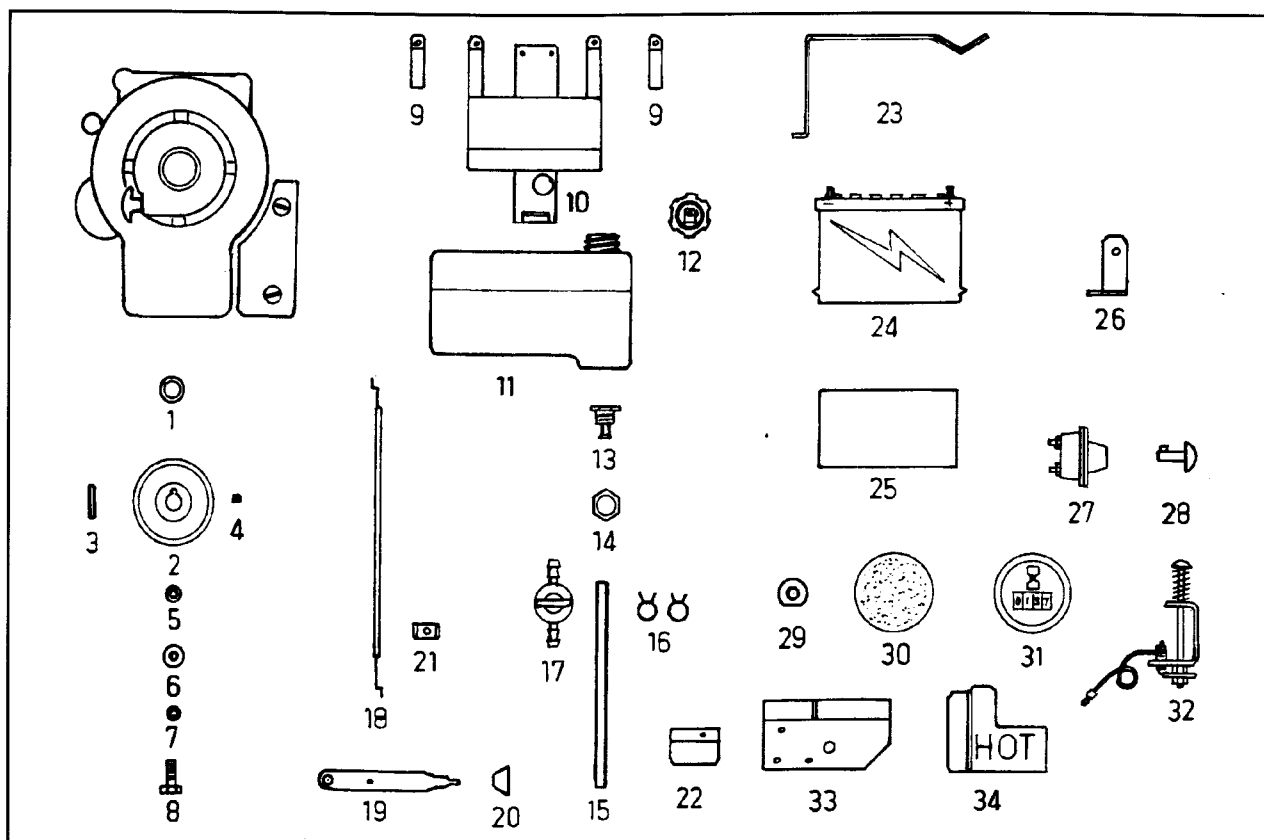

INDEX	PART NO.	DESCRIPTION	INDEX	PART NO.	DESCRIPTION
1	GT 12034	Top Spacer	17	GT 2215	Fuel Tap - when fitted
2	GT 12025	Pulley - Engine	18	GT 13804	Throttle Cable
3	GT 4121	Key	19	GT 12353	Throttle Lever
4	GT 520	Grub Screw	20	GT 2025	Throttle Knob
5	GT 12022	Shaft Extension	21	GT 1252	Cable Clamp
6	GT 1750	Washer	22	GT 12344	Exhaust Deflector
7	GT 2021	Spring Washer	23	GT 14350	Battery Clamp
8	GT 2044	Bolt	24	GT 1914	Battery
* 9	GT 14323	Clamp Strap - Fuel Tank	25	GT 14336	Rubber Mat Battery
* 10	GT 13565	Fuel Tank Support	26	GT 14316	Support - Wiring Harness
* 11	GT 14001	Fuel Tank - Bare	27	GT 1915	Starter Switch
* 12	GT 6031	Cap - Fuel Tank	28	GT 1995	Starter Button
* 13	GT 10043	Hose Tail	29	GT 12345	Insulator Positive +
* 14	GT 10044	Nut	30	GT 2223	Blank Grommet
	GT 15820	Fuel Tank Unit consists of	31	GT 6084	Hour Meter (Model 13-32Deluxe only)
		Items 11,12,13 and 14	32	GT 13831	Seat Safety Switch Unit
* 15	GT 12343	Fuel Hose	33	GT 12385	Heat Deflector
* 16	GT 2024	Hose Clip	34	GT 12387	Heat Shield - Muffler

\* USED ON 13HP ENGINES ONLY

PARTS AND SPECIFICATIONS SUBJECT TO CHANGE WITHOUT NOTICE.

STANDARD HARDWARE ITEMS ARE NOT SHOWN

# Drive Clutch & Rear Axle

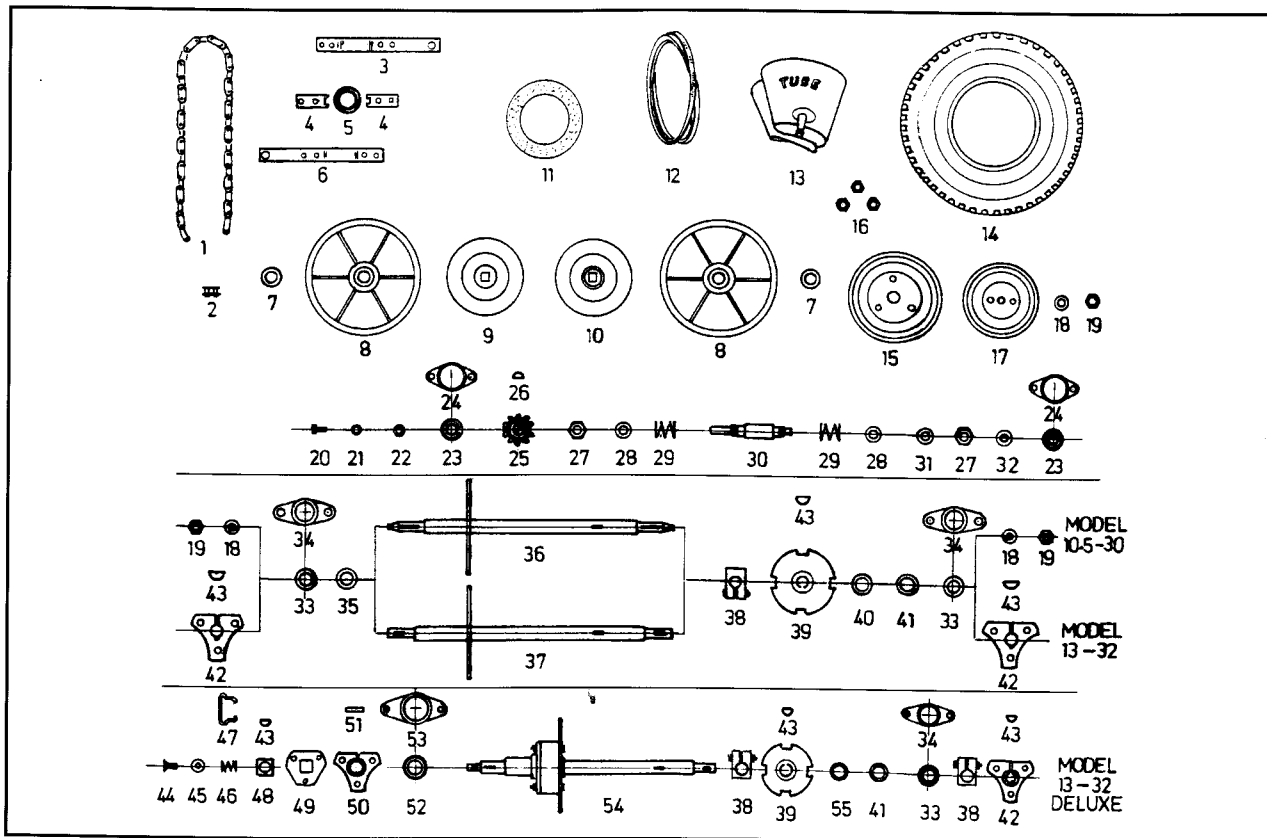

INDEX	PART NO.	DESCRIPTION	INDEX	PART NO.	DESCRIPTION
1	GT 12041	Roller Chain	26	GT 517	Key
2	GT 501	Connecting Link	27	GT 347	Nut
3	GT 10620	Yoke - Top Half	28	GT 7303	Washer
4	GT 12364	Retainer	29	GT 357	Spring
5	GT 855	Bearing - Clutch Plate	30	GT 14008	Drive Shaft
6	GT 10630	Yoke - Bottom Half	31	GT 539	Shim
7	GT 2206	Bearing - Clutch Pulley	32	GT 1488	Washer
8	GT 920	Clutch Pulley complete	33	GT 390	Bearing - Axle
9	GT 6855	L.H. Drive Plate (Reverse)	34	GT 7083	Flangette Plate
10	GT 6856	R.H. Drive Plate (Forward)	35	GT 12386	Spacer - Long
11	GT 6012	Clutch Lining	36	GT 12092	Rear Axle & Sprocket Model 10.5-30
12	GT 12044	V Belt Drive	37	GT 12016	Rear Axle & Sprocket Model 13-32
13	GT 1341	Tube Model 10.5-30	38	GT 7032	Clamp
13	GT 10002	Tube Model 13-32	39	GT 13250	Park Brake Disc
13	GT 1535	Tube Model 13-32 Deluxe	40	GT 9013	Spacer - Short
14	GT 1340	Tyre Model 10.5-30	41	GT 7413	Washer (When required)
14	GT 10001	Tyre Model 13-32	42	GT 1625	Wheel Flange 13-32
14	GT 1203	Tyre Model 13-32 Deluxe	43	GT 516	Key
15	GT 1624	Wheel Hub 13HP Models	44	GT 2425	Screw
15	GT 2929	Wheel Hub 13-32 (left side only) on Deluxe	45	GT 10488	Spring Retainer
16	GT 2011	Wheel Nut	46	GT 2958	Spring - Compression
17	GT 410	Wheel Hub Model 10.5-30	47	GT 2957	Handle
18	GT 1534	Cone Washer	48	GT 2956	Engagement Block
19	GT 178	Nut	49	GT 2955	Engagement Plate
20	GT 1455	Set Screw	50	GT 2954	Wheel Flange 13-32 (left side only Deluxe)
21	GT 2052	Spring Washer	51	GT 2995	Key
22	GT 7306	Washer	52	GT 2209	Bearing - Axle 13-32 (left side only Dlx)
23	GT 392	Bearing - Drive Shaft	53	GT 2210	Flangette Plate
24	GT 7017	Flangette Plate	54	GT 2959	Rear Axle & Differential 13-32 Deluxe (Return to factory for service)
25	GT 12102	10 Tooth Sprocket	55	GT 12380	Spacer

PARTS AND SPECIFICATIONS SUBJECT TO CHANGE WITHOUT NOTICE.

STANDARD HARDWARE ITEMS ARE NOT SHOWN

# Steering & Front Axle

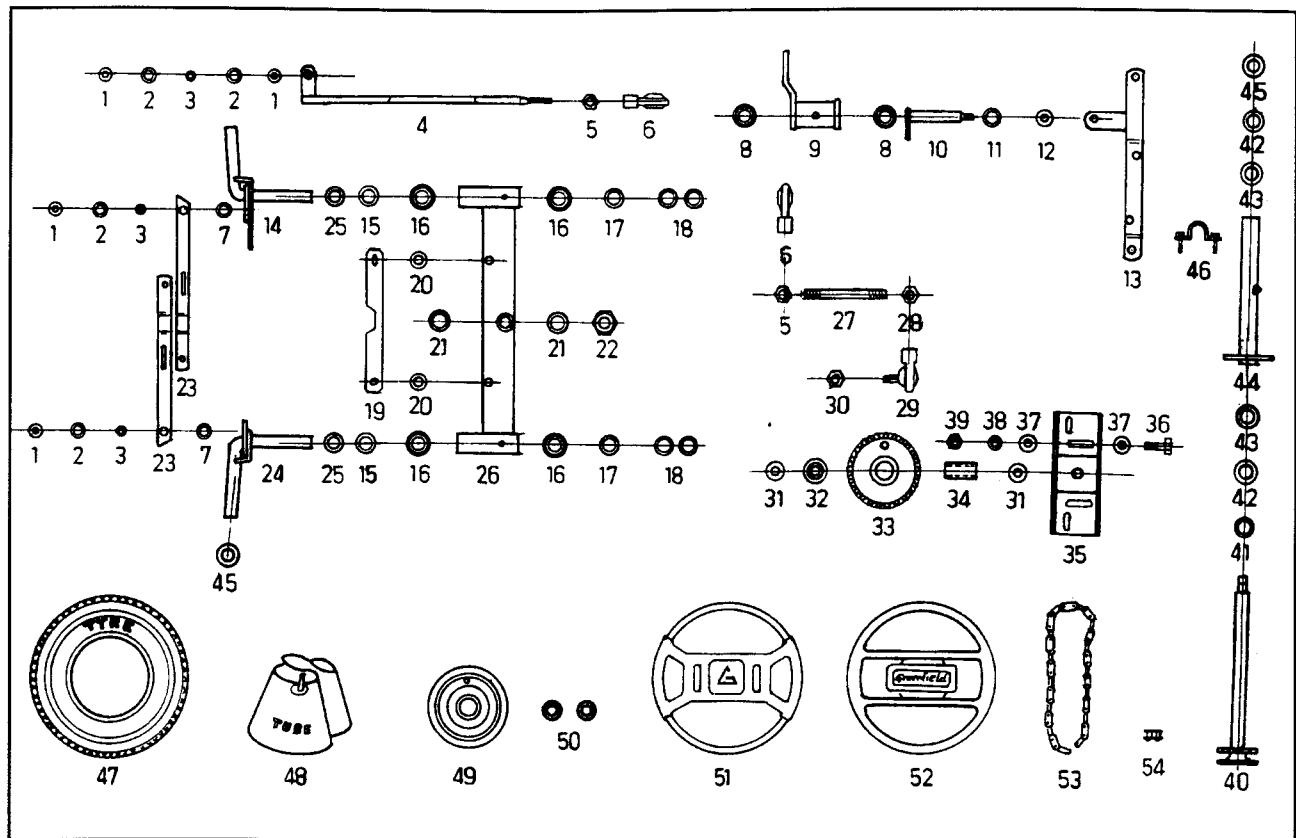

INDEX PART NO. DESCRIPTION

1	GT 10488	Cup
2	GT 534	Felt Seal
3	GT 10037	Pivot Bush
4	GT 13710	Drag Link 10.5HP Model
4	GT 12880	Drag Link 13HP Models
5	GT 78	Nut
6	GT 1626	Tie Rod End
7	GT 10038	Nylon Washer
8	GD 5525	Bush
9	GT 13155	Steering Link
10	GT 13165	Shaft
11	GT 23	Washer
12	GT 579	Wave Washer
13	GT 12890	Support Bracket
14	GT 13195	R.H. King Pin 10.5HP Model
14	GT 15150	R.H. King Pin 13HP Models
15	GT 2018	Washer
16	GT 12394	Bush
17	GT 7304	Washer
18	GT 580	Retainer
19	GT 10524	Backing Strip
20	GT 1660	Washer
21	GT 10480	Washer
22	GT 195	Nut
23	GT 14376	Tie rod
24	GT 13175	L.H. King Pin 10.5HP Model
24	GT 15145	L.H. King Pin 13HP Models
25	GT 10032	Spacer 10.5HP Model only
26	GT 15212	Front Axle Beam
27	GT 12072	Steering Rod
28	GT 2406	Nut

INDEX PART NO. DESCRIPTION

29	GT 6044	Tie Rod End
30	GT 2090	Nyloc Nut
31	GT 1025	Washer
32	GT 6056	Bush
33	GT 13740	Chain Wheel
34	GT 10024	Sleeve
35	GT 13325	Chain Adjusting Bracket
36	GT 1169	Bolt
37	GT 1012	Washer
38	GT 12388	Spacer
39	GT 2466	Nyloc Nut
40	GT 13585	Steering Shaft
41	GT 12097	Spacer
42	GT 7304	Washer
43	GT 12394	Bush
44	GT 13495	Steering Tube
45	GT 7009	Collar
46	GT 13515	Clamp - Steering Tube
47	GT 1635	Tyre 10.5HP Model
47	GT 455	Tyre 13HP Models
48	GT 1454	Tube 10.5HP Model
48	GT 456	Tube 13HP Models
49	GT 7093	Front Wheel Hub 10.5HP Model
49	GT 7007	Front wheel Hub 13HP Models
50	GT 2202	Bearing - Front Wheel 10.5HP Model
50	GT 396	Bearing - Front Wheel 13HP Models
51	GT 1785	Steering Wheel Complete (Models 10.5-30 & 13-32)
52	GT 2212	Steering Wheel Complete (Deluxe 13-32)
53	GT 12043	Roller Chain
54	GT 504	Connecting Link

PARTS AND SPECIFICATIONS SUBJECT TO CHANGE WITHOUT NOTICE.

STANDARD HARDWARE ITEMS ARE NOT SHOWN.

# Cutter Deck

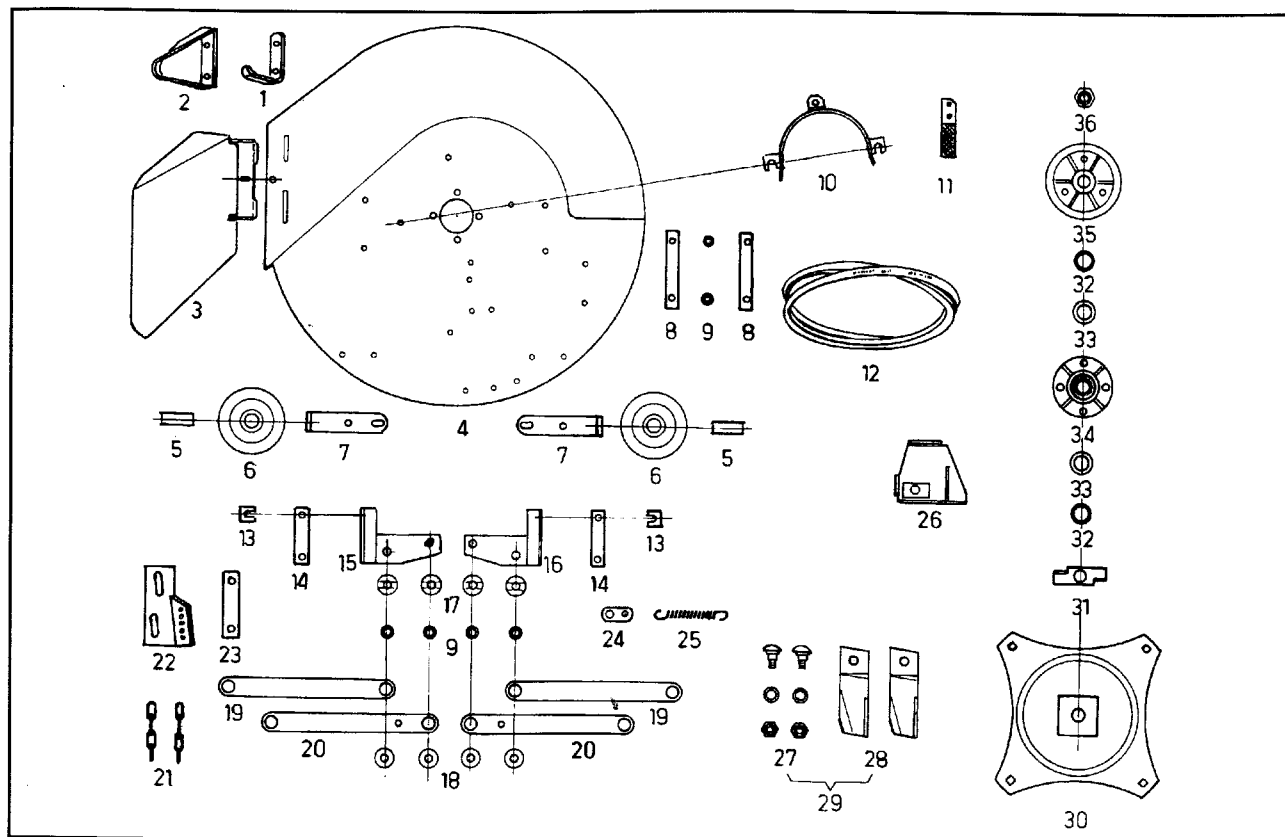

INDEX	PART NO.	DESCRIPTION	INDEX	PART NO.	DESCRIPTION
1	GT 12363	Deck Skid 30" Model	19	GT 12396	Bottom Link Model 10.5 HP
2	GT 6631	Deck Skid 32" Model	19	GT 7406	Bottom Link Models 13 HP
3	GT 15135	Stone Guard	20	GT 13530	Top Link
4	GT 12384	Cutter Deck 30" Model	21	GT 12346	Lifting Chain
4	GT 12383	Cutter Deck 32" Model	22	GT 13270	Fixed Bracket
5	GT 8501	Bush	23	GT 13280	Bolt Retainer - Fixed Bracket
6	GT 12010	Jockey Wheel	24	GT 12323	Spring Anchor
7	GT 12362	Bracket	25	GT 9090	Spring - Tension
8	GT 14318	Bar	26	GT 12990	Latch - Cutter Clutch
9	GT 730	Bush	27	GT 2110	Blade Bolt Set
10	GT 13210	Belt Guide	28	GT 2138	Blade Set
11	GT 13801	Cutter Brake	29	GT 2139	Blade and Bolt Set
12	GT 376	V Belt Cutters	30	GT 13180	Disc and Spindle 30" Model
13	GT 10463	Shim	30	GT 13010	Disc and Spindle 32" Model
14	GT 13285	Bolt Retainer - Side Plate	31	GT 8205	Bearing Wiper
15	GT 13340	L.H. Side Plate 30" Model	32	GT 635	Spacer
15	GT 13345	L.H. Side Plate 32" Model	33	GT 589	Shield
16	GT 12970	R.H. Side Plate 30" Model	34	GT 13815	Spindle Housing Unit complete
16	GT 12975	R.H. Side Plate 32" Model	35	GT 12014	Pulley
17	GT 579	Wave Washer	36	GT 2003	Nut
18	GT 1012	Washer			

PARTS AND SPECIFICATIONS SUBJECT TO CHANGE WITHOUT NOTICE.

STANDARD HARDWARE ITEMS ARE NOT SHOWN

## Body Work & Seat

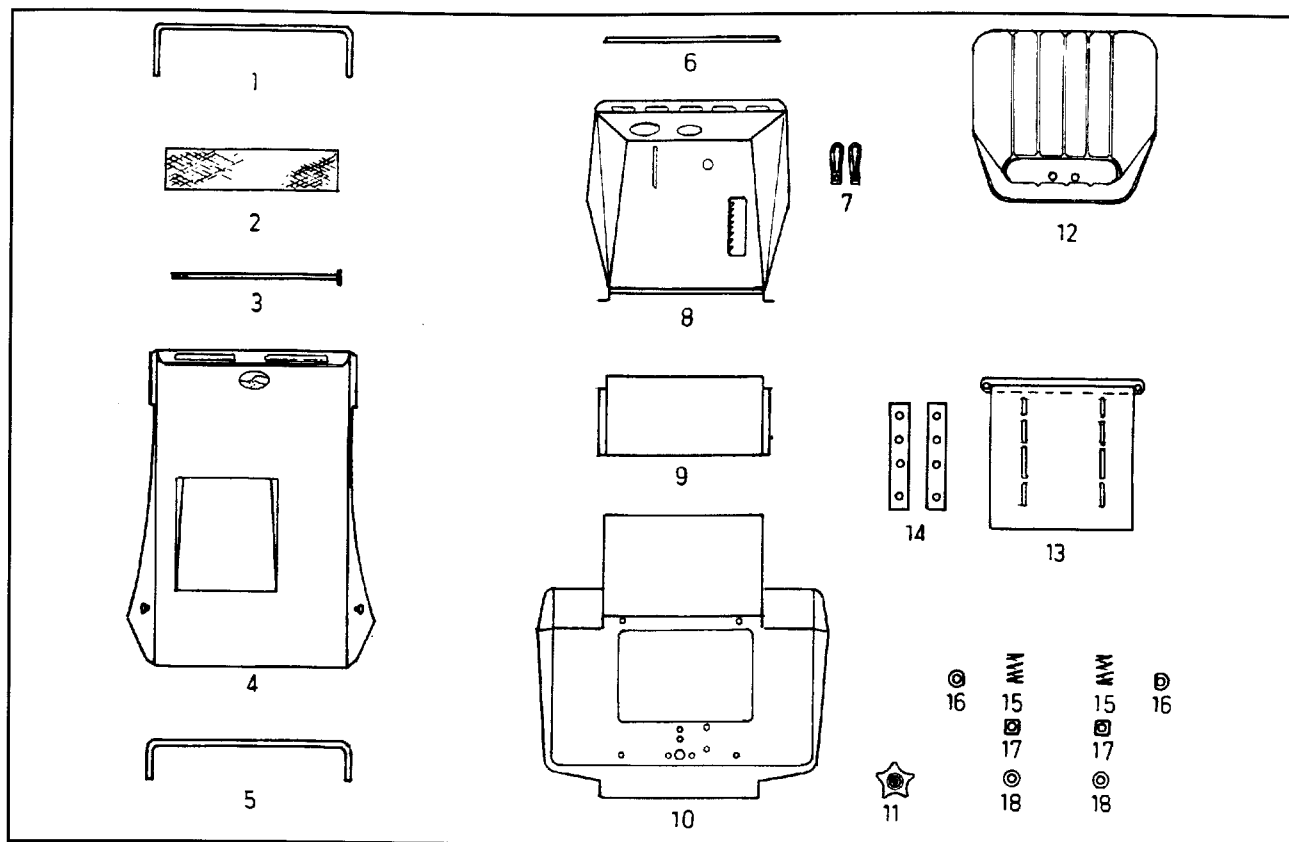

INDEX	PART NO.	DESCRIPTION	INDEX	PART NO.	DESCRIPTION
1	GT 12354	Pinch weld Front	12	GT 8063	Seat Model 13-32
2	GT 12379	Grille	12	GT 8064	Seat Model 13-32 Deluxe
3	GT 8470	Pivot Shaft 13HP Model only	13	GT 13480	Hinged Seat Base 10.5-30 & 13-32 Delux
4	GT 12910	Bonnet Model 10.5-30	13	GT 13690	Hinged Seat Base Model 13-32
4	GT 13205	Bonnet Model 13-32	14	GT 10508	Packing Strip
5	GT 12355	Pinch weld Rear	15	GT 10005	Spring
6	GT 14347	PVC Strip	16	GT 10452	Clamp
7	GT 7015	Strap - Bonnet hold down	17	GT 10451	Locating Block
8	GT 13505	Steering Cowl	18	GT 1660	Washer
9	GT 13580	Step Through Cover			
10	GT 14860	Rear Cover		GT 12096	Decal Sheet Model 10.5-30 Not Depict
11	GT 13807	Knob - Rear Cover		GT 12095	Decal Sheet Model 13-32
12	GT 8060	Seat Model 10.5-30		GT 2225	Bonnet Emblem Model 13-32

**NOTE** BODY PANELS ARE BARE ITEMS PAINTED WITH DECALS.

PARTS AND SPECIFICATIONS SUBJECT TO CHANGE WITHOUT NOTICE.

STANDARD HARDWARE ITEMS ARE NOT SHOWN.

## Guarantee

Greenfield Products Pty Ltd the manufacturer guarantee their product free of faulty workmanship and material for a period of 12 months for domestic use, 3 months for commercial use. Engines and batteries used on Greenfield mowers carry the respective manufacturers warranty.

For details of the Greenfield 3 year extended warranty plan ask your Greenfield dealer.

This Guarantee will not apply to:

- Fair wear and tear, V Belts, Tyres, Tubes, Blades and Blade bolts, Blade holder, and damage caused by misuse, neglect and accidents.
- Repairs rendered necessary or arising from use of other than genuine Greenfield parts, or the relevant genuine engine manufacturers parts.
- Any work performed by other than an authorised Greenfield dealer, or damage arising therefrom.

Products or parts considered faulty should be returned to the authorised Greenfield dealer, or direct to Greenfield with all necessary information, freight paid for inspection. In all warranty claims the manufacturer's decision is final and binding.

The benefits conferred by the above guarantee are in addition to all other rights and remedies in respect of the product which the consumer has under existing laws in Australia and New Zealand.

Greenfield Products Pty Ltd. the manufacturer reserves the right to change parts and specifications without notice.

### Guarantee Registration Details

Owner \_\_\_\_\_

Address \_\_\_\_\_

\_\_\_\_\_  
Postcode \_\_\_\_\_

Purchase Date \_\_\_\_\_ Model \_\_\_\_\_

Chassis No. \_\_\_\_\_ Engine No. \_\_\_\_\_

Dealer Name \_\_\_\_\_

Dealer Signature \_\_\_\_\_

Please complete this record which should be held by the purchaser and presented should service under guarantee be required. To register your guarantee please complete the enclosed guarantee card and return to Greenfield Products.

**Greenfield** Products Pty Ltd

172 Ingram Road, Acacia Ridge Qld 4110.

P.O. Box 155 Archerfield Qld 4108 Australia.

Fax: (07) 344 1161. Tel: (07) 345 6100